

Please make sure to read the enclosed Ninja® Owner's Guide prior to using your unit.

NINJA®

DualBrew

GROUND & PODS

**HOT & ICED COFFEE MAKER
with Rapid Cold Brew**

QUICK START GUIDE

BEFORE YOUR FIRST BREW

IMPORTANT: Ensure you prime your coffee maker before your first brew.

TO PRIME YOUR COFFEE MAKER:

- 1 Plug it into an outlet and turn it on.
- 2 Fill the water reservoir to the **FULL** line with fresh water and place it on the base.
- 3 Place the empty carafe under the brew basket and run a water-only Full Carafe, Classic brew.
- 4 Once the brew is complete, discard the water; coffee maker is now primed for use.

NOTE: If using the brewer in a high-altitude area, running a calibration brew is required. Not running a high-altitude calibration brew in a high-altitude area will result in excessive steaming during brewing. Refer to page 4 of the Owner's Guide for instructions on running a high-altitude calibration brew.

WHAT'S IN THE BOX

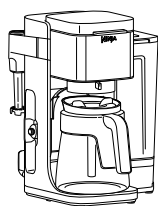

**NINJA DUALBREW
HOT & ICED COFFEE
MAKER**



**14-CUP
GLASS CARAFE**

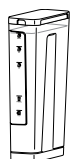

**70 OZ. REMOVABLE
WATER RESERVOIR**



BREW BASKET
Comes fully installed in the brewer.
It must always be inserted when
brewing pods or grounds.

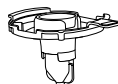

NINJA POD ADAPTER
Used only for brewing pods.
Always insert it over the brew
basket when brewing pods.

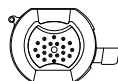

NINJA GROUNDS ADAPTER
Comes fully installed in the brewer.
Used only for brewing ground
coffee. Always insert it over the
brew basket when brewing grounds.



FROTHER WHISK
Included in the box. Must be
assembled on the brewer.



ADAPTER STORAGE
Can be installed on the back of
the unit to store either the Ninja
Pod or Grounds Adapters.



NINJA SMART SCOOP™
Use this to measure coffee grounds.



DE-CLOG TOOL

ADAPTER STORAGE

The Adapter Storage can be installed at the back of the unit to store either the Ninja Pod or Grounds Adapter.

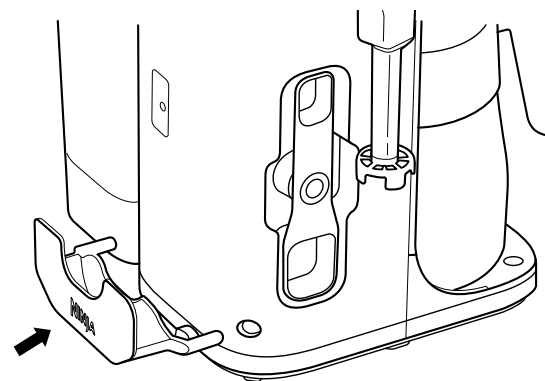

USING THE NINJA POD AND GROUNDS ADAPTER

The Ninja Single-Serve Grounds & Pods Coffee Maker comes with a unique Ninja Grounds Adapter already installed and an additional Ninja Pod Adapter for pods. When brewing grounds, ensure a #4 paper cone filter or the permanent filter (sold separately) is always installed in brew basket before putting the Ninja Grounds Adapter over the brew basket.



INSTALLING THE NINJA POD ADAPTER

Place the Ninja Pod Adapter in the brew basket, ensure the handle is aligned with the brew basket handle, and press down on the Ninja Pod Adapter firmly.

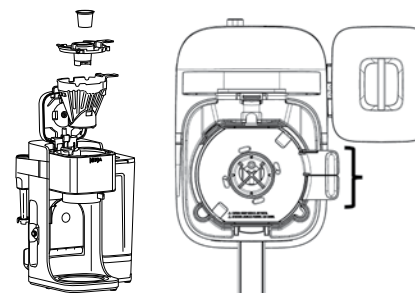

INSTALLING THE NINJA GROUNDS ADAPTER

Place the #4 paper cone filter or the permanent filter (sold separately) in the brew basket, then place the Ninja Grounds Adapter over the brew basket and filter and ensure the handle is aligned with the brew basket handle.

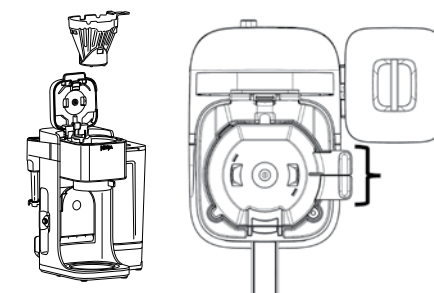

NINJA SMART SCOOP™

The **Ninja Smart Scoop** is used for accurately measuring coffee grounds. The numbers beside the icons show the number of level scoops recommended for each brew size.

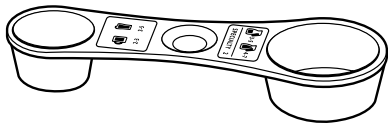

IMPORTANT: Always measure with level scoops of a medium grind size. Use fewer scoops when brewing decaf coffee. **DO NOT** use a paper filter in conjunction with the permanent filter (sold separately).

SERVING SIZE	NINJA SMART SCOOP
GROUND COFFEE	
	2-3 small scoops
	3-5 small scoops
	3-5 big scoops
	4-7 big scoops
Specialty 4 oz.	2 big scoops

1

CHOOSE A METHOD



GROUND S

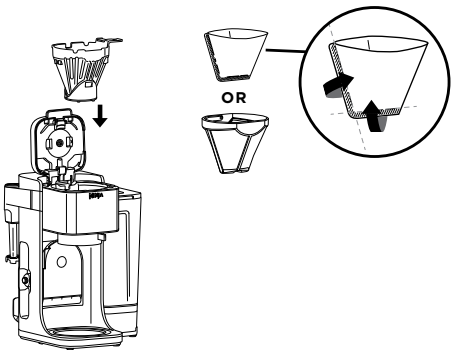

Ensure the brew basket is installed and the Ninja Pod Adapter is removed. Fold the #4 paper cone filter along the seams, open the top fully, and insert it into the brew basket; the permanent (sold separately) filter may be used instead.

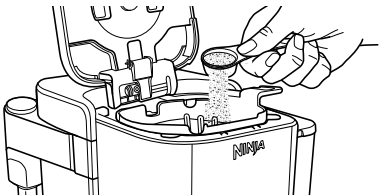

Use the Ninja Smart Scoop™ to add your desired amount of coffee grounds (refer to the Smart Scoop section on page 4). Then place the Ninja Grounds Adapter over the brew basket and close the coffee maker lid.

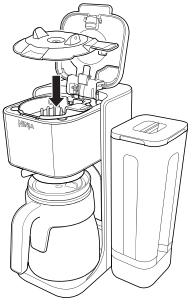

OR



PODS

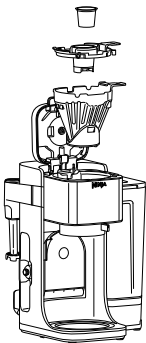

Ensure the brew basket and Ninja Pod Adapter are installed in the coffee maker.



Place a pod in the Ninja Pod Adapter.

IMPORTANT: Ensure the pod is not damaged, torn, or expired. **DO NOT** remove the top of the K-Cup Pod.

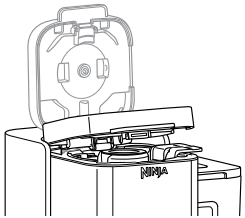

Press the coffee maker lid down firmly to pierce the pod and ensure that the lid is completely closed. There will be an audible click and some resistance when closing the handle as the needle punctures the pod.

CHOOSE A SIZE

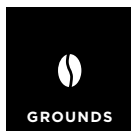

*Approximate brew volumes based on Classic brew. Rich brew will produce slightly less output. Refer to the Approximate Brew Volumes chart in the Owner's Guide for more information.

	6 oz.
	8 oz.
	10 oz.
	12 oz.
	14 oz.
	18 oz.
	28 oz.
	40 oz.
	52 oz.
	65 oz.

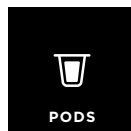

Pods cannot brew in carafe sizes.

*Approximate brew volumes based on Classic brew. Rich brew will produce slightly less output. Refer to the Approximate Brew Volumes chart in the Owner's Guide for more information.

	6 oz.
	8 oz.
	10 oz.
	12 oz.

NOTE: Make sure to use a vessel that is big enough for the brew size you select.

SELECT A BREW

Press either the CLASSIC, RICH, OVER ICE, or COLD BREW brew style to start your brew. There will be an illuminating progress bar on the display to track the status of your brew.

THE BREW MAY PAUSE ONCE OR MULTIPLE TIMES DURING THE BREW CYCLE. THIS IS NORMAL. Pausing allows the coffee grounds to fully extract and unlock the full flavor of the brew style.



CLASSIC

Smooth, well-balanced flavor.



OVER ICE

Specially designed to brew hot over ice for freshly brewed iced coffee that is not watered down.
Always fill your vessel to the top with ice cubes before brewing Over Ice.



SPECIALTY

A super-rich concentrate that allows you to make coffee-based drinks like cappuccinos and lattes.
Will only brew 4 oz.



RICH

More intense flavor that stands up to milk, cream, or flavoring.



COLD BREW

Brewed at a lower temperature over ice for an ultra-smooth, deep, and sweet flavor.
Always fill your vessel to the top with ice cubes before brewing Cold Brew.

NOTE: DO NOT use any glassware except the provided Ninja carafe, which is made of specialized glass that is safe to use.

DRIP STOP

The drip stop is used to close off the brew basket to prevent any coffee from dispensing. You will need to manually open and close the drip stop by moving the handle to your desired position. The drip stop can be closed and reopened at any point before, during, or after a brew.

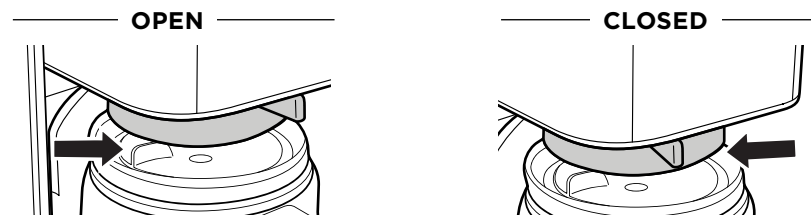

CAN'T WAIT FOR THAT FIRST CUP?

Close the drip stop to pause the brew cycle, and pour yourself a cup. Then, reopen the drip stop to continue the brew.

STOP THE DRIPS AFTER A BREW

At the end of a brew, close the drip stop to prevent coffee dripping from the brew basket and Ninja® Pod Adapter.

CHEC POD

During a pod brew, the machine may stop and flash this message. This means that your machine may have loose grounds in it.

CHEC

POD

- 1 To resolve this, remove the pod and take the Ninja Pod Adapter out.
- 2 Wash Ninja Pod Adapter thoroughly with water to remove any leftover grounds.
- 3 Remove brew basket. Be sure to clean out any grounds from brew basket, then insert back into machine.
- 4 Place Ninja Pod Adapter back in brew basket. Run a water-only brew by brewing a 12 oz. Classic drink. Once the brew is complete, you are now ready to brew another drink.

For best results, use bottled water and first-party pods.

DE-CLOGGING INSTRUCTIONS

Check the top and bottom needles regularly for coffee ground buildup. If "CLOG" is displayed or you are experiencing inconsistent brews, there may be a clog in the needles.

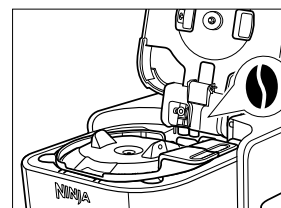

1. Power off the coffee maker. Open the lid of the coffee maker and remove the Ninja Pod Adapter. Place the Ninja Grounds Adapter in the machine. Ensure the Ninja Grounds Adapter is clean and lid is closed.

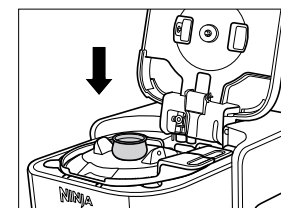

2. Place the De-Clog Tool into the Ninja Grounds Adapter with the open side of the De-Clog Tool facing up. Push the De-Clog Tool down until it snaps into place. Carefully fill De-Clog Tool with water.

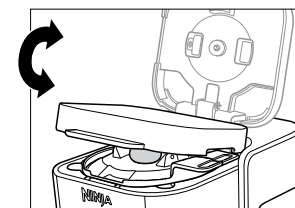

3. Gently close the lid until it makes contact with the De-Clog Tool, then pump down 10 times. (**Do not close the lid all the way.**)
4. Open the lid and remove the De-Clog Tool; discard any water. Be sure to clean any grounds from your Ninja Grounds Adapter and brew basket.
5. With the Ninja Grounds Adapter and brew basket installed, fill the water reservoir up to at least the Travel line with fresh water. Do not add coffee to brew basket; close the lid.
6. Power on the coffee maker. Place a large cup under the nozzle and run a water-only 12 oz. brew to clear the system.
7. Once the brew is complete, discard any water. If the brew is not successful, power off the coffee maker and repeat these steps. If the problem persists, please contact Customer Service for assistance.

NINJA®

DualBrew

GROUND & PODS

**HOT & ICED COFFEE MAKER
with Rapid Cold Brew**

**For questions or to register your product, contact us at
1-877-646-5288 or visit us online at ninjakitchen.com**



@ninjakitchen

CFP150CO_QSG_MP_MV8_250314
© 2025 SharkNinja Operating LLC

NINJA is a registered trademark of SharkNinja Operating LLC.

NINJA SMART SCOOP is a trademark of SharkNinja Operating LLC.

All other marks, including KEURIG and K-CUP, are trademarks of their respective owners.