

Please make sure to read the enclosed Ninja® Owner's Guide prior to using your unit.

NINJA®

HOT & ICED

**XL COFFEE MAKER
WITH RAPID COLD BREW**

QUICK START GUIDE

+ 4 IRRESISTIBLE RECIPES

BEFORE YOUR FIRST BREW

To prime your brewer:

1. Plug it into an outlet and turn it on.
2. Fill the water reservoir to the Full line with fresh water and place it on the base.
3. Place the empty carafe under the brew basket and run a Full Carafe, Classic brew.

Once the brew is complete, discard the water and you're ready to go.

If you live in a high-altitude area, running a calibration brew is required to prevent excessive steaming during brewing. See page 4 of the Owner's Guide for instructions on how to run a high-altitude calibration brew.

1 FILLING THE WATER RESERVOIR

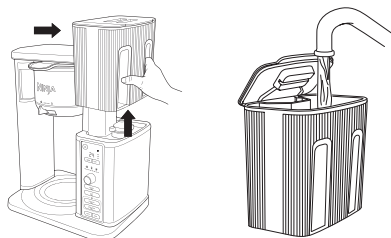

FILL TO THE FULL LINE
Fill up to, but do not exceed, the Full line.

2 CUP, MUG, OR CARAFE

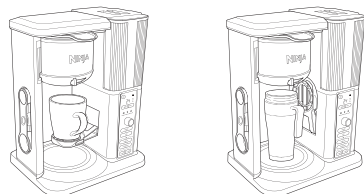

CUP
Pull down the cup platform to set your mug on it.

TRAVEL MUG & XL SIZES
Place your XL cup, travel mug, or XL tumbler on the base of the brewer.



CARAFE
Place your carafe on the Intelligent Warming Plate. The Intelligent Warming Plate will turn on only if brewing a carafe size on Classic or Rich brew.

WANT YOUR COFFEE TO STAY HOT LONGER?

The Intelligent Warming Plate will automatically turn on while brewing a Classic or Rich brew on any Carafe size and remain on for 2 hours. To adjust how long the Intelligent Warming Plate remains on (up to 4 hours), refer to the Owner's Guide.

WHEN THE INTELLIGENT WARMING PLATE IS ON, IT CAN BE TURNED OFF MANUALLY BY PRESSING THE STAY WARM BUTTON. IT CAN BE TURNED ON MANUALLY BY PRESSING STAY WARM WHILE ANY CARAFE SIZE IS SELECTED.

IMPORTANT: The  light on the base of the brewer will illuminate only when the warming plate is hot and will remain illuminated until the warming plate has returned to a safe temperature.

3 REMOVABLE FILTER HOLDER & FILTER OPTIONS

The filter holder removes for easy filling and quick cleanup. Place either a paper filter or permanent filter into the filter holder. To avoid spills and drips after a brew, keep the paper or permanent filter inside the filter holder as you carry it to the trash.

IF USING PAPER FILTER

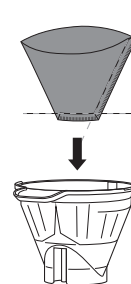

Fold a #4 paper cone filter along the seams, open it fully, then insert filter firmly into the filter holder.

IF USING PERMANENT FILTER

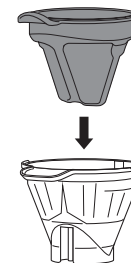

Place your permanent mesh filter into the filter holder, then add your coffee directly into it.

4 DRIP STOP

The drip stop is used to close off the brew basket to prevent any coffee from dispensing. You will need to manually open and close the drip stop by moving the handle to your desired position. The drip stop can be closed and reopened at any point before, during, or after a brew.

CAN'T WAIT FOR THAT FIRST CUP?

Close the drip stop to pause the brew cycle and pour yourself a cup. Then, reopen the drip stop to continue the brew.

STOP THE DRIPS AFTER A BREW

At the end of a brew, close the drip stop to prevent coffee dripping from the brew basket.

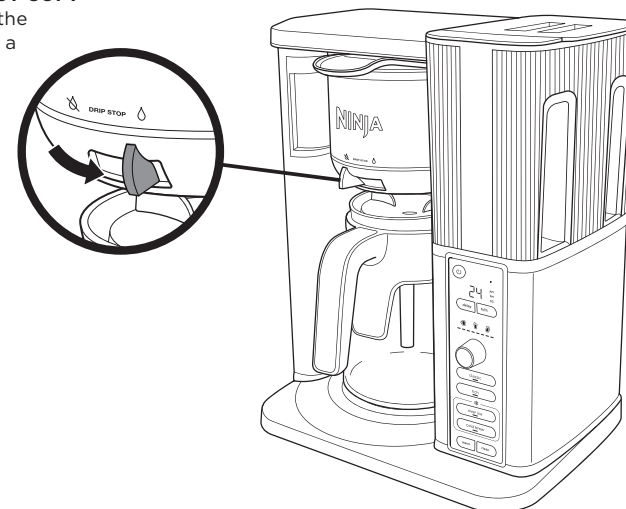



Smooth, well-balanced flavor.



More intense flavor that stands up to milk, cream, or flavoring.



Specially designed to brew hot over ice for freshly brewed iced coffee that is not watered down. **Always fill your vessel to the top with ice cubes before brewing Over Ice.**



Brewed at a lower temperature over ice for an ultra-smooth, deep, and sweet flavor. Ready in 10-20 minutes. **Always fill your vessel to the top with ice cubes before brewing Cold Brew.**

NOTE: DO NOT use any glassware except the provided Ninja® carafe, which is made of specialized glass that is safe to use.

1 CHOOSE A SCOOP

The Ninja Smart Scoop™ takes the guesswork out of measuring. The numbers beside the icons show the number of scoops recommended for each brew size.

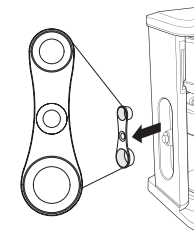

	Serving Size	Ninja Smart Scoop™
	Small Cup	2-3 small scoops
	Cup	
	XL Cup	
	Travel Mug	3-5 small scoops
	XL Travel Mug	
	1/4 Carafe	3-5 big scoops
	1/2 Carafe	
	Full Carafe	4-7 big scoops

2 CHOOSE A SIZE

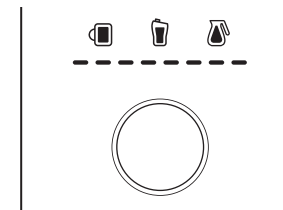

Make sure to use a vessel that is big enough for the brew size you select.

	Small Cup	8 oz.
	Cup	10 oz.
	XL Cup	12 oz.
	Travel Mug	14 oz.
	XL Travel Mug	18 oz.
	1/4 Carafe	28 oz.
	1/2 Carafe	37 oz.
	Full Carafe	55 oz.

*Approximate brew volumes based on Classic brew. Rich brew will produce slightly less output. Refer to the Approximate Brew Volumes chart in the Owner's Guide for more information.

3 CHOOSE A BREW STYLE

Press your desired brew style button once and the brew will begin.







NOTE: If the display reads **STOP**, the brew has been canceled. Press your desired brew style button again to restart the brew.

NOTE: THE BREW MAY PAUSE ONCE OR MULTIPLE TIMES DURING THE BREW CYCLE. THIS IS NORMAL. Pausing allows the coffee grounds to fully extract and unlock the full flavor of the brew style.

GUIDE TO KEEPING COFFEE HOT

The type of cup you brew into can greatly influence the drinking temperature of your coffee.

Cup Temperature	CERAMIC CUP			PAPER CUP
	Room temperature	Pre-warmed with hot water	Pre-warmed in microwave with milk	Room temperature
Drinking Temperature	Hot 	Hotter 	Hotter 	Hottest 
Why is there a difference?	A cold ceramic mug will steal heat from the coffee as it warms itself up.	If the mug is already warm, it will not steal as much heat from the coffee.	Just like your cold mug, cold milk lowers the temperature of your coffee.	Unlike a ceramic mug, a thinner paper cup does not steal substantial heat from the coffee.

NOTE: DO NOT put the carafe in the microwave.

MAPLE PECAN COFFEE



Size: Full Carafe setting **Brew:** Classic **Makes:** 4 (12-ounce) servings

INGREDIENTS

6 Ninja® Big Scoops (12 tablespoons) ground pecan-flavored coffee
 ½ cup heavy cream
 2 tablespoons maple syrup
 ½ teaspoon ground cinnamon, plus more for garnish

DIRECTIONS

- Following the measurement provided, place the ground coffee into the brew basket.
- Set the carafe in place to brew.
- Select the Full Carafe size; press the Classic brew button.
- While coffee is brewing, whip heavy cream with maple syrup and cinnamon until soft peaks form.
- When brew is complete, pour coffee into 4 mugs. Top with whipped cream and cinnamon.

NUTTY MOCHA COLD BREW



Size: XL Travel Mug setting **Brew:** Cold Brew **Makes:** 1 (22-ounce) serving

INGREDIENTS

4 Ninja® Small Scoops (4 tablespoons) ground coffee
 2 tablespoons cocoa powder
 2 cups ice
 2 tablespoons hazelnut syrup
 ½ cup unsweetened almond milk
 2 tablespoons heavy cream

DIRECTIONS

- Following the measurements provided, place the ground coffee and cocoa powder into the brew basket.
- Place the ice, hazelnut syrup, almond milk, and heavy cream in a 22-ounce or larger travel mug; set cup in place to brew.
- Select the 18 oz. XL Travel Mug size; press the Cold Brew button.
- When brew is complete, stir to combine.

TOO GOOD TOFFEE COFFEE



Size: Cup setting **Brew:** Rich **Makes:** 1 (12-ounce) serving

INGREDIENTS

3 Ninja® Small Scoops
(3 tablespoons) ground coffee
1 tablespoon butterscotch
or caramel sauce
1 tablespoon dark brown sugar
¼ teaspoon vanilla extract
⅛ teaspoon salt
¼ cup heavy cream

DIRECTIONS

- 1 Following the measurement provided, place the ground coffee into the brew basket.
- 2 Place butterscotch or caramel sauce, brown sugar, vanilla extract, and salt into a mug; set mug in place to brew.
- 3 Select the 10 oz. Cup size; press the Rich brew button.
- 4 While coffee is brewing, place cream into another mug.
- 5 Microwave cream for 30-45 seconds to gently warm.
- 6 When brew is complete, stir to combine, then pour cream into coffee.

COCONUT CARAMEL ICED COFFEE



Size: XL Travel Mug setting **Brew:** Over Ice **Makes:** 1 (22-ounce) serving

INGREDIENTS

5 Ninja® Small Scoops
(5 tablespoons)
ground coconut coffee
2 cups ice
¼ cup caramel sauce
¼ cup half & half

DIRECTIONS

- 1 Following the measurement provided, place the ground coffee into the brew basket.
- 2 Place the ice, caramel sauce, and half & half into a 22-ounce or larger plastic cup; set cup in place to brew.
- 3 Select the 18 oz. XL Travel Mug size; press the Over Ice brew button.
- 4 When brew is complete, stir to combine.

NINJA®

HOT & ICED

**XL COFFEE MAKER
WITH RAPID COLD BREW**

For questions or to register your product, contact us at
1-877-646-5288 or visit us online at ninjakitchen.com



[@ninjakitchen](https://www.instagram.com/ninjakitchen)

NINJA is a registered trademark of SharkNinja Operating LLC.
NINJA SMART SCOOP is a trademark of SharkNinja Operating LLC.
© 2023 SharkNinja Operating LLC

CM371_QSG_IG_MP_MV12