

NINJA®

Kitchen System Pulse®

BL209

OWNER'S GUIDE



www.ninjakitchen.com

IMPORTANT SAFETY INSTRUCTIONS

For Household Use Only

WHEN USING ELECTRICAL APPLIANCES, BASIC SAFETY PRECAUTIONS SHOULD ALWAYS BE FOLLOWED, INCLUDING THE FOLLOWING:

READ ALL INSTRUCTIONS BEFORE USING YOUR NINJA® Kitchen System Pulse®.

POLARIZED PLUG

WARNING: To reduce the risk of electric shock, this appliance has a polarized plug (one blade is wider than the other). This plug will fit into a polarized outlet only one way. If the plug does not fit fully into the outlet, reverse the plug. If it still does not fit, contact a qualified electrician to install the proper outlet. **DO NOT modify the plug in any way.**

WARNING: TO REDUCE THE RISK OF FIRE, ELECTRIC SHOCK OR INJURY:

1. To protect against electrical shock, do not submerge the appliance or allow the power cord to come into contact with water or any other liquid.
2. **DO NOT** allow young children to operate the appliance or use as a toy. Close supervision is necessary when any appliance is used by or near children.
3. Never leave an appliance unattended when in use.
4. Remove the power cord from the electrical outlet when not in use, before assembling or disassembling parts and before cleaning. To unplug, grasp the plug and pull from the electrical outlet. Never pull from the power cord.
5. **DO NOT** abuse the power cord. Never carry the appliance by the power cord or yank it to disconnect from electrical outlet; instead grasp the plug and pull to disconnect.
6. **DO NOT** operate any appliance with a damaged cord or plug, or after the appliance malfunctions, has been dropped or damaged in any manner. Return the appliance to EURO-PRO Operating LLC for examination, repair or adjustment.
7. **DO NOT** let the power cord hang over the edge of table or counter or touch hot surfaces such as the stove.
8. Always use appliance on a dry, level surface.



9. Keep hands, hair, clothing, as well as utensils out of container while processing to reduce the risk of severe injury to persons or damage to the appliance. A scraper may be used but only when the appliance is not running.
10. **CAUTION:** Blade assembly is sharp, handle with care. When handling the blade assembly, always hold by the shaft or collar.
11. Avoid contact with moving parts.
12. **DO NOT** attempt to sharpen blades.
13. **DO NOT** use the appliance if blade assembly is bent or damaged.
14. To reduce risk of injury, never place the blade assembly on the base without the pitcher or bowl properly attached.
15. **DO NOT** operate this appliance on or near any hot surfaces (such as gas or electric burner or in a heated oven).
16. The use of attachments or accessories including canning jars, not recommended by the manufacturer may result in fire, electric shock or personal injury.
17. **DO NOT** remove the container from the motor base while the appliance is in operation.
18. To reduce the risk of injury, **NEVER** operate the appliance without the lid in place; **DO NOT** try to defeat the interlock mechanism; make sure that the attachment is properly installed before operating the appliance.
19. **DO NOT** expose containers to extreme temperature changes.
20. **DO NOT** blend hot liquids.
21. **DO NOT** overfill.
22. **DO NOT** operate the appliance empty.
23. **CAUTION:** When mixing pizza dough or any heavy mix such as bread dough or pastry dough, mix for up to 1 minute, then let the appliance rest for approximately 1 minute before mixing again to prevent overheating of the appliance.
24. If the appliance overheats, a thermal switch will become activated and shut off the motor. To reset, unplug the appliance and let it cool down for approximately 30 minutes before using again.
25. **THIS PRODUCT IS INTENDED FOR HOUSEHOLD USE ONLY.** Do not use this appliance for anything other than its intended use. Do not use outdoors.
26. The maximum rating is based on the Cookie Paddle (40 oz. bowl) that drives the greatest power and other recommended attachments may draw less power or current.
27. Keep the pour spout closed when blending to prevent splashing.

WARNING: Extension cords are not recommended for use with this product.

SAVE THESE INSTRUCTIONS

THIS BOOK COVERS MODEL NUMBER:

BL209 30

TECHNICAL SPECIFICATIONS

Voltage: 120V., 60Hz.

Power: 550 Watts

Bowl Capacity: 40 ounces (5 cups)

Nutri Ninja® Cup: 16 ounces (2 cups)

Euro-Pro, Kitchen System Pulse, Ninja and Nutri Ninja are trademarks of Euro-Pro Operating LLC.



Contents

**Thank you for
purchasing the
Ninja® Kitchen
System Pulse®.**

Getting to Know Your Ninja® Kitchen System Pulse®	6
Assembling the Ninja® Kitchen System Pulse®	8
Assembly and Use for the Nutri Ninja® Cup.....	9
Assembly and Use for the 40-oz Bowl	10
Suggested Uses.....	11
Care & Maintenance	12
Troubleshooting Guide.....	13
Replacement Parts.....	13
Recipes.....	14
Warranty & Registration.....	19



Getting To Know Your Ninja® Kitchen System Pulse®

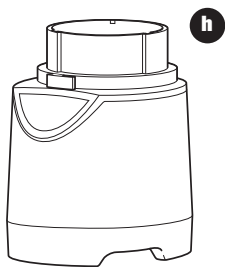
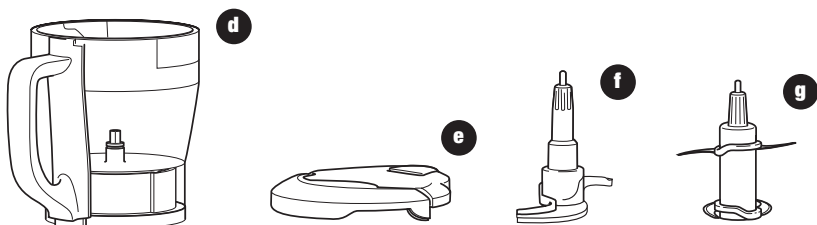
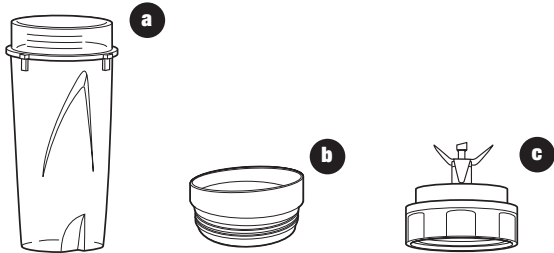

- a** Nutri Ninja® Cup
- b** Nutri Ninja® To-Go Lid
- c** Nutri Ninja® Blade
- d** 40-oz. Bowl
- e** 40-oz. Bowl Lid with Pulse Handle

- f** Dough Hook (40-oz. bowl)
- g** 4-Blade Assembly (40-oz. bowl)
- h** Motor Base
- i** Power Cord (not shown)

NOTE: Attachments are not interchangeable.

The Ninja® Kitchen System Pulse® is a high powered innovative tool with a compact design and outstanding performance. It is perfect for ice crushing, chopping, blending, kneading and nutrient & vitamin extraction. Blend and go with the convenient Nutri Ninja® cup, create delicious drinks to get you out the door! Best results are achieved when you Pulse.



FEATURES:

- Ninja® Blade Technology
- 40 oz. Bowl and Nutri Ninja® Drink Cup - BPA Free
- Cord storage
- Pulse Power: Controlled blending, processing, juicing, and kneading by using short pulses. In short intervals, press down on the top of the Nutri Ninja® cup or the handle of the 40-oz. bowl lid and pulse to the perfect consistency.
- Nutri Ninja® Blending: Fill, blend, and go! Blend right in the Nutri Ninja® cup and twist on the to-go lid for delicious, nutrient-rich juices on-the-go.
- Dough Mixing: Mix and knead pizza dough, cookie dough, bread dough and more!

For best results, be sure to carefully read all the instructions contained in the manual before using this appliance.

Assembling the Ninja® Kitchen System Pulse®

PLEASE KEEP THESE IMPORTANT SAFEGUARDS IN MIND WHEN USING THE APPLIANCE:

- ⚠ **IMPORTANT:** Always place the attachment in the 40-oz. bowl before adding any ingredients.
- ⚠ **IMPORTANT:** Attachments are not interchangeable.
- ⚠ **CAUTION:** Blades are sharp! Use extreme caution when handling the blade assemblies. Always hold them by the shaft.
- ⚠ **IMPORTANT:** When mixing dough. Mix dough for up to 1 minute, then let appliance rest for 1 minute before mixing again.
- ⚠ **IMPORTANT:** Never run the appliance empty.
- ⚠ **CAUTION:** Never attempt to remove the container while the appliance is still running.
- ⚠ **WARNING:** Never leave the appliance unattended while in use.

- ⚠ **CAUTION:** If using the pour spout, ensure the lid is fully locked onto the blender pitcher.

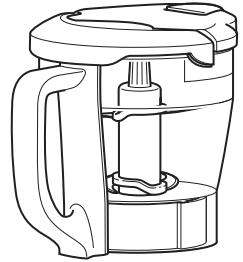

- ⚠ **CAUTION:** If pouring with the lid removed, ALWAYS remove the blade assembly first.

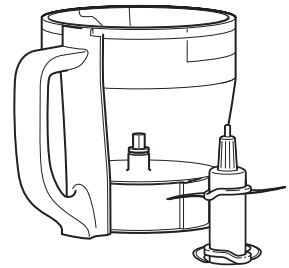

BEFORE FIRST USE

- 1 Remove all packaging material and labels from the appliance.
- 2 Wash the lids, bowl, Nutri Ninja® cup and attachments in warm, soapy water with a soft cloth. Use caution when washing the blade assemblies as the blades are very sharp.
- 3 Rinse and dry thoroughly.
- 4 The bowl, Nutri Ninja® cup, lids and attachments are all dishwasher safe. It is recommended that the lids and attachments be placed on the top rack. Ensure that the attachments are removed from the containers before placing in the dishwasher.
- 5 Wipe the motor base clean with a damp cloth.

Assembly and Use for the Nutri Ninja® Cup

ASSEMBLY



Fig. 1

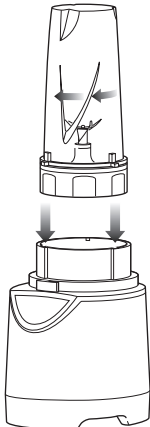

Fig. 2

PULSE

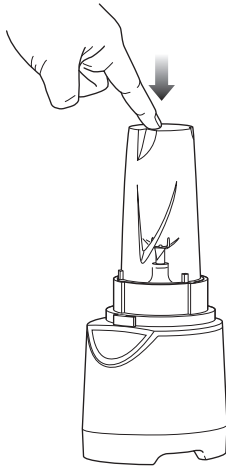

Fig. 3

REMOVAL

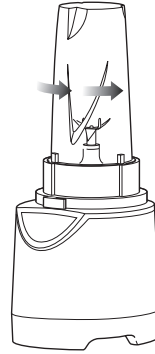

Fig. 4

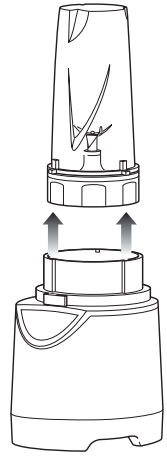

Fig. 5

 For best results, use short **"PULSES"**... Practice makes perfect!!

▲ IMPORTANT: Make sure that the motor base is plugged in for use.

- 1 Place the motor base on a clean, dry, level surface such as a counter or table top.
- 2 Add ingredients to the Nutri Ninja® cup.
- 3 Place the Nutri Ninja® blade onto the cup and screw it tightly until you have a good seal. **(Fig. 1)**
- 4 Turn the Nutri Ninja® cup upside down and place it onto the motor base, aligning the tabs on the cup with the motor base. Turn clockwise and the unit is ready for use. **(Fig. 2)**
- 5 Press down on the top of the cup in short intervals to activate. **(Fig. 3)**

- 6 When you have reached your desired consistency, stop the appliance by removing your hand from the Nutri Ninja® cup. Then turn the Nutri Ninja® cup counterclockwise **(Fig. 4)** and pull straight up to remove. **(Fig. 5)**

NOTE: Do not overfill! To avoid spilling, do not add ingredients past the "Max" fill line.

- 7 Turn the cup upright and remove the Nutri Ninja® blade by twisting the blade assembly to the left.
- 8 Place the To-Go drinking lid onto the Nutri Ninja® cup, twist to seal and enjoy!
- 9 Make sure that the motor base is unplugged when not in use.

Assembly and Use for the 40-oz. Bowl

ASSEMBLY

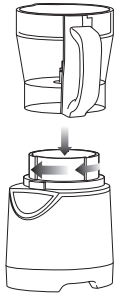

Fig. 1



Fig. 2



Fig. 3

PULSE



Fig. 4

REMOVAL

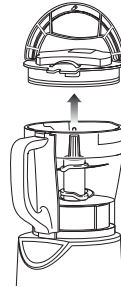

Fig. 5

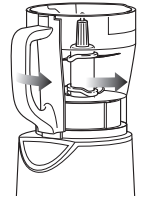

Fig. 6

▲ IMPORTANT: Make sure that the motor base is plugged in for use.

- 1 Place the motor base on a clean, dry, level surface such as a counter or table top.
- 2 Align and lower the bowl onto the motor base. (Fig. 1) Handle should be aligned slightly to the left of the "LOCK" symbol on the motor base.
- 3 Rotate the container to the left as far as it will go to lock in place. (Fig. 1)
- 4 Holding the desired attachment by the shaft, place it onto the drive gear inside the container. Ensure that the attachment is seated properly and is standing upright. (Fig. 2)

NOTE: The blade will fit loosely on the drive gear.

- 5 Add the ingredients to the bowl, making sure that they do not exceed the highest measured marking line on the side of the bowl.
- 6 Holding the lid by the handle in the upright position, place it on top of the bowl aligning the arrow (▼) located on the lid with the arrow (▲) located on the bowl's handle. (Fig. 3)

- 7 Push down on the "PULSE" on the handle to start the appliance. (Fig. 4)

NOTE: Pulse ingredients for even chopping by pressing down in short intervals.

- ▲ **IMPORTANT:** When using the dough blade hold the appliance to secure the appliance to the counter or table top.
- 8 When you have reached your desired consistency, stop pressing the lid handle and wait for the attachment to stop turning.
- 9 To remove the lid, pull the lid handle up to a 90° angle. Turn the bowl counter-clockwise to lift off the base. (Fig. 5, Fig. 6)
- ▲ **CAUTION:** Never insert your hands in the pitcher as the blades are sharp. Always use a spatula to dislodge food that has stuck to the sides of the pitcher.
- 10 Make sure that the unit is unplugged when not in use.

Suggested Uses

FUNCTION	CONTAINER	ATTACHMENT	TYPE OF FOOD
Mincing	Nutri Ninja® Cup 40-oz. Bowl	Blade Assembly	Onion Garlic Herbs
Kneading*	40-oz. Bowl	Dough Blade	Bread Dough Pizza Dough
Blending	Nutri Ninja® Cup 40-oz. Bowl	Blade Assembly	Smoothies Milkshakes Frozen Drinks Dips Spreads
Grating	Nutri Ninja® Cup 40-oz. Bowl	Blade Assembly	Cheese Bread Crumbs
Chopping	40-oz. Bowl	Blade Assembly	Salsa Vegetables Egg Salad
Ice Crushing	Nutri Ninja® Cup 40-oz. Bowl	Blade Assembly	Ice Slushies Snow Cones
Nutrient & Vitamin Extraction	Nutri Ninja® Cup	Blade Assembly	Fruit & Vegetable Drinks

⚠️ *IMPORTANT: When mixing pizza dough or any heavy mix such as bread dough or pastry dough, mix for up to 1 minute, then let the appliance rest for approximately 1 minute before mixing again to prevent overheating of the appliance.

Care & Maintenance

HOW TO CLEAN

- ⚠ CAUTION:** Make sure that the motor base is unplugged from the power source before inserting or removing any attachment and before cleaning.
- ⚠ CAUTION: DO NOT** immerse the motor base into water or any other liquid.

- 1 Separate/remove all parts from each other.
- 2 Clean the motor base and gear shaft with a damp cloth and wipe dry.
- 3 Place the bowl and Nutri Ninja® cup in the dishwasher. Place the lids and attachments on the top rack. **Use caution when handling the blade assemblies as the blades are very sharp.**

NOTE: You may also wash the containers by filling the container with no more than 24-oz. of warm water and a drop of dish washing detergent, placing the corresponding lid on the container and pulsing a few times. Do not fill the container with more than 24-oz. of water because it will overflow. Once clean, remove the container from the motor base. Rinse the container, attachment and lid under running water. Allow all the parts to dry before storing.

Please call customer service if any servicing needs to be performed on the appliance at 1-877-646-5288.

HOW TO STORE

- 1 Store the Ninja® Kitchen System Pulse® upright with the 40-oz bowl on the motor base, 4-Blade assembly inside and lid on the bowl. Secure the power cord underneath the base by wrapping the cord around the cord wrap. Do not place anything on top. Store the Nutri Ninja® cup and the rest of the attachments along side the appliance where they will not be damaged and won't cause a hazard.

RESETTING THE MOTOR THERMOSTAT

The Ninja® Kitchen System Pulse® features a unique safety system which prevents damage to the unit's motor and drive system should you inadvertently overload your appliance. If the appliance is being overloaded, the motor will stop. To reset the appliance, follow the resetting procedure below:

- 1 Unplug the appliance from the electrical outlet.
- 2 Remove and empty the container and ensure that no food is jamming the cutting blades or attachments.
- 3 Allow the appliance to cool for approximately 30 minutes.
- 4 Re-install the container onto the base and re-plug the appliance into the electrical outlet.
- 5 Proceed to use the appliance as before making sure not to exceed the recommended maximum capacities.

Troubleshooting Guide

PROBLEMS	POSSIBLE REASONS & SOLUTIONS
Motor Doesn't Start or Attachment Doesn't Rotate.	<ul style="list-style-type: none">• Make sure the container is securely aligned and locked, (40-oz bowl) on the motor base.• For the Nutri Ninja® cup, make sure that the tabs are seated in the slots and turned to the left.• Make sure the lid is securely on the container (40-oz bowl) in the correct position with the arrows aligned.• Check that the plug is securely inserted into the electrical outlet.• Check the fuse or circuit breaker in your electrical box.• The unit could be overloaded. Unplug and wait approximately 30 minutes before using again.• The unit could be overheated. Unplug the unit and wait 30 minutes to reset.
Food is Unevenly Chopped.	<ul style="list-style-type: none">• Either you are chopping too much food at once, or you are not pulsing properly. Remove some of the food items.
Food is Too Finely Chopped or Too Watery.	<ul style="list-style-type: none">• The food has been over processed. Pulse ingredients for best results. Press down on the Nutri Ninja® cup or 40-oz. lid handle in short intervals.
You Cannot Achieve Snow From Ice Cubes.	<ul style="list-style-type: none">• For best results use ice straight from the freezer. Try using short pulses instead of one long one.
Nutri Ninja® cup is leaking.	<ul style="list-style-type: none">• Make sure that the Nutri Ninja® blade set is tightly screwed on to the cup before blending. Turn the lid tightly clockwise.
Unit doesn't turn on.	<ul style="list-style-type: none">• Make sure the unit is plugged in.• Rotate and press down on the Nutri Ninja® cup or the "pulse" handle on the 40-oz. lid to turn the unit on.
Unit doesn't turn off.	<ul style="list-style-type: none">• Release your hand from the Nutri Ninja® cup or the "pulse" handle on the 40-oz. lid to turn the unit off.
Doesn't mix well.	<ul style="list-style-type: none">• Pulse ingredients for best results. Press down on the cup in short intervals for even blending and chopping. For frozen ingredients, pulse in short intervals of 2-5 seconds and repeat.

Replacement Parts

ORDERING REPLACEMENT PARTS

To order additional parts and attachments, please visit our website:

www.ninjakitchen.com or feel free to contact customer service: **1-877-646-5288**.

EURO-PRO

ONE (1) YEAR LIMITED WARRANTY

EURO-PRO Operating LLC warrants this product to be free from material defects and workmanship for a period of one (1) year from the date of purchase when utilized for normal household use, subject to the following conditions, exclusions and exceptions.

The liability of **EURO-PRO Operating LLC** is limited solely to the cost of the repair or replacement of the unit at our option. This Limited Warranty does not cover normal wear of parts and does not apply to any unit that has been tampered with or used for commercial purposes. This Limited Warranty does not cover damage caused by misuse, abuse, negligent handling or damage due to faulty packaging or mishandling in transit. This Limited Warranty does not cover damage or defects caused by or resulting from damages from shipping or repairs, service or alteration to the product or any of its parts, which have been performed by a repair person not authorized by **EURO-PRO Operating LLC**.

If your appliance fails to operate properly while in use under normal household conditions within the Limited Warranty period, you may return the complete appliance and accessories with proof of purchase and date, freight prepaid. For Customer Service support, call 1-877-646-5288 or visit our website www.ninjakitchen.com.

If the appliance is found by **EURO-PRO Operating LLC** to be defective, in **EURO-PRO Operating LLC's** sole discretion, we will repair or replace it free of charge. Proof of purchase date and a check made payable to **EURO-PRO Operating LLC** in the amount of \$19.95 to cover the cost of return shipping and handling must be included.*

This Limited Warranty is extended to the original purchaser of the unit and excludes all other legal, implied and/or conventional warranties. The responsibility of **EURO-PRO Operating LLC** if any, is limited to the specific obligations expressly assumed by it under the terms of this Limited Warranty. In no event is **EURO-PRO Operating LLC** liable for incidental or consequential damages to anyone of any nature whatsoever. Some states do not permit the exclusion or limitation of incidental or consequential damages, so the above may not apply to you.

This Limited Warranty gives you specific legal rights, and you may also have other rights which vary from state to state or from province to province.

***IMPORTANT: Carefully pack item to avoid damage in shipping. Be sure to include proof of purchase date and to attach tag to item before packing with your name, complete address and phone number with a note giving purchase information, model number and what you believe is the problem with the item. We recommend you insure the package (as damage in shipping is not covered by your Limited Warranty). Mark the outside of your package "ATTENTION CUSTOMER SERVICE".**

Product Registration

Please visit www.ninjakitchen.com or call **1-877-646-5288** to register your new Ninja® product within ten (10) days of purchase. You will be asked to provide the store name, date of purchase and model number along with your name and address.

The registration will enable us to contact you in the unlikely event of a product safety notification. By registering you acknowledge to have read and understood the instructions for use, and warnings set forth in the accompanying instructions.

Euro-Pro Operating LLC

US: Newton, MA 02459

CAN: Ville St-Laurent, QC H4S 1A7

1-877-646-5288

www.ninjakitchen.com

Copyright © Euro-Pro Operating LLC 2014

Euro-Pro, Kitchen System Pulse, Ninja and
Nutri-Ninja are trademarks of Euro-Pro Operating LLC.

Illustrations may differ from actual product. We are constantly striving to improve our products, therefore the specifications contained herein are subject to change without notice.

Printed in China

BL209.30.E.140703.2