

BL480 series

NUTRI NINJA®



www.ninjakitchen.com

IMPORTANT SAFETY INSTRUCTIONS

For Household Use Only

WHEN USING ELECTRICAL APPLIANCES, BASIC SAFETY PRECAUTIONS SHOULD ALWAYS BE FOLLOWED, INCLUDING THE FOLLOWING:

READ ALL INSTRUCTIONS BEFORE USING YOUR *NUTRI NINJA® WITH AUTO-iQ™*.

POLARIZED PLUG

WARNING: To reduce the risk of electric shock, this appliance has a polarized plug (one blade is wider than the other). This plug will fit into a polarized outlet only one way. If the plug does not fit fully into the outlet, reverse the plug. If it still does not fit, contact a qualified electrician to install the proper outlet. **DO NOT modify the plug in any way.**

WARNING:

TO REDUCE THE RISK OF FIRE, ELECTRIC SHOCK OR INJURY:

1. To protect against electrical shock, do not submerge the appliance or allow the power cord to come into contact with water or any other liquid.
2. **DO NOT** allow young children to operate the appliance or use as a toy. Close supervision is necessary when any appliance is used by or near children.
3. Never leave an appliance unattended when in use.
4. Remove the power cord from the electrical outlet when not in use, before assembling or disassembling parts and before cleaning. To unplug, grasp the plug and pull from the electrical outlet. Never pull from the power cord.
5. **DO NOT** abuse the power cord. Never carry the appliance by the power cord or yank it to disconnect from electrical outlet; instead grasp the plug and pull to disconnect.
6. **DO NOT** operate any appliance with a damaged cord or plug, or after the appliance malfunctions, has been dropped or damaged in any manner. Return the appliance to EURO-PRO Operating LLC for examination, repair or adjustment.
7. **DO NOT** let the power cord hang over the edge of table or counter or touch hot surfaces such as the stove.
8. Always use appliance on a dry, level surface.



9. Keep hands, hair, clothing, as well as utensils out of cup while processing to reduce the risk of severe injury to persons or damage to the appliance. A scraper may be used but only when the appliance is not running.
10. **CAUTION: Blade assembly is sharp, handle with care. When handling the blade assembly, always hold by the base of the blade assembly.**
11. Avoid contact with moving parts.
12. **DO NOT attempt to sharpen blades.**
13. **DO NOT** use the appliance if blade assembly is bent or damaged.
14. To reduce risk of injury, never place the blade assembly on the base without the proper attachment.
15. **DO NOT** operate this appliance on or near any hot surfaces (such as gas or electric burner or in a heated oven).
16. The use of attachments or accessories including canning jars, not recommended or sold by the manufacturer may cause fire, electric shock or personal injury.
17. **DO NOT** remove the cup from the motor base while the appliance is running.
18. To reduce the risk of injury, **NEVER** operate the appliance without the blade assembly in place; **DO NOT** try to defeat the interlock mechanism; make sure that the attachment is properly installed before operating the appliance.
19. **DO NOT** expose cups to extreme temperature changes.
20. **CAUTION: DO NOT PROCESS HOT FOODS OR HOT LIQUIDS.**
21. **CAUTION: DO NOT process dry ingredients without adding liquid to the cup. This product is not intended for dry blending.**
22. **DO NOT** overfill.
23. **DO NOT** operate the appliance empty.
24. If the appliance overheats, a thermal switch will become activated and shut off the motor. To reset, unplug the appliance and let it cool down for approximately 30 minutes before using again.
25. **THIS PRODUCT IS INTENDED FOR HOUSEHOLD USE ONLY.** Do not use this appliance for anything other than its intended use. Do not use outdoors.
26. Appliance accessories are not intended to be used in the microwave. Do not place the cup or the lid in the microwave as it may result in damage to the accessories.

⚠ WARNING: Extension cords are not recommended for use with this product.

SAVE THESE INSTRUCTIONS

THIS BOOK COVERS MODEL NUMBERS:

BL480 30

BL480W 30

BL481 30

BL483 30

BL484 30

TECHNICAL SPECIFICATIONS

Voltage: 120V., 60Hz.

Power: 1000 Watts

Cup Capacity:

32 ounces (4 cups) (included in some models)

24 ounces (3 cups)

18 ounces (2.25 cups)

NOTE: Select accessories are included. Other are available for purchase at www.ninjakitchen.com. To see what is included with this model, please refer to the packaging.

Euro-Pro, Nutri Ninja, AUTO-iQ, Sip & Seal, Pro Extractor Blades and Ninja are trademarks of Euro-Pro Operating LLC.

Contents

Thank you for
purchasing the
Nutri Ninja®
with AUTO-
iQ™

Getting to Know Your Nutri Ninja® with AUTO-iQ™	5
Before First Use	7
Use	8
Suggested Uses	9
Care & Maintenance	10
Troubleshooting Guide	11
Replacement Parts	11
Sample Recipes	12
Warranty & Registration	14

Getting To Know Your Nutri Ninja® with AUTO-iQ™

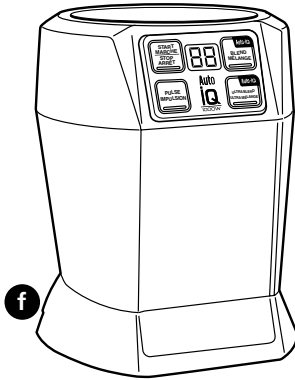
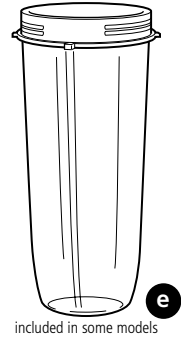
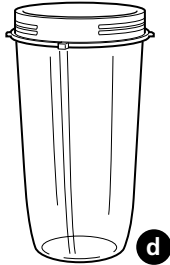
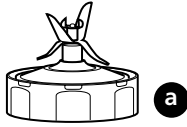

- a Pro Extractor Blades™ Assembly
- b Sip & Seal™ Lid
- c Small 18 oz. Nutri Ninja® Cup
- d Regular 24 oz. Nutri Ninja® Cup
- e Jumbo Multi Serve 32 oz. Nutri Ninja® Cup
(included in some models)

- f Motor Base
- g Inspiration Guide (not shown,
included in some models)
- h Cookbook (not shown,
included in some models)

NOTE: The quantity, sizes, and presence of some accessories depends on the specific model configuration. All configurations include a motor base, blade assembly, certain Nutri Ninja® cups, Sip & Seal™ Lids, and instructions.

Welcome to the Ninja® AUTO-iQ™ Experience! The Nutri Ninja® with AUTO-iQ™ features pre-programmed settings that take the guesswork out of drink and meal making. These programs are timed to deliver consistent, delicious results that finish on their own so all you have to do is press a button and enjoy!

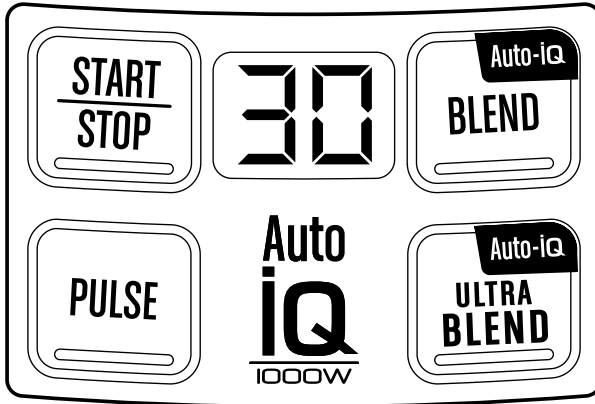

FEATURES:

- **Nutrient & Vitamin Extraction**
- **1000 Watt Motor**
- **User Interface:**
 - START | STOP**
Press once to start continuous running, press again to stop.
Timer counts up by seconds, up to 60 seconds.
 - PULSE**
Runs only while pressed down. Short presses make short pulses.
Timer counts up by seconds as long as pressed down.
 - AUTO-iQ™ BLEND**
Pulses and blends fresh or softer ingredients to create smooth consistent results. Timer counts down.
 - AUTO-iQ™ ULTRA BLEND**
Pulses and blends frozen, fibrous or hard ingredients to create smooth consistent results. Timer counts down.
- **Personalized, healthy drinks and juices**
- **Sip & Seal™ lids for drinks on the go**
- **Nutri Ninja® Cups, BPA free**
- **Cord storage**

Before First Use

PLEASE KEEP THESE IMPORTANT SAFEGUARDS IN MIND WHEN USING THE APPLIANCE:

-  **IMPORTANT:** Attachments are interchangeable.
-  **CAUTION:** Blades are sharp! Use extreme caution when handling the blade assemblies. Always hold them by the base of the blade assembly.
-  **IMPORTANT:** Never run the appliance empty.
-  **CAUTION:** DO NOT PROCESS HOT FOODS OR HOT LIQUIDS.
-  **CAUTION:** Never attempt to remove the cup while the appliance is still running.
-  **WARNING:** Never leave the appliance unattended while in use.

- 1 Remove all packaging material and labels from the appliance.
- 2 Wash the lids, cups and blade assembly in warm, soapy water with a soft cloth. **Use caution when washing the blade assembly as the blades are very sharp.**
- 3 Rinse and dry thoroughly.
- 4 Cups, lids and blade assembly are all dishwasher safe. It is recommended that the lids and attachments be placed on the top rack. Ensure that the blade assembly is removed from the cups before placing in the dishwasher.
- 5 Wipe the motor base clean with a damp cloth.

Use

ASSEMBLY

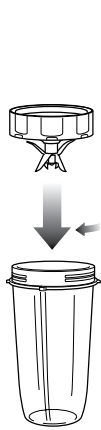

Fig. 1

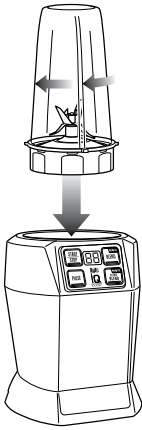

Fig. 2

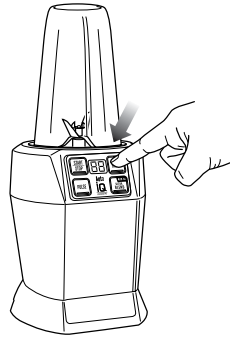

Fig. 3



Fig. 4

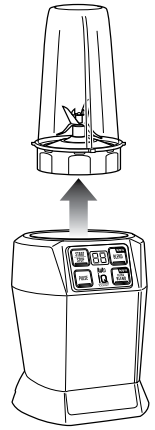

Fig. 5

▲ IMPORTANT: Place the motor base on a clean, dry, level surface such as a counter or table top.

- 1 Make sure that the motor base is plugged in for use. **No lights will turn on.**
- 2 Add ingredients to the cup.

NOTE: Do not overfill! To avoid spilling, do not add ingredients past the "MAX" fill line.

- 3 Place the blade assembly onto the cup and twist it on tightly until you have a good seal. **(Fig. 1)**
- 4 Turn the cup upside down and place it onto the motor base, aligning the tabs on the cup with the motor base. Turn it clockwise, until you feel it click into place. The Timer light will illuminate. **(Fig. 2)**
- 5 Press one of the buttons to activate. **(Fig. 3)**

NOTE: When using the AUTO-iQ™ presets, the unit will operate using pulses, pauses and continuous runs. The pauses allow the contents of the cup to settle. When the timer reaches "0", it will stop by itself.

- 6 To remove the cup, ensure that the motor is stopped running. Then turn the cup counter clockwise **(Fig. 4)** and pull straight up to remove. **(Fig. 5)**
- 7 Turn the cup upright and remove the blade assembly by twisting the blade assembly counter clockwise. Be sure to store the blade assembly attached to an empty cup when not in use.
- 8 Twist the Sip & Seal™ lid onto the cup to enjoy your drink on the go. Press flip top cap firmly into the opening to get the best seal. The flip top cap locks open when pressed backward.
- 9 Make sure that the motor base is unplugged when not in use.
- 10 To remove the motor base unit, tip the unit forward from the rear to easily disengage the suction cups.

Suggested Uses

PURPOSE / FUNCTION	SUGGESTED CUP	TYPE OF FOOD
Chopping / Pulsing	18 oz. 24 oz.	Salsa Leafy Herbs
Mixing	24 oz. 32 oz.	Batters Dips
Sauces	24 oz. 32 oz.	Vinaigrettes Salad Dressings Simple Sauces
Frozen Blending	18 oz. 24 oz. 32 oz.	Ice Frozen Fruit Ice Cream
Nutrient Juices/Smoothies	18 oz. 24 oz. 32 oz.	Fruits Vegetables Leafy Greens

CAUTION: DO NOT process dry ingredients without adding liquid to the cup. This product is not intended for dry blending.

FILLING YOUR NUTRI NINJA®

For best results, always follow recipe directions when filling your Nutri Ninja® cups. When you're not using a recipe, use the following guidelines:

Start with your Fresh Fruit or Veggies. Then add any Nuts, Seeds or Powder followed by any liquids like Juice or Milk. More liquid can help to integrate powder. Then add your Frozen Fruit and Ice. Remember to securely tighten the blade and don't overfill the cups. (Fig. 6)

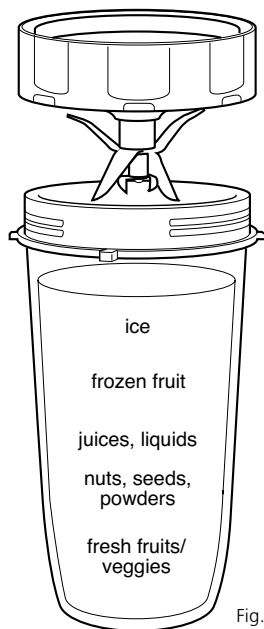

Fig. 6

Care & Maintenance

HOW TO CLEAN

⚠ CAUTION: Make sure that the motor base is unplugged from the power source before inserting or removing any attachment and before cleaning.

⚠ CAUTION: DO NOT immerse the motor base into water or any other liquid.

- 1 Separate/remove all parts from each other.
- 2 Clean the motor base with a damp cloth and wipe dry.
- 3 Place cups in the dishwasher. Place the lids and attachments on the top rack. **Use caution when handling the blade assemblies as the blades are very sharp.**

NOTE: You may also wash the cups by filling the cup to the Max fill line with warm water and a drop of dish washing detergent, placing the blade assembly on the cup and pulsing a few times. Do not fill the cup more than Max fill line with water because it will overflow. Once clean, remove the cup from the motor base. Rinse the cup, attachment and lid under running water. Allow all the parts to dry before storing.

If the appliance needs servicing, please call customer service at 1-877-646-5288.

HOW TO STORE

- 1 Store the *Nutri Ninja® with AUTO-iQ™* upright. Secure the power cord underneath the base by wrapping the cord around the cord wrap. Do not place anything on top. Store the cups and the rest of the attachments along side the appliance where they will not be damaged and won't cause a hazard.

RESETTING THE MOTOR THERMOSTAT

The *Nutri Ninja® with AUTO-iQ™* features a unique safety system which prevents damage to the unit's motor and drive system should you inadvertently overload your appliance. If the appliance is being overloaded, the motor will stop. To reset the appliance, follow the resetting procedure below:

- 1 Unplug the appliance from the electrical outlet.
- 2 Remove and empty the cup and ensure that no food is jamming the cutting blades.
- 3 Allow the appliance to cool for approximately 30 minutes.
- 4 Re-install the cup onto the base and re-plug the appliance into the electrical outlet.
- 5 Proceed to use the appliance as before while making sure not to exceed the recommended maximum capacities.

Troubleshooting Guide

PROBLEMS	POSSIBLE REASONS & SOLUTIONS
Unit doesn't turn on	<ul style="list-style-type: none">• Make sure the unit is plugged in• Insert and rotate cup clockwise in the base until it "clicks". Display should turn on.
Unit doesn't turn off	<ul style="list-style-type: none">• Remove cup from base by rotating cup counter clockwise and lifting out. Display should turn off. Unplug the power cord from the outlet.
Lid/blade assembly hard to assemble	<ul style="list-style-type: none">• Set the cup on a level surface. Place the lid or blade assembly on the top of the cup and align the threads so that the lid/blades sit flat on the cup. Twist clockwise so that the lid/blades evenly align to the cup until you have a tight seal.
Food is not evenly chopped	<ul style="list-style-type: none">• For best results when chopping, make sure all ingredients are as dry as possible. Cut pieces down to even sizes, and reduce the amount of food in the cup. Use very short pulses by quickly pressing the "PULSE" button.
Doesn't mix well, food gets stuck.	<ul style="list-style-type: none">• Using the AUTO-iQ™ programs is the easiest way to achieve great results. The pulses and pauses allow the food to settle towards the blade. If food is routinely getting stuck adding some liquid will usually help.• When packing the cups, start with fresh items, then powders/nuts. Add liquids, and finally frozen items or ice.
Unit moves on counter while blending	<ul style="list-style-type: none">• Make sure the surface as well as the feet of the unit are clean and dry.
Unit is difficult to remove from counter for storage	<ul style="list-style-type: none">• Tip unit forward from the back to easily disengage the suction feet.

Replacement Parts

ORDERING REPLACEMENT PARTS

To order additional parts and attachments, please visit our website: www.ninjakitchen.com or feel free to contact customer service: 1-877-646-5288.

Sample Recipes

Watermelon Cooler

Ingredients:

- ¼ pear, seeded, cut into chunks
- 2 large fresh basil leaves with stems removed
- 2 cups chilled watermelon, seeded, cut into chunks

Directions:

1. Place all ingredients in the order listed above into the Nutri Ninja® 24 oz. cup.
2. Lock cup onto the base and select AUTO-iQ™ BLEND

Purple Potion

Ingredients:

- ¾ cup beets, peeled, cut into chunks
- 1 cup frozen blueberries
- 1¼ cup carrot juice

Directions:

1. Place the beets with 2 cups of water into a small saucepan over medium heat and cook until tender. Drain, cool completely and set aside.
2. Place all the ingredients in the order listed above into the Nutri Ninja® 24 oz. cup.
3. Lock cup onto the base and select AUTO-iQ™ ULTRA BLEND

Easy Weeknight Burgers

Ingredients:

- 8 ounces London Broil, trimmed of fat, cut into 2-inch pieces
- Kosher salt and fresh ground black pepper to taste
- 2 hamburger buns, sliced
- Toppings of choice

Directions:

1. Place the meat in the Ninja 24 ounce cup. Lock cup into base and press START|STOP for 15 seconds.
2. Season ground meat with salt and pepper and form into two patties.
3. Lightly coat a nonstick skillet with cooking spray. Over medium heat, cook the burgers to desired doneness, about 4-5 minutes per side for medium.
4. Serve each burger on a bun with toppings of choice.

EURO-PRO

ONE (1) YEAR LIMITED WARRANTY

EURO-PRO Operating LLC warrants this product to be free from material defects and workmanship for a period of one (1) year from the date of purchase when utilized for normal household use, subject to the following conditions, exclusions and exceptions.

The liability of **EURO-PRO Operating LLC** is limited solely to the cost of the repair or replacement of the unit at our option. This Limited Warranty does not cover normal wear of parts and does not apply to any unit that has been tampered with or used for commercial purposes. This Limited Warranty does not cover damage caused by misuse, abuse, negligent handling or damage due to faulty packaging or mishandling in transit. This Limited Warranty does not cover damage or defects caused by or resulting from damages from shipping or repairs, service or alteration to the product or any of its parts, which have been performed by a repair person not authorized by **EURO-PRO Operating LLC**.

If your appliance fails to operate properly while in use under normal household conditions within the Limited Warranty period, you may return the complete appliance and accessories with proof of purchase and date, freight prepaid. For Customer Service support, call 1-877-646-5288 or visit our website www.ninjakitchen.com.

If the appliance is found by **EURO-PRO Operating LLC** to be defective, in **EURO-PRO Operating LLC's** sole discretion, we will repair or replace it free of charge. Proof of purchase date and a check made payable to **EURO-PRO Operating LLC** in the amount of \$19.95 to cover the cost of return shipping and handling must be included.*

This Limited Warranty is extended to the original purchaser of the unit and excludes all other legal, implied and/or conventional warranties. The responsibility of **EURO-PRO Operating LLC** if any, is limited to the specific obligations expressly assumed by it under the terms of this Limited Warranty. **In no event is EURO-PRO Operating LLC** liable for incidental or consequential damages to anyone of any nature whatsoever. Some states do not permit the exclusion or limitation of incidental or consequential damages, so the above may not apply to you.

This Limited Warranty gives you specific legal rights, and you may also have other rights which vary from state to state or from province to province.

***IMPORTANT: Carefully pack item to avoid damage in shipping. Be sure to include proof of purchase date and to attach tag to item before packing with your name, complete address and phone number with a note giving purchase information, model number and what you believe is the problem with the item. We recommend you insure the package (as damage in shipping is not covered by your Limited Warranty). Mark the outside of your package "ATTENTION CUSTOMER SERVICE".**

Product Registration

Please visit www.ninjakitchen.com or call **1-877-646-5288** to register your new Ninja® product within ten (10) days of purchase. You will be asked to provide the store name, date of purchase and model number along with your name and address.

The registration will enable us to contact you in the unlikely event of a product safety notification. By registering you acknowledge to have read and understood the instructions for use, and warnings set forth in the accompanying instructions.

Euro-Pro Operating LLC

US: Newton, MA 02459

CAN: Ville St-Laurent, QC H4S 1A7

1-877-646-5288

www.ninjakitchen.com

Copyright © 2014 Euro-Pro Operating LLC

Euro-Pro, Nutri Ninja, AUTO-iQ, Sip & Seal, Pro Extractor Blades and Ninja are trademarks of Euro-Pro Operating LLC.

Illustrations may differ from actual product. We are constantly striving to improve our products, therefore the specifications contained herein are subject to change without notice.

Printed in China

BL480 series.30.E.140919.2