

## COOKING FUNCTIONS

Make sure to place cooking pot in the main housing **at all times, with all cooking functions**. When adding ingredients to pot, do not exceed the Maximum Level marker.

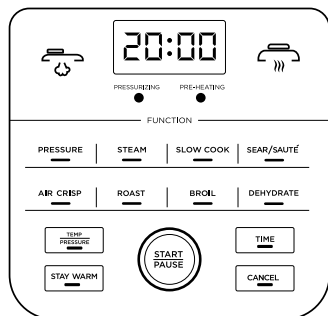

1. Press button of the **cooking function** you want to use.
2. To **set cooking temperature or pressure**, turn **START/PAUSE** dial.
3. To **set cooking time**, press **TIME** button, then turn **START/PAUSE** dial.
4. To **begin cooking**, press **START/PAUSE**.

FUNCTION	ADD INGREDIENTS TO	NOTES
<b>PRESSURE COOK</b>		There are two ways to release pressure when cooking is complete. For quick pressure release, press and turn <b>PRESSURE RELEASE</b> button on pressure cooker lid clockwise. For natural release, leave the unit untouched for the amount of time your recipe calls for, then quick release any remaining pressure.
<b>STEAM</b>		Place ingredients on reversible layered rack and add water to cooking pot.
<b>SLOW COOK</b>		
<b>AIR CRISP</b>		To shake ingredients for even cooking, open lid, attach handle to basket, pick up basket by attached handle, and shake. When done, set basket back down, remove handle, and close lid.
<b>ROAST</b>		
<b>BROIL</b>		Use the Reversible Layered Rack in the broil orientation.
<b>DEHYDRATE</b>		Use the bottom of the Cook & Crisp™ basket for your first layer and the double-layer insert to double your dehydrating capacity. A 5-layer dehydrating accessory can be ordered from <a href="http://ninjaccessories.com">ninjaccessories.com</a>
<b>SEAR/SAUTÉ</b>		Wait for the surface and oil to become hot before adding ingredients.
<b>TENDERCRISP™ TECHNOLOGY</b>		Combine two different functions for meals done quickly that are crispy on the outside and tender on the inside.

Please make sure to read the enclosed Ninja® Owner's Guide prior to using your unit.

## NINJA® FOODI™ COOKER QUICK ASSEMBLY AND GETTING STARTED

### YOUR FOODI COOKER

#### PARTS

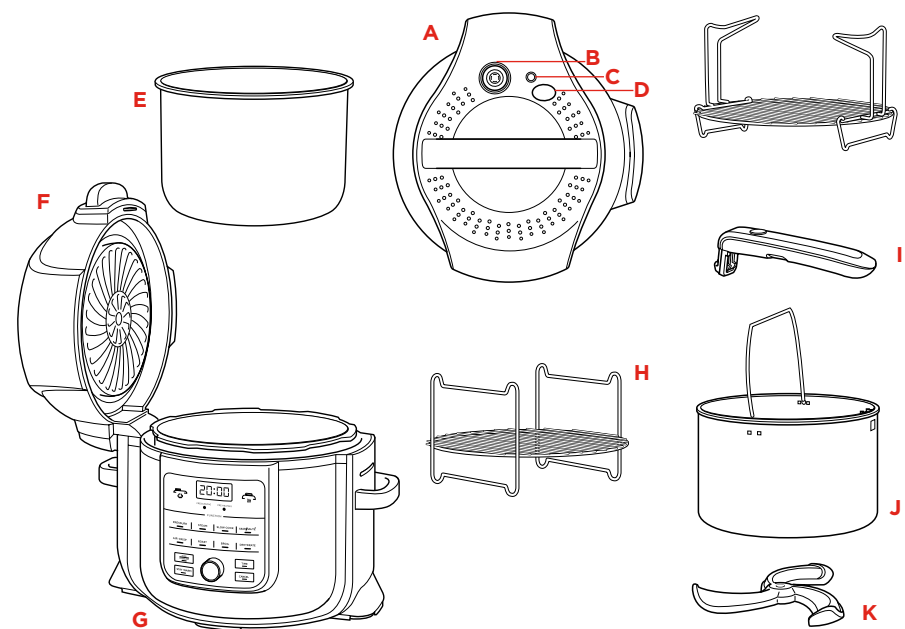

- |                                  |                                  |
|----------------------------------|----------------------------------|
| <b>A</b> Pressure Cooker Lid     | <b>G</b> Main Housing            |
| <b>B</b> Pressure Release Valve  | <b>H</b> Double-Layer Insert     |
| <b>C</b> Red Float Valve         | <b>I</b> Reversible Layered Rack |
| <b>D</b> Pressure Release Button | <b>J</b> Detachable Handle       |
| <b>E</b> Removable Cooking Pot   | <b>K</b> Cook & Crisp™ Basket    |
| <b>F</b> Hinged Lid              | <b>L</b> Detachable Diffuser     |

NINJA is a registered trademark of SharkNinja Operating LLC.  
COOK & CRISP, FOODI, and TENDERCRISP are trademarks of SharkNinja Operating LLC.

## ASSEMBLY AND USE

### HINGED LID AND PRESSURE COOKER LID



#### HINGED LID

The hinged lid should be used only with the AIR CRISP, BROIL, ROAST and DEHYDRATE functions. While cooking, you can lift the hinged lid to carefully take a quick peek at your food.

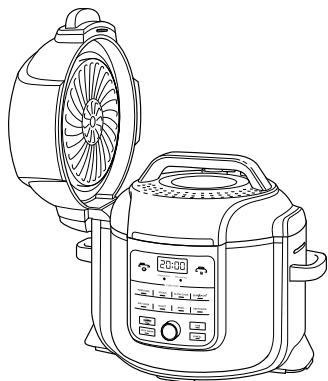

#### PRESSURE COOKER LID

The pressure cooker lid should be used only with the PRESSURE, STEAM, and SLOW COOK functions. If desired, it can also be used with the SEAR/SAUTÉ function.

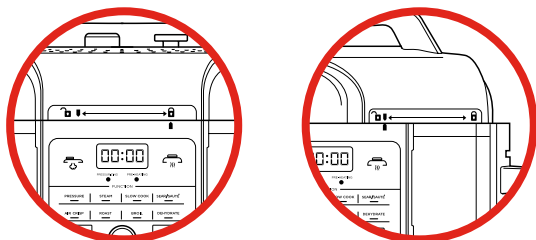

After adding ingredients to pot, install the pressure cooker lid by aligning the unlock symbol on the lid with the dash line on the unit. Then rotate lid clockwise until it clicks into place and the line on the main housing aligns with the lock symbol.

### OPERATING BUTTONS



After a function is selected, the default temperature or pressure level will appear. Turn the **START/PAUSE** dial to set the pressure or temperature levels. To adjust while cooking, press the **TEMP/PRESSURE** button and turn the **START/PAUSE** dial to adjust temperature.



Press **TIME** button and turn **START/PAUSE** dial to set the cooking time. To adjust while cooking, press the **TIME** button and turn the **START/PAUSE** dial.



Turn **START/PAUSE** dial clockwise to increase temperature, pressure, or time; turn it counterclockwise to decrease. Press the **START/PAUSE** button on the dial to immediately **START** the selected program. Press this button while the unit is operating to **PAUSE** the program.



After pressure cooking, steaming, or slow cooking time runs out, **STAY WARM** will automatically come on. You may turn **STAY WARM** off by pressing **STAY WARM**.



Press this button to cancel the program and return the cooker to standby mode.

**QUESTIONS?** We're here to help. Call 1-877-646-5288 or visit [ninjakitchen.com](http://ninjakitchen.com)

## COOKING FUNCTIONS

### PRESSURE RELEASE BUTTON AND SLOW COOK/STEAM

#### TO SEAL PRESSURE RELEASE BUTTON

Before pressure cooking, be sure the **PRESSURE RELEASE** button is **NOT** in the vent position. To return the button to the sealed position, turn the **PRESSURE RELEASE** button counterclockwise.

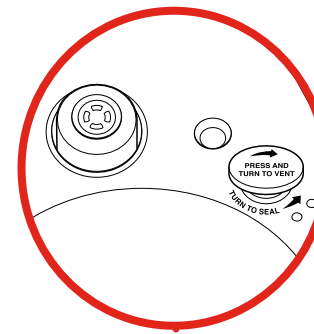

#### TO PULSE VENT AND QUICK RELEASE PRESSURE

To release short bursts of pressure, pulse vent by pressing the **PRESSURE RELEASE** button.

To quick release pressure, press and twist the **PRESSURE RELEASE** button clockwise.

**⚠ WARNING:** To avoid scalding steam being released from pressure valve, keep hands and face away during use and when pressing the Pressure Relief button.

For slow cooking and steaming, make sure the pressure cooker lid is properly assembled and the **PRESSURE RELEASE** button is in the vent position.

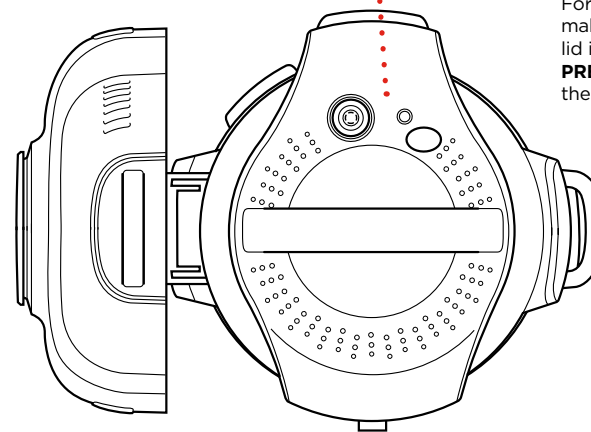

### CLEANING

**Cooking Pot:** Clean the cooking pot thoroughly after every use with warm, soapy water. The cooking pot is dishwasher safe.

**Cook & Crisp™ Basket:** Clean the Cook & Crisp basket thoroughly after every use with warm, soapy water. The Cook & Crisp basket is dishwasher safe.

**Reversible Layered Rack:** Clean the rack thoroughly after every use with warm, soapy water. The rack is dishwasher safe.

**Splash Guard:** The splash guard on the inside of the hinged lid is specifically made for easy cleaning. After the hinged lid has completely cooled down from cooking, wipe the vent and outside of lid with a damp paper towel or sponge to clean. **DO NOT** spray cleaning solution directly onto vents.

**Pressure Cooker Lid:** The pressure cooker lid, including the silicone rubber gasket (which can be removed), pressure release valve, and anti-block shield can be washed with water and detergent.

**QUESTIONS?** We're here to help. Call 1-877-646-5288 or visit [ninjakitchen.com](http://ninjakitchen.com)