

MANUAL MODE

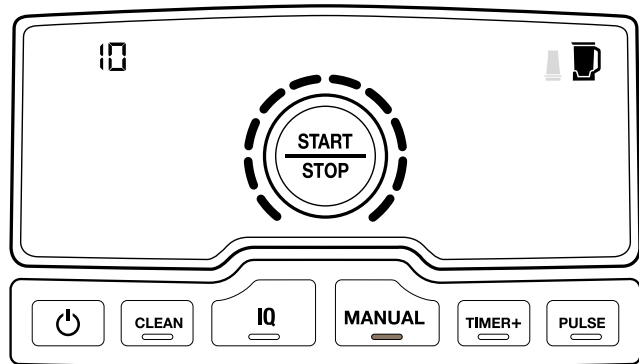

Turn the dial from 1 to 10 for total control of blending speed. Press START/STOP to begin and end blending.

OTHER MODES

CLEAN

- **Pitcher:** To run the self-cleaning program with the pitcher, first add warm water to the MAX CLEAN line and two drops of dishwashing soap to the pitcher. Secure pitcher lid and lid cap in place. Select CLEAN mode, then press START/STOP to begin. The unit will shut down when the self-cleaning cycle is complete. Make sure to thoroughly rinse and air-dry the pitcher.
- **Cup:** When using CLEAN mode for the blender cup, fill the cup halfway with warm water and add one drop of dishwashing soap. Secure the Pro Extractor Blades® Assembly to the blender cup, then install cup onto motor base. Select CLEAN mode, then press START/STOP to begin. The unit will shut down when the self-cleaning cycle is complete. Make sure to thoroughly rinse and air-dry the cup.

TIMER+

Use TIMER+ mode to set a countdown timer. Select TIMER+ and add blend time in 10-second intervals by repeatedly pressing the TIMER+ button. Set the speed by rotating the dial to the desired setting. Press START/STOP to activate the unit. Blending will stop automatically when countdown is complete.

PULSE

Select PULSE and turn dial to desired speed. Press the START/STOP button in short bursts to pulse. The unit will blend only while button is pressed.

CLEANING

Dishwasher: All attachments are dishwasher safe. It is recommended that the tamper, lid, and cap be placed on the top rack of the dishwasher. Exercise care when washing Pro-Extractor Blades Assembly and pitcher, as the blade assemblies are sharp.

Hand-washing: Wash pitcher in warm, soapy water using a dishwashing utensil with a handle to avoid direct contact with the blades. Exercise care when washing Pro-Extractor Blades Assembly and pitcher, as the blade assemblies are sharp. Thoroughly rinse and air-dry all parts.



WARNING: Handle the Pro Extractor Blades Assembly and the pitcher's bottom blades with care, as they are sharp. Contact with the blades' edges can result in laceration.

QUESTIONS? We're here to help. Call 1-877-646-5288 or visit ninjakitchen.com

Please make sure to read the enclosed Ninja® Owner's Guide prior to using your unit.

NINJACHEF™ DUO™ QUICK ASSEMBLY

PITCHER

PARTS



PITCHER



PITCHER LID



LID CAP



TAMPER

ASSEMBLY

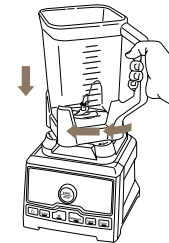

1. Lower pitcher onto motor base, then rotate clockwise until it clicks into place.

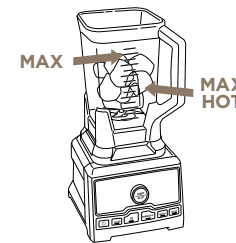

2. Add ingredients to pitcher, making sure not to exceed Max Liquid line. **Hot ingredients cannot exceed the Max Hot Liquid line.**

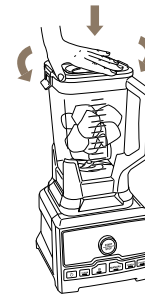

3. Place lid onto pitcher, then press down firmly, making sure that both side clips on lid fully snap onto lip of pitcher.

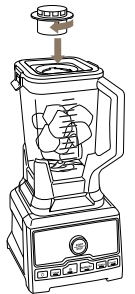

4. Insert lid cap into lid and turn clockwise to lock.



WARNING: Pitcher's bottom blades are sharp. Contact with the blades can result in laceration.

IN USE



BLENDING

Press the power button. The base defaults to Auto-iQ® Mode. Select the desired program and press START/STOP, or press MANUAL to switch modes and use the dial to select blending speed.



TAMPER

If unmixed ingredients are sticking to the pitcher, remove lid cap and use tamper to push ingredients closer to the blades.

QUESTIONS? We're here to help. Call 1-877-646-5288 or visit ninjakitchen.com

SINGLE-SERVE CUP

PARTS



SINGLE-SERVE CUP



SPOUT LID



PRO EXTRACTOR BLADES® ASSEMBLY

ASSEMBLY



1. Fill Single-Serve Cup with desired contents.



2. Place Pro Extractor Blades® Assembly on cup and rotate clockwise until sealed tightly.

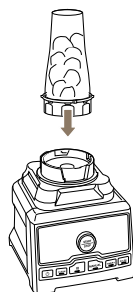

3. Flip cup upside down and lower it onto base.

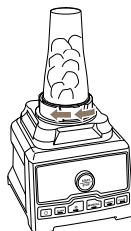

4. Turn cup clockwise to lock in place.

BLEND & ENJOY

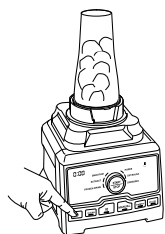

1. Turn dial to select the desired program, then press START/STOP.

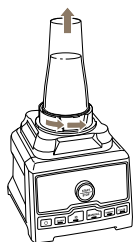

2. When blending is complete, turn cup counterclockwise and lift to remove.



3. Turn blade assembly counterclockwise to remove.



4. Place Spout Lid on top of cup and turn clockwise to lock in place.

Once a container is locked onto base, the programs compatible with that container will illuminate.

AUTO-IQ® MODE

AUTO-IQ TECHNOLOGY

Auto-iQ's unique timed programs are customized to take the guesswork out of making great drinks and meals.

Turn dial to select the desired program, then press START/STOP to begin. As the program runs, the timer will count down. When the countdown ends, blending will stop automatically.

PITCHER

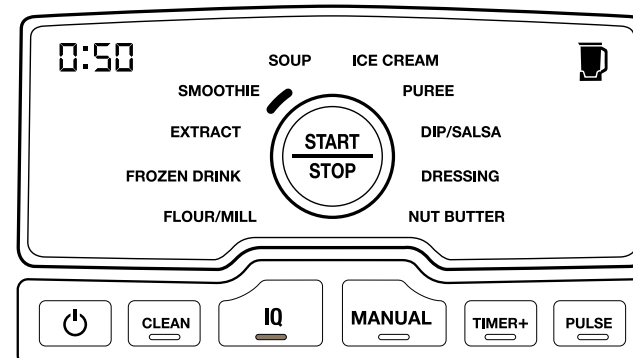

SINGLE-SERVE CUP

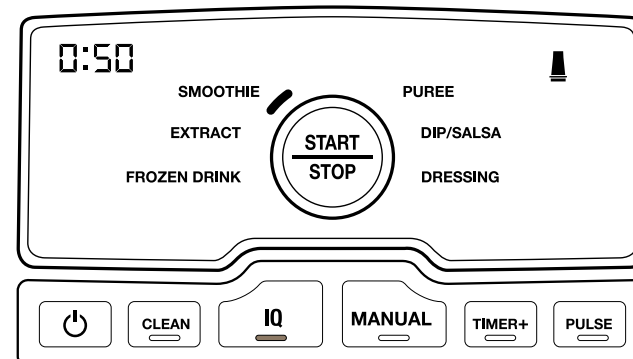

WARNING: Handle the Pro Extractor Blades Assembly with care, as the blades are sharp.

QUESTIONS? We're here to help. Call 1-877-646-5288 or visit ninjakitchen.com

QUESTIONS? We're here to help. Call 1-877-646-5288 or visit ninjakitchen.com