

## CLEANING



### DISHWASHER:

- 1 The cups, lids, and blade assembly are all dishwasher safe. The lids and blade assembly are top-rack dishwasher safe. Ensure the blade assembly is removed from the cup before placing in the dishwasher.
- 2 Place cup in the dishwasher with Flip & Seal Lid open to remove food residue while cleaning.

**DO NOT PUT THE OVERFLOW RESERVOIR IN THE DISHWASHER.**



### HAND-WASHING:

Wash cups, lids, blade assembly, and overflow reservoir in warm, soapy water. When washing the blade assembly, use a dishwashing utensil with a handle to avoid direct hand contact with blades. Handle blade assembly with care to avoid contact with sharp edges. Rinse and air-dry thoroughly.

**DO NOT SUBMERGE THE PUMP IN WATER.**

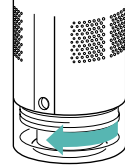

**HOW TO REMOVE OVERFLOW RESERVOIR**  
Twist it counterclockwise to remove it from the FreshVac Pump.



**WARNING:** Always unplug the base before cleaning.



**WARNING:** Handle the blade assembly with care when washing, as the blades are sharp. Contact with the blades' edges can result in laceration.

**QUESTIONS?** We're here to help. Visit [ninjakitchen.com](http://ninjakitchen.com)

Please make sure to read the enclosed Ninja Owner's Guide prior to using your unit.

# NUTRI NINJA

WITH  
**FRESHVAC™ TECHNOLOGY**

# QUICK START GUIDE

## PARTS

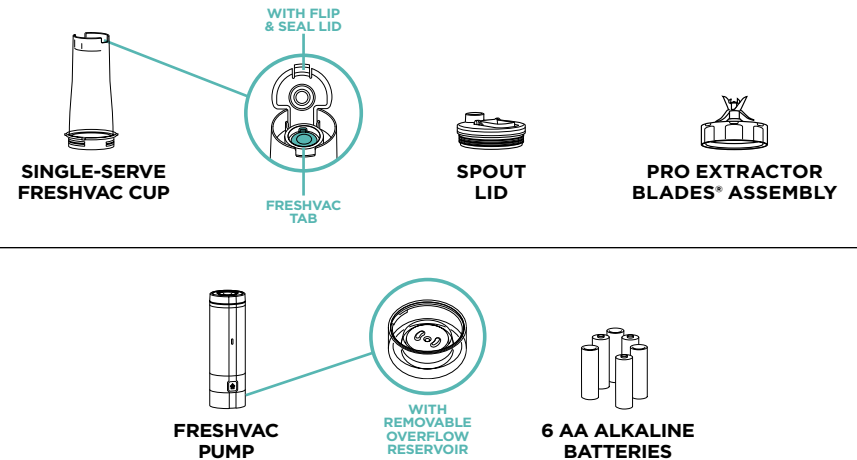

## INSTALLING THE BATTERIES IN THE FRESHVAC PUMP

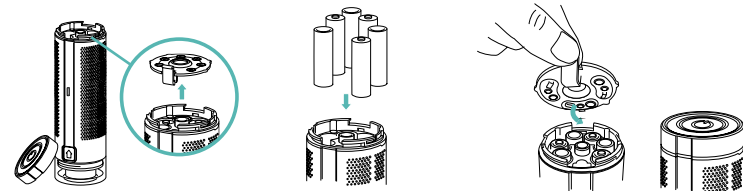



**1** Unscrew the FreshVac Pump's power button cap and remove the battery cover.

**2** Install 6 AA alkaline batteries (included), ensuring the +/- symbols on the batteries match the markings on the battery cover and battery housing.

**3** Replace the battery cover, making sure it is fully seated and clicked in place. Screw on the pump's power button cap.

### LIGHT INDICATORS

 **White light:**  
Vacuum sealing in progress

 **Green light:**  
Vacuum sealing complete

 **If light blinks white and green,**  
replace batteries or make sure they're properly installed.

## TRADITIONAL BLENDING MODE



**1** Fill the cup with desired contents, making sure to not exceed the MAX LIQUID line. Then place Pro Extractor Blades® Assembly on cup and rotate clockwise until tightly sealed.



**2** Flip cup upside down and lower it onto base. Push down on the cup until you hear a soft click.

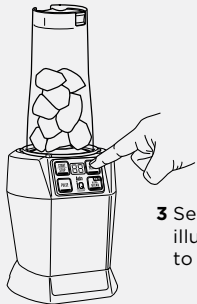

**3** Select any of the illuminated programs to begin blending.

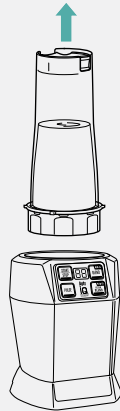

**4** When blending is complete, lift cup to remove.



**5** Turn blade assembly counterclockwise to remove.



**6** Place spout lid on top of cup and turn clockwise to lock in place.

**⚠ WARNING:** Handle the blade assembly with care, as the blades are sharp.

**QUESTIONS?** We're here to help. Visit [ninjakitchen.com](http://ninjakitchen.com)

## OXYGEN REMOVAL BLENDING



**1** Fill the cup with desired contents, making sure to not exceed MAX LIQUID line. Then place Pro Extractor Blades® Assembly on cup and rotate clockwise until tightly sealed.

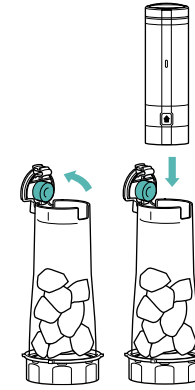

**2** Turn cup upside down so the Flip & Seal Lid is on top and the bottom of the blade assembly is flat on the counter.

**3** Open the Flip & Seal Lid by pressing and lifting the latch. Set the FreshVac™ Pump on top of the FreshVac Tab.

**The pump DOES NOT lock in place on the lid.**

Be sure FreshVac Tab is dry before using FreshVac Pump.

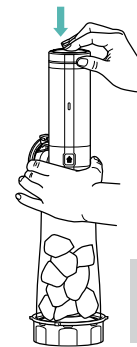

Do not use FreshVac Pump **after** blending, as this could damage the pump.

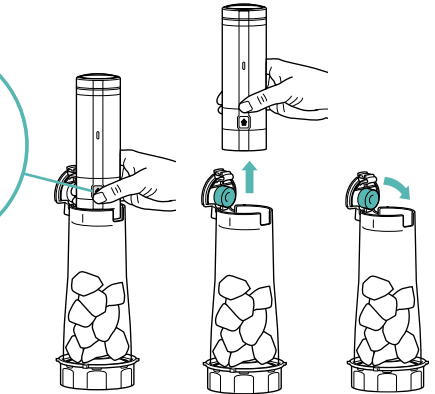
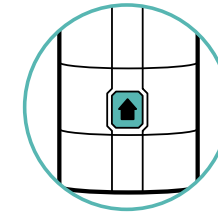

**4** Press the power button on top of the pump to begin vacuum sealing. The pump will shut off automatically once vacuum sealing is complete.

**5** To release the pump from the cup, press the pump release button on the bottom front of the pump and lift. Click the Flip & Seal Lid closed.

**6** Lock cup in place on base and blend as desired. Once blending is complete, remove the cup from the base and place the cup flat on the counter.

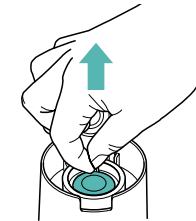

**7** Gently pull up on the FreshVac Tab until hissing sound stops to release the vacuum seal, then close the Flip & Seal Lid.

**DO NOT PULL TAB OUT**

**8** Remove the blade assembly and screw the spout lid clockwise onto the cup.

**⚠ WARNING:** Handle the blade assembly with care when washing, as the blades are sharp. Contact with the blades' edges can result in laceration.

**QUESTIONS?** We're here to help. Visit [ninjakitchen.com](http://ninjakitchen.com)