

Please make sure to read the enclosed Ninja® Owner's Guide prior to using your unit.

NINJA®

PROFESSIONAL BLENDER AND NUTRI NINJA® CUPS

QUICK ASSEMBLY

NUTRI NINJA® CUPS



1. Place the Nutri Ninja Blade Assembly on the cup and rotate it clockwise until it is tightly sealed.

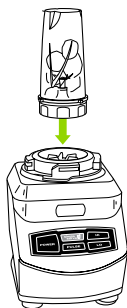

2. Turn cup upside down and set it onto the base.

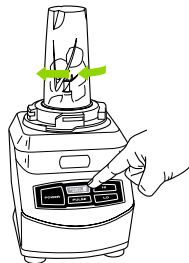

3. Rotate cup clockwise to lock in place.



WARNING: Handle the Nutri Ninja Blade Assembly with care, as the blades are sharp.

PITCHER



1. Place pitcher on base and turn clockwise to lock in place.

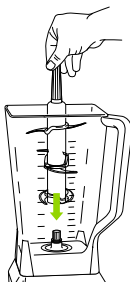

2. Holding the Stacked Blade Assembly by the top of the shaft, insert it into the pitcher.

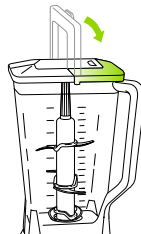

3. Align arrows on lid and handle, then lower handle to lock in place.



WARNING: Stacked Blade Assembly is sharp and not locked in place. Make sure lid is locked onto the pitcher before pouring. If pouring without lid, carefully remove Stacked Blade Assembly first. Failure to do so will result in a risk of laceration. Refer to the Ninja Owner's Guide for additional information.

QUESTIONS? We're here to help. Call **1-877-646-5288** or visit ninjakitchen.com

Please make sure to read the enclosed Ninja® Owner's Guide prior to using your unit.

NINJA®

PROFESSIONAL BLENDER AND NUTRI NINJA® CUPS

QUICK TIPS

NUTRI NINJA® CUPS

Best for: Personal-sized smoothies, greens, and seeds



Start by pulsing the Single Serve button 3 or 4 times to break down tough ingredients. Then blend to desired consistency.

PITCHER

Best for: Large batches of milkshakes and frozen drinks



Start by pulsing 3 or 4 times to break down tough ingredients. Then blend to desired consistency.



WARNING: Stacked Blade Assembly is sharp and not locked in place. Make sure lid is locked onto the pitcher before pouring. If pouring without lid, carefully remove Stacked Blade Assembly first. Failure to do so will result in a risk of laceration. Refer to the Ninja Owner's Guide for additional information.

CLEANING

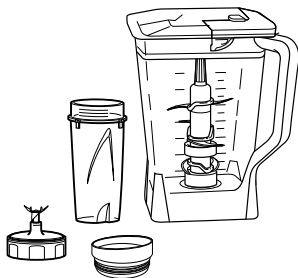

Dishwasher: The containers, lids, and blade assemblies are all dishwasher safe. The lids and blade assemblies are top-rack dishwasher safe. Ensure the blade assemblies are removed from the containers before placing in the dishwasher.

Hand washing: Wash containers, lids, and blade assemblies in warm, soapy water. When washing the blade assemblies, use a dishwashing utensil with a handle to avoid direct hand contact with blades. Handle blade assemblies with care to avoid contact with sharp edges. Rinse and air-dry thoroughly.



WARNING: Handle the blade assemblies with care when washing, as the blades are sharp. Contact with the blades' edges can result in laceration.

QUESTIONS? We're here to help. Call **1-877-646-5288** or visit **ninjakitchen.com**