

# NINJA®

## BL685

Series

OWNER'S GUIDE

## PROFESSIONAL KITCHEN SYSTEM



# THANK YOU

for purchasing the Ninja® Professional Blender



## REGISTER YOUR PURCHASE

 [registeryourninja.com](http://registeryourninja.com)

 Scan QR code using mobile device

## RECORD THIS INFORMATION

Model Number: \_\_\_\_\_

Serial Number: \_\_\_\_\_

Date of Purchase: \_\_\_\_\_  
(Keep receipt)

Store of Purchase: \_\_\_\_\_

## TECHNICAL SPECIFICATIONS

Voltage: 120V~, 60Hz

Power: 1200 Watts

Pitcher Capacity: 72 oz. (9 cups, 2.15 L)

MAX Liquid

Capacity: 64 oz. (8 cups, 1.9 L)

Bowl Capacity: 64 oz. (8 cups, 1.8 L)

Nutri Ninja® Cup

Capacity: 18 oz. (2 1/4 cups, 530 ml)

24 oz. (3 cups, 710 ml)

**PLEASE READ CAREFULLY AND  
KEEP FOR FUTURE REFERENCE.**



# CONTENTS

|  |           |
|--|-----------|
| <b>Important Safety Instructions</b> ..... | <b>4</b>  |
| <b>Parts</b> .....                         | <b>8</b>  |
| <b>Features</b> .....                      | <b>9</b>  |
| <b>Before First Use</b> .....              | <b>9</b>  |
| <b>Using the Blender Pitcher</b> .....     | <b>10</b> |
| <b>Using the Nutri Ninja® Cup</b> .....    | <b>12</b> |
| <b>Using the Processor Bowl</b> .....      | <b>14</b> |
| <b>Speed Settings &amp; Uses</b> .....     | <b>16</b> |
| <b>Care &amp; Maintenance</b> .....        | <b>17</b> |
| Cleaning.....                              | 17        |
| Storing.....                               | 17        |
| Resetting the Motor Thermostat.....        | 17        |
| Ordering Replacement Parts.....            | 17        |
| <b>Troubleshooting Guide</b> .....         | <b>18</b> |
| <b>Warranty</b> .....                      | <b>19</b> |

**TIP:** You can find the model and serial numbers on the QR code label on the back of the unit by the power cord.

# IMPORTANT SAFETY INSTRUCTIONS

PLEASE READ CAREFULLY BEFORE USE • FOR HOUSEHOLD USE ONLY

|   |   |
|---|---|
|                                       | <b>Read and review instructions for operation and use.</b>  |
|                                       | <b>Indicates the presence of a hazard that can cause personal injury, death or substantial property damage if the warning included with this symbol is ignored.</b> |
|                                       | <b>For indoor and household use only.</b>   |
| <b>When using electrical appliances, basic safety precautions should always be followed, including the following:</b> |   |

## WARNING

**To reduce the risk of injury, fire, electrical shock or property damage, basic safety precautions must always be followed, including the following numbered warnings and subsequent instructions. Do not use appliance for other than intended use.**

- 1 Read all instructions prior to using the appliance and its accessories.
- 2 Carefully observe and follow all warnings and instructions. This unit contains electrical connections and moving parts that potentially present risk to the user.
- 3 Take your time and exercise care during unpacking and appliance setup. This appliance contains sharp, loose blades that can cause injury if mishandled.
- 4 Take inventory of all contents to ensure you have all parts needed to properly and safely operate your appliance.
- 5 Blades are sharp. Handle carefully.
- 6 This product is provided with a Stacked Blade Assembly and a Chopping Blade Assembly. **ALWAYS** exercise care when handling blade assemblies. The blade assemblies are sharp and are **NOT** locked in place in their containers. The blade assemblies are designed to be removable to facilitate cleaning and replacement if needed. **ONLY** grasp the blade assembly by the top of the shaft. Failure to use care when handling the blade assemblies will result in a risk of laceration.
- 7 **ALWAYS** exercise care when handling the Nutri Ninja® Blade Assembly. The blades are sharp. **ONLY** grasp the Nutri Ninja Blade Assembly by the outer perimeter of the blade assembly base. Failure to use care when handling the blade assembly will result in a risk of laceration.
- 8 Turn the appliance **OFF**, then unplug the appliance from the outlet when not in use, before assembling or disassembling parts, and before cleaning. To unplug, grasp the plug by the body and pull from the outlet. **NEVER** unplug by grasping and pulling the flexible cord.
- 9 Before use, wash all parts that may contact food. Follow washing instructions covered in this instruction manual.
- 10 Before each use, inspect blade assemblies for damage. If a blade is bent or damage is suspected, contact SharkNinja to arrange for replacement.
- 11 **DO NOT** use this appliance outdoors. It is designed for indoor household use only.
- 12 This appliance has a polarized plug (one prong is wider than the other). To reduce the risk of electric shock, this plug will fit in a polarized outlet only one way. If the plug does not fit fully in the outlet, reverse the plug. If it still does not fit, contact a qualified electrician. **DO NOT** modify the plug in any way.
- 13 **DO NOT** operate any appliance with a damaged cord or plug, or after the appliance malfunctions or is dropped or damaged in any manner. This appliance has no user-serviceable parts. If damaged, contact SharkNinja for servicing.
- 14 This appliance has important markings on the plug blade. The entire supply cord is not suitable for replacement. If damaged, please contact SharkNinja for service.
- 15 Extension cords should **NOT** be used with this appliance.
- 16 To protect against the risk of electric shock, **DO NOT** submerge the appliance or allow the power cord to contact any form of liquid.
- 17 **DO NOT** allow the cord to hang over the edges of tables or counters. The cord may become snagged and pull the appliance off the work surface.
- 18 **DO NOT** allow the unit or the cord to contact hot surfaces, including stoves and other heating appliances.
- 19 **ALWAYS** use the appliance on a dry and level surface.
- 20 **DO NOT** allow children to operate this appliance or use as a toy. Close supervision is necessary when any appliance is used near children.
- 21 This appliance is **NOT** intended to be used by people with reduced physical, sensory, or mental capabilities, or lack of experience and knowledge, unless they have been given supervision or instruction concerning use of the appliance by a person responsible for their safety.

## SAVE THESE INSTRUCTIONS

# IMPORTANT SAFETY INSTRUCTIONS

PLEASE READ CAREFULLY BEFORE USE • FOR HOUSEHOLD USE ONLY

## ⚠ WARNING

To reduce the risk of injury, fire, electrical shock or property damage, basic safety precautions must always be followed, including the following numbered warnings and subsequent instructions. Do not use appliance for other than intended use.

- 22 ONLY** use attachments and accessories that are provided with the product or are recommended by SharkNinja. The use of attachments, including canning jars, not recommended or sold by SharkNinja may cause fire, electric shock, or injury.
- 23 NEVER** place a blade assembly on the motor base without it first being attached to its corresponding container (pitcher or cup) with the lid also in place.
- 24** Keep hands, hair, and clothing out of the container when loading and operating.
- 25** During operation and handling of the appliance, avoid contact with moving parts.
- 26 DO NOT** fill containers past the **MAX FILL** or **MAX LIQUID** lines.
- 27 DO NOT** operate the appliance with an empty container.
- 28 DO NOT** microwave any containers or accessories provided with the appliance.
- 29 NEVER** leave the appliance unattended while in use.
- 30 DO NOT** blend hot liquids. Doing so may result in pressure buildup and steam exposure that can pose a risk of the user being burned.
- 31 DO NOT** process dry ingredients with the Single-Serve Blending Cup and Nutri Ninja® Blade Assembly, the pitcher and Stacked Blade Assembly, or the processor bowl and Chopping Blade Assembly.
- 32** To reduce the risk of injury, never place Chopping Blade Assembly or discs on base without first putting bowl properly in place.
- 33 DO NOT** perform grinding operations with the Single-Serve Blending Cup and Nutri Ninja Blade Assembly, the pitcher and Stacked Blade Assembly, or the processor bowl and Chopping Blade Assembly.
- 34 NEVER** operate the appliance without lids and caps in place. **DO NOT** attempt to defeat the interlock mechanism. Ensure the container and lid are properly installed before operation.
- 35** Before operation, ensure all utensils are removed from containers. Failure to remove utensils can cause containers to shatter and potentially result in personal injury and property damage.
- 36** Keep hands and utensils out of containers while chopping to reduce the risk of severe personal injury or damage to the blender/food chopper. A scraper may be used **ONLY** when the blender or processor is not running. When using the processor, always use food pusher to add food. **NEVER** add food by hand.
- 37** If you find unmixed ingredients sticking to the sides of the cup, stop the appliance, remove the blade assembly, and use a scraper to dislodge ingredients.
- 38 DO NOT** open the pitcher's pour spout cap while blender is operating.
- 39** If you find unmixed ingredients sticking to the sides of the pitcher, stop the appliance, remove the lid, and use a spatula to dislodge ingredients. **NEVER** insert your hands into the pitcher, as you may contact one of the blades and experience a laceration.
- 40 DO NOT** attempt to remove the container or lid from the motor base while the blade assembly is still spinning. Allow the appliance to come to a complete stop before removing lids and containers.
- 41** If the appliance overheats, a thermal switch will activate and temporarily disable the motor. To reset, unplug the appliance and allow it to cool for approximately 30 minutes before using again.
- 42 DO NOT** expose the containers and accessories to extreme temperature changes. They may experience damage.
- 43** Upon completion of processing, ensure the blade assembly is removed **BEFORE** emptying container's contents. Remove the blade assembly by carefully grasping the top of the shaft and lifting it from the container. Failure to remove the blade assembly before emptying the container results in a risk of laceration.
- 44** If using the pitcher's pour spout, hold the cover in place on the container or ensure lid lock is engaged when pouring to avoid risk of injury.
- 45** Remove the Nutri Ninja® Blade Assembly from the Single-Serve Cup upon completion of blending. **DO NOT** store ingredients before or after blending them in the cup with the blade assembly attached. Some foods may contain active ingredients or release gases that will expand if left in a sealed container, resulting in excessive pressure buildup that can pose a risk of injury. For ingredient storage in the cup, use only Spout Lid to cover.
- 46** The maximum wattage rating for this appliance is based on the configuration of the Nutri Ninja Blade Assembly and Single-Serve Cup. Other configurations may draw less power or current.
- 47 DO NOT** submerge the motor base or control panel in water or other liquids. **DO NOT** spray motor base or control panel with any liquid.
- 48 DO NOT** attempt to sharpen blades.
- 49** Turn off the appliance and unplug the motor base before cleaning.

## SAVE THESE INSTRUCTIONS

## PARTS

### PARTS

- A** Pitcher Lid with Locking Handle
- B** 72 oz. Blender Pitcher
- C** Motor Base
- D** Stacked Blade Assembly (pitcher)
- E** SpoutLid
- F** Pro Extractor Blades® Assembly
- G** 18 oz. Nutri Ninja Cup
- H** 24 oz. Nutri Ninja Cup
- I** Chopping Blade Assembly (processor bowl)
- J** Dough Blade Assembly (processor bowl)
- K** Food Processor Bowl Lid
- L** Food Processor Bowl

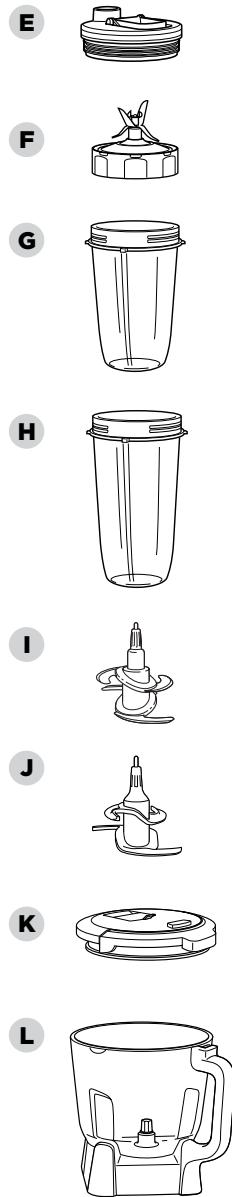
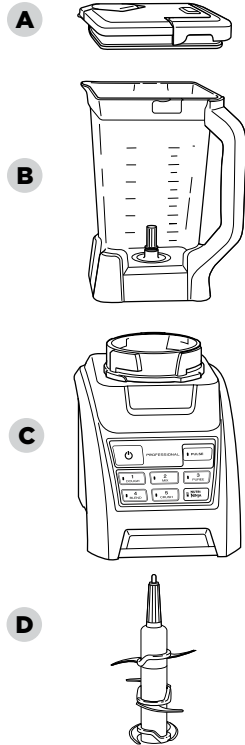

**NOTE:** Blade Assemblies are not interchangeable.

## FEATURES

- 1200 Watts
- Extra large, 72 oz. Pitcher (64 oz. Max. Liquid capacity) – BPA free
- 64 Oz. Bowl with drizzle hole – BPA free
- 18 Oz. & 24 Oz. Nutri Ninja® cups – BPA free
- 5 Speeds, pulse and nutri ninja functionality
- Sturdy, non-slip base
- Total crushing® technology
- Lock-in lid, featuring pour spout
- Easy to clean electronic control panel

**NOTE:** Number of cups and lids vary by model.

## BEFORE FIRST USE

**IMPORTANT:** Review all warnings on pages 4-7 before proceeding.

- 1** Remove all packaging material and labels from the appliance. Separate/ remove all parts from each other.
- 2** Wash the lids, pitcher, bowl, Nutri Ninja cups and Blade Assemblies in warm, soapy water. When washing the blade assemblies, use a dish-washing utensil with a handle to avoid direct hand contact with blades.
- 3** Handle blade assemblies with care to avoid contact with sharp edges. Rinse and air dry thoroughly.
- 4** The pitcher, bowl, Nutri Ninja cups, lids and Blade Assemblies are all dishwasher safe. It is recommended that the lids and blade assemblies be placed on the top rack. Ensure that the blade assemblies are removed from the containers before placing in the dishwasher.
- 5** Wipe the motor base clean with a damp cloth.

# USING THE BLENDER PITCHER

**IMPORTANT:** Review all warnings on pages 4–7 before proceeding.

**IMPORTANT:** As a safety feature, the power button (⏻) will flash and the motor will not work if the pitcher and lid are not installed correctly. When the pitcher and lid are installed properly, the power button (⏻) will be solid, indicating that the appliance is ready for use.

- 1 Place the motor base on a clean, dry, level surface such as a counter or table top.

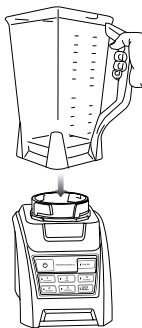

- 2 Align and lower the pitcher onto the motor base. Handle should be aligned slightly to the right of the LOCK symbol on the motor base.

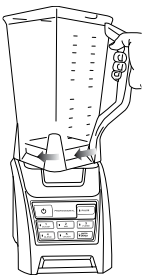

- 3 Rotate the pitcher clockwise until it locks in place. You will hear a click when the lock is engaged.

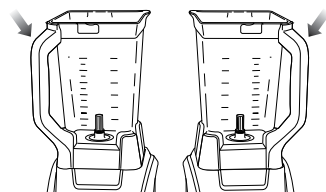

- 4 The pitcher can be placed on the motor base two ways; the handle can be on the front right corner or the front left corner.

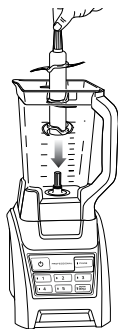

- 5 Holding the Stacked Blade Assembly by the top of the shaft, place it onto the drive gear inside the pitcher. Ensure that the Stacked Blade Assembly is seated properly and is standing upright.

**NOTE:** The Stacked Blade Assembly will fit loosely on the drive gear.

- 6 Add the ingredients to the pitcher, making sure that they do not exceed the highest measured marking line on the side of the pitcher.

**NOTE:** When blending any kind of liquids, such as mixtures of any drinks or smoothies, do not exceed the “Max liquid” mark (64 ounces) on the pitcher.

**NOTE:** If you need to add additional ingredients while the appliance is processing, open the pour spout cap and pour the ingredients in through the opening.

- 7 Plug the power cord into the electrical outlet and press the power button (⏻).

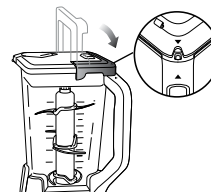

- 8 Holding the lid by the handle in the upright position, place it on top of the pitcher aligning the arrow (▼) located on the lid with the arrow (▲) located on the pitcher's handle. Press the handle down until you hear a click. The triangles on the lid and the pitcher handle **MUST** be aligned in order for the blender to turn on.

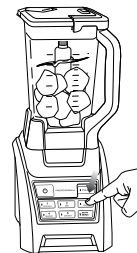

- 9 Select the speed that best suits your needs.

**NOTE:** Pulse ingredients for even chopping by pressing down in short intervals.

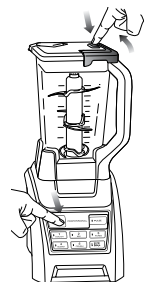

- 10 When you have reached your desired consistency, stop the appliance by pressing the power button (⏻) and wait for the stacked blade assembly to stop turning.

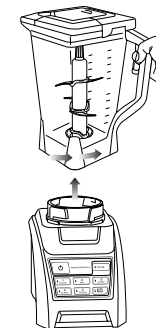

- 11 To remove the lid, press the release button on the lid, pull the lid handle up to a 90° angle and lift the lid off. Turn the pitcher counter clockwise and then lift off the base.

- 12 Open the pour spout cap and use the spout to empty liquid contents.

- 13 For thicker consistencies, remove the lid and stacked blade assembly carefully (by its shaft), then empty contents from the container. To remove the lid, press the release button on the lid and pull the lid handle up to a 90° angle and lift the lid off the pitcher. Then, carefully remove the Stacked Blade Assembly by the top of the shaft. Place Stacked Blade Assembly away from the work area to avoid accidental contact. Finally, empty contents from the pitcher.

- 14 Make sure that the unit is unplugged when not in use.



- 15 To release the motor base from the counter or table top, place your hands underneath both sides of the motor base and gently pull the unit up and towards you.

## USING THE NUTRI NINJA® CUP

**IMPORTANT:** Review all warnings on pages 4-7 before proceeding.

- 1 Place the motor base on a clean, dry, level surface such as a counter or table top.
- 2 Add ingredients to the Nutri Ninja cup.

**NOTE: DO NOT** overfill. To avoid spilling, do not add ingredients past the Max fill line.



- 3 Place the Pro Extractor Blades® Assembly onto the cup and tightly screw it on clockwise until you have a good seal.

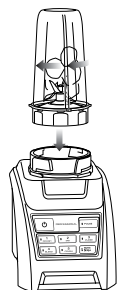

- 4 Turn the Nutri Ninja cup upside down and place it onto the motor base, aligning the tabs on the cup with the motor base. Rotate the Nutri Ninja cup clockwise until it is locked in place, you will hear a click when the lock is engaged. Turn the power button on, the Nutri Ninja button and Pulse will illuminate.



- 5 Press down on the Pulse button in short intervals to break down tough ingredients. Press the Nutri Ninja button to activate the 30 second continuous run. The unit will stop after 30 seconds.

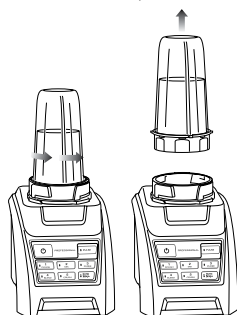

- 6 Once you have reached your desired consistency, turn the power button off and wait for the Pro Extractor Blades Assembly to stop turning. Turn the Nutri Ninja cup counterclockwise and pull straight up to remove.
- 7 Turn the cup upright and remove the Pro Extractor Blades Assembly by twisting the blade assembly counterclockwise.



- 8 Turn the cup upright and remove the Pro Extractor Blades Assembly by twisting counter clockwise.
- 9 Do not store blended contents with the Pro Extractor Blade Assembly attached.
- 10 Place the spout lid onto the Nutri Ninja cup, twist to seal and enjoy.

- 11 For storage, only use the spout lid to cover.
- 12 Be sure to store the Pro Extractor Blades Assembly attached to an empty cup when not in use.
- 13 Make sure that the motor base is unplugged when not in use.
- 14 To release the motor base from the counter or table top, place your hands underneath both sides of the motor base and gently pull the unit up and towards you.

**NOTE:** To order additional Nutri Ninja® Cups, please visit our website: [ninjakitchen.com](http://ninjakitchen.com) or feel free to contact customer service: **1-877-646-5288**.

# USING THE PROCESSOR BOWL

**IMPORTANT:** Review all warnings on pages 4-7 before proceeding.

**IMPORTANT:** As a safety feature, the power button (⏻) will flash and the motor will not work if the bowl and lid are not installed correctly. When the bowl and lid are installed properly, the power button (⏻) will be solid, indicating that the appliance is ready for use.

**NOTE:** The Chopping and Dough Blade Assemblies will fit loosely on the drive gear.

**NOTE:** Please follow the same instructions to install the Dough Blade Assembly.

- 1 Place the motor base on a clean, dry, level surface such as a counter or table top.

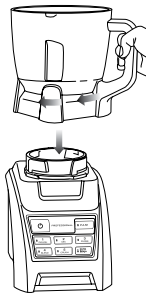

- 2 Align and lower the Bowl onto the motor base. Handle should be aligned slightly to the right of the LOCK symbol on the motor base.



- 3 Rotate the bowl clockwise until you hear a click, you will hear a click when the lock is engaged.

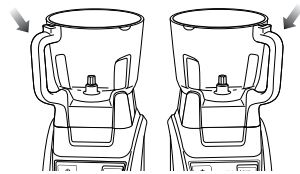

- 4 The bowl can be placed on the motor base two ways; the handle can be on the front right corner or the front left corner.



- 5 Holding the desired blade assembly by the top of the shaft, place it onto the drive gear inside the bowl. Ensure that the blade assembly is seated properly and is standing upright.

**NOTE:** The blade assembly will fit loosely on the drive gear.

- 6 Add the ingredients to the bowl, making sure that they do not exceed the highest measured marking line on the side of the bowl.

**NOTE:** The food processor bowl is not intended for blending drinks. **DO NOT** overfill.



- 7 Holding the lid by the handle in the upright position, place it on top of the bowl aligning the arrow (▼) located on the lid with the arrow (▲) located on the bowl's handle. Press the handle down until you hear a click.

**NOTE:** To add liquids during blending, open the drizzle hole on the top of the lid and pour the liquid slowly into the mixture.

- 8 Plug the power cord into the electrical outlet and press the power button (⏻).

**NOTE: DO NOT** exceed the highest measured marking line on the side of the bowl. For meats do not exceed 34 oz bowl mark.

- 9 Select the speed that best suits your needs. Pulse ingredients evenly by pressing down in short intervals.

**NOTE:** Please refer to “Speed Settings & Uses” chart for suggested uses and speeds.

- 10 When you have reached your desired consistency, stop the appliance by pressing the power button (⏻) and wait for the blade to stop turning.

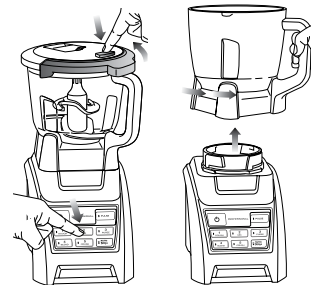

- 11 To remove the lid, pull the lid handle up to a 90° angle and lift the lid off. Turn the bowl counterclockwise and then lift off the base.



- 12 To release the motor base from the counter or table top, place your hands underneath both sides of the motor base and gently pull the unit up and towards you.



## SPEED SETTINGS & USES

| FUNCTION                 | CONTAINER        | ATTACHMENT                     | SPEED BUTTON     | TYPE OF FOOD  |
|--------------------------|------------------|--------------------------------|------------------|---|
| Small Batch Blending     | Nutri Ninja® Cup | Pro Extractor Blades® Assembly | NUTRI NINJA®     | Ultra Smooth Nutrient Extractions*/Smoothies<br>Ultra Smooth Purees<br>Sauces**<br>Ultra Smooth Soups** |
| Small Batch Chopping     | Nutri Ninja Cup  | Pro Extractor Blades Assembly  | PULSE            | Chopped Nuts  |
| Small Batch Processing   | Nutri Ninja Cup  | Pro Extractor Blades Assembly  | PULSE, held down | Crushed Ice<br>Ice to Snow<br>Grated Hard Cheese  |
| Dough Making             | Food Processor   | Dough Blade Assembly           | 1 DOUGH          | Bread Dough<br>Pie Dough<br>Pizza Dough<br>Pretzel Dough<br>Cookie Dough<br>Pasta Dough                 |
| Batters                  | Food Processor   | Chopping Blade Assembly        | 2 MIX            | Cakes<br>Muffins<br>Pancake Batter<br>Cheesecake<br>Brownies  |
| Dressings and Sauces     | Food Processor   | Chopping Blade Assembly        | 3 PUREE          | Vinaigrettes<br>Aiolis<br>Sauces**<br>Marinades   |
| Purees and Dips          | Food Processor   | Chopping Blade Assembly        | 4 BLEND          | Pestos<br>Hummus<br>Vegetable Purees<br>Fruit Purees<br>Cream Cheese Dips                               |
| Chopping                 | Food Processor   | Chopping Blade Assembly        | PULSE            | Vegetables<br>Chopped Salads<br>Chutneys<br>Burgers<br>Sausage Patties<br>Meatballs<br>Meatloaf         |
| Eggs                     | Pitcher          | Stacked Blade Assembly         | 2 MIX            | Omelets<br>Scrambled Eggs<br>Stratas<br>Frittatas   |
| Nut Butters              | Pitcher          | Stacked Blade Assembly         | 3 PUREE          | Almond Butter<br>Peanut Butter  |
| Soups and Sauces**       | Pitcher          | Stacked Blade Assembly         | 4 BLEND          | Tomato Soup**<br>Tomato Sauce**<br>Root Vegetable Soup**  |
| Large Batch Drink Making | Pitcher          | Stacked Blade Assembly         | 5 CRUSH          | Frozen Cocktail<br>Milkshakes<br>Frappes<br>Smoothies   |

\* Extract a nutritious drink containing vitamin and nutrients from fruits and veggies.

\*\* When blending soups or sauces, make sure they're cooled to room temperature first. Ninja containers are not intended for hot blending

## CARE & MAINTENANCE

### CLEANING

Separate all parts. Wash all containers in warm, soapy water with a soft cloth.

#### • Hand-Washing

Wash the containers, lids and blade assemblies in warm, soapy water. When washing the blade assemblies, use a dish-washing utensil with a handle to avoid direct hand contact with blades. Handle blade assemblies with care to avoid contact with sharp edges. Rinse and air dry thoroughly.

#### • Dishwasher

The containers, lids, blade assemblies and attachments are all dishwasher safe. The lids and blade assemblies are top rack dishwasher safe. Ensure the blade assembly is removed from the container before placing in the dishwasher.

#### • Motor Base

Turn off the unit and unplug the motor base before cleaning. Wipe motor base with a clean, damp cloth.

### NUTRI NINJA® PRO EXTRACTOR BLADES® ASSEMBLY

When washing the Pro Extractor Blades Assembly, do not attempt to remove the seal. Removing the seal can cause damage to the seal which can result in improper reassembly and leaking.

If the blade seal becomes loose or if any servicing needs to be performed on the appliance, please call customer service at 1-877-646-5288.

### STORING

Store the Ninja® Professional Kitchen System upright with the blade assembly inside the corresponding container with the lid secured on top. Do not place anything on top. Store the rest of the attachments in a safe place where they will not be damaged and won't cause harm. Loosely wrap the power cord around the cord wrap on the back of the motor base.

### RESETTING THE MOTOR

The Ninja Professional Kitchen System features a unique safety system which prevents damage to the unit's motor and drive system should you inadvertently overload your appliance. **If the appliance is being overloaded, the motor will stop. Allow the appliance to cool for approximately 15 minutes.** To reset the appliance, follow the resetting procedure below:

- 1 Unplug the appliance from the electrical outlet.
- 2 Remove and empty the container and ensure that no food is jamming the blade assembly.
- 3 Allow the appliance to cool for approximately 15 minutes.
- 4 Re-install the container onto the base and re-plug the appliance into the electrical outlet.
- 5 Proceed to use the appliance as before making sure not to exceed the recommended maximum capacities.

### ORDERING REPLACEMENT PARTS

To order additional parts and attachments, visit [ninjaccessories.com](http://ninjaccessories.com).

## TROUBLESHOOTING GUIDE

**⚠ WARNING: To reduce the risk of shock and unintended operation, turn power off and unplug unit before troubleshooting.**

### **Motor Doesn't Start or Blade Assembly Doesn't Rotate.**

- Make sure the container is securely locked on the motor base.
- Make sure the lid is securely on the container in the correct position (align arrows).
- The appliance is turned "Off". Press the power button (⏻) to turn blender "On".
- Check that the plug is securely inserted into the electrical outlet.
- Check the fuse or circuit breaker.
- The unit has overheated or overloaded. Unplug and wait approximately 15 minutes before using again.
- Check to make sure the unit is not overloaded.

### **Food is Unevenly Chopped.**

- Either you are chopping too much food at one time, or the pieces are not of even size and processing smaller amounts per batch.

### **Food is Chopped Too Fine or is Too Watery.**

- The food has been over processed. Use pulse button for controlled processing.

### **Food Collects On Lid or On the Sides of the Container.**

- The mixture is too thick. Add more liquid.

### **You Cannot Achieve Snow From Solid Ice.**

- **DO NOT** use ice that has been sitting out or has started to melt. Use ice straight from the freezer.
- Start with a few pulses and then go to a continuous blending cycle.

### **Motor Base Won't Stick to Counter or Table Top.**

- Make sure surface and suction feet are wiped clean. Suction feet will only stick to smooth surfaces. Suction feet **WILL NOT** stick on some surfaces such as, wood, tile and non-polished finishes.
- **DO NOT** attempt to use appliance when the motor base is stuck to a surface that is not secure, (cutting board, platter, plates, etc.).

### **Leaking is occurring when using the Nutri Ninja® cup.**

- Ensure the blade is properly twisted into the cup and sealed tightly into place. Check to see that the lid gasket is properly in place.
- Do not overfill the cup. Never add ingredients past the Max fill line.

### **Ingredients are stuck and not fully blending.**

- You may have overloaded the Nutri Ninja cup. Try pulsing 3-5 times and then resume blending. You may also add liquid to make blending easier.

### **The Nutri Ninja button does not work.**

- The Nutri Ninja button will only operate when you have the Nutri Ninja cup assembled to the motor base. This function was designed specifically for the Nutri Ninja Cups to operate at the ideal speed. This function is programmed to shut off after 30 seconds.

# Shark | NINJA

## ONE (1) YEAR LIMITED WARRANTY

The One (1) Year Limited Warranty applies to purchases made from authorized retailers of **SharkNinja Operating LLC**. Warranty coverage applies to the original owner and to the original product only and is not transferable.

SharkNinja warrants that the unit shall be free from defects in material and workmanship for a period of one (1) year from the date of purchase when it is used under normal household conditions and maintained according to the requirements outlined in the Owner's Guide, subject to the following conditions and exclusions:

### **What is covered by this warranty?**

1. The original unit and/or non-wearable parts deemed defective, in SharkNinja's sole discretion, will be repaired or replaced up to one (1) year from the original purchase date.
2. In the event a replacement unit is issued, the warranty coverage ends six (6) months following the receipt date of the replacement unit or the remainder of the existing warranty, whichever is later. SharkNinja reserves the right to replace the unit with one of equal or greater value.

### **What is not covered by this warranty?**

1. Normal wear and tear of wearable parts (such as blending vessels, lids, blades, blender bases, etc.), which require regular maintenance and/or replacement to ensure the proper functioning of your unit, are not covered by this warranty. Replacement parts are available for purchase at [ninjaccessories.com](http://ninjaccessories.com).
2. Any unit that has been tampered with or used for commercial purposes
3. Damage caused by misuse, abuse, negligent handling, failure to perform required maintenance (e.g., failure to keep the well of the motor base clear of food spills and other debris), or damage due to mishandling in transit.
4. Consequential and incidental damages.
5. Defects caused by repair persons not authorized by SharkNinja. These defects include damages caused in the process of shipping, altering, or repairing the SharkNinja product (or any of its parts) when the repair is performed by a repair person not authorized by SharkNinja.
6. Products purchased, used, or operated outside North America.

### **How to get service**

If your appliance fails to operate properly while in use under normal household conditions within the warranty period, visit [ninjakitchen.com/support](http://ninjakitchen.com/support) for product care and maintenance self-help. Our Customer Service Specialists are also available at **1-877-646-5288** to assist with product support and warranty service options, including the possibility of upgrading to our VIP warranty service options for select product categories. So we may better assist you, please register your product online at [registryourninja.com](http://registryourninja.com) and have the product on hand when you call.

SharkNinja will cover the cost for the customer to send in the unit to us for repair or replacement. A fee of \$20.95 (subject to change) will be charged when SharkNinja ships the repaired or replacement unit.

### **How to initiate a warranty claim**

You must call **1-877-646-5288** to initiate a warranty claim. You will need the receipt as proof of purchase. We also ask that you register your product online at [registryourninja.com](http://registryourninja.com) and have the product on hand when you call, so we may better assist you. A Customer Service Specialist will provide you with return and packing instruction information.

### **How state law applies**

This warranty gives you specific legal rights, and you also may have other rights that vary from state to state. Some states do not permit the exclusion or limitation of incidental or consequential damages, so the above may not apply to you.

**SharkNinja Operating LLC**  
**US: Needham, MA 02494**  
**CAN: Ville St-Laurent, QC H4S 1A7**  
**1-877-646-5288**  
**ninjakitchen.com**

Illustrations may differ from actual product. We are constantly striving to improve our products, therefore the specifications contained herein are subject to change without notice.

NINJA, NUTRI NINJA, PRO EXTRACTOR BLADES, and TOTAL CRUSHING are registered trademarks of SharkNinja Operating LLC.

This product may be covered by one or more U.S. patents. See [sharkninja.com/patents](http://sharkninja.com/patents) for more information.

© 2021 SharkNinja Operating LLC

PRINTED IN CHINA

BL685Series\_IB\_REV\_Mv3



**@ninjakitchen**