

NINJA

HOT & COLD BREW

SYSTEM™

CP301

Series

OWNER'S GUIDE



THANK YOU

for purchasing the Ninja® Hot & Cold Brew System™



REGISTER YOUR PURCHASE

- registeryourninja.com
- 1-877-646-5288
- Scan QR code using mobile device

RECORD THIS INFORMATION

Model Number: _____
Serial Number: _____
Date of Purchase: _____
(Keep receipt)
Store of Purchase: _____

THIS BOOK COVERS MODEL NUMBER:

CP301, CP301A, CP301BRN

TECHNICAL SPECIFICATIONS

Voltage: 120V, 60Hz
Power: 1550 Watts
Water Reservoir
Capacity: 50 Ounces

PLEASE READ CAREFULLY AND KEEP FOR FUTURE REFERENCE.

These instructions are designed to help you get a complete understanding of your new Ninja Hot & Cold Brew System™.

If you have any questions, please call our Customer Service line at 1-877-646-5288.

CONTENTS

Important Safeguards	2
Parts	4
Using the Control Panel	6
Function Buttons	6
Operating Buttons	6
Before First Use	7
Setting the Clock	7
Priming Your Ninja Hot & Cold Brew System	8
High-Altitude Calibration	9
Preparing & Using the Ninja Hot & Cold Brew System	10
How Much do You Get in Your Cup?	10
Approximate Brew Volumes	10
Coffee Measurement Chart	10
Tea Measurement Chart	11
Filling the Coffee Brew Basket	11
Filling the Tea Brew Basket	12
Automatic Drip Stop	12
Intelligent Warming Plate	13
Brewing	14
Custom Brews:	14
Classic & Rich	14
Over Ice & Cold Brew	15
Signature Brew:	16
Specialty	16
Setting the Delay Brew	16
Frothing Milk	17
Care & Maintenance	18
Cleaning After a Brew	18
Cleaning Your Water Reservoir	18
Cleaning Your Carafe	18
Cleaning & Descaling Your Brewing System	18
Troubleshooting Guide	20
Replacement Parts	22
Product Registration	23
Warranty	24

IMPORTANT SAFEGUARDS

READ ALL INSTRUCTIONS BEFORE USE • HOUSEHOLD USE ONLY

Read all instructions before using your
NINJA HOT & COLD BREW SYSTEM™

When using electrical appliances, basic safety precautions should always be followed, including the following:

⚠ WARNING

To reduce the risk of fire, electric shock, serious injury, death, or damage when using this appliance, follow these basic safety precautions.

General Precautions

- 1 This appliance can be used by children aged from 8 years and above and persons with reduced physical, sensory or mental capabilities or lack of experience and knowledge if they have been given supervision or instruction concerning use of the appliance in a safe way and understand the hazards involved.
- 2 To reduce the risk of electric shock, this appliance has a polarized plug (one blade is wider than the other). As a safety feature, this plug will fit into a polarized outlet only one way. If the plug does not fit fully into the outlet, reverse the plug. If it still does not fit, contact a qualified electrician. **DO NOT** force into outlet or try to modify to fit.
- 3 Keep the appliance and its cord out of reach of children less than 8 years.
- 4 To eliminate a choking hazard for young children, remove and discard the protective cover fitted on the power plug of this appliance.
- 5 Children shall not play with the appliance.
- 6 To protect against fire, electric shock, and injury to persons, **DO NOT** immerse cord, plugs, or body of machine in water or other liquid.
- 7 **NEVER** carry the appliance by the power cord or pull it to disconnect from electrical socket; instead grasp the plug and pull to disconnect.

- 8 **DO NOT** operate any appliance with a damaged cord or plug, or after the appliance malfunctions, or has been dropped or damaged in any manner. Contact SharkNinja Operating LLC for service.
- 9 For household and work top use only. **DO NOT** let the power cord hang over the edge, or touch hot surfaces such as the stove.
- 10 **NEVER** use socket below counter.
- 11 To avoid risk of fire, electrical shock, or damage to the unit, **DO NOT** store or use unit in an appliance garage or under a wall cabinet.
- 12 Unplug from outlet when not in use and before cleaning.
- 13 Turn off and allow to cool before putting on or taking off parts, and before cleaning the appliance.

Operating Notice

- 14 The use of an accessory not recommended by the manufacturer may create an overflow condition and scalding hazard, or result in fire, electric shock, or personal injury.
- 15 **ALWAYS** use appliance on a clean, dry, level surface.
- 16 **DO NOT** place on or near a hot gas or electric burner or in a heated oven.
- 17 **DO NOT** use this appliance for anything other than its intended use. **DO NOT** use outdoors.
- 18 **DO NOT** touch hot surfaces. Use handles or knobs.
- 19 To avoid contact with steam and hot surfaces, **DO NOT** reach across top of brewer to froth.

20 ALWAYS place a vessel beneath the brew basket to receive the brewed coffee or tea.

21 Scalding may occur if brew basket is opened during a brew or clean cycle.

22 DO NOT remove the vessel while the appliance is running without the Drip Stop in the closed position. Return the vessel quickly and open the Drip Stop to continue the brew.

23 DO NOT fill water reservoir with anything other than water, as other liquids may damage your brewer.

24 DO NOT overfill the water reservoir. Fill water only to the Max Fill line.

25 DO NOT run the appliance without water.

26 Exceeding maximum brew basket capacity may cause overflow. **DO NOT** use fine or espresso ground coffee.

Glass Carafe

27 The carafe is designed for use with this appliance only. **DO NOT** place carafe on or near a hot gas or electrical burner, or in a heated oven.

28 DO NOT set a hot carafe on a wet or cold surface.

29 DO NOT use a cracked or scratched carafe or a carafe that has a loose or weakened handle.

30 DO NOT clean carafe with abrasive cleaners, steel wool pads, or other abrasive materials.

31 DO NOT place carafe in microwave.

32 DO NOT expose carafe to extreme temperature changes.

33 DO NOT drink directly from the carafe. Liquid from the carafe may be very hot.

34 DO NOT use the carafe to store food when not in use.

35 Ensure the carafe is completely empty before starting a cleaning or brewing cycle. Starting a cycle with water, coffee, or tea in the carafe will cause an overflow.

Care & Maintenance

36 Allow the appliance to cool before removing any parts and before cleaning.

37 To prevent illness from bacterial growth in the appliance, follow all cleaning instructions in the Care & Maintenance section of this Owner's Guide.

38 Clean the system on a weekly basis.

39 If the product is not operating properly, visit ninjakitchen.com or contact SharkNinja Operating LLC for examination, repair, or adjustment.

40 Cleaning and user maintenance shall not be made by children unless they are older than 8 and supervised.

Cord Statement

41 A short power-supply cord is provided to reduce the risks resulting from becoming entangled in or tripping over a longer cord.

42 DO NOT use extension cords with this product.



Take care to avoid coming into contact with a hot surface.

READ AND SAVE THESE INSTRUCTIONS

PARTS

- A** Brewer
(power cord & storage not shown)
- B** Flip-Top Water Reservoir Lid
- C** Removable Water Reservoir
- D** Showerhead
- E** Control Panel
- F** Single-Serve Cup Platform
- G** Swinging Brew Basket
- H** Removable Tea Filter Holder
- I** Tea Permanent Filter
- J** Removable Coffee Filter Holder
- K** Coffee Permanent Filter
- L** Integrated Frother
- M** Frother Whisk
- N** Brew-Through Lid
- O** Ninja® Glass Carafe
- P** Ninja Smart Scoop™
- Q** Intelligent Warming Plate

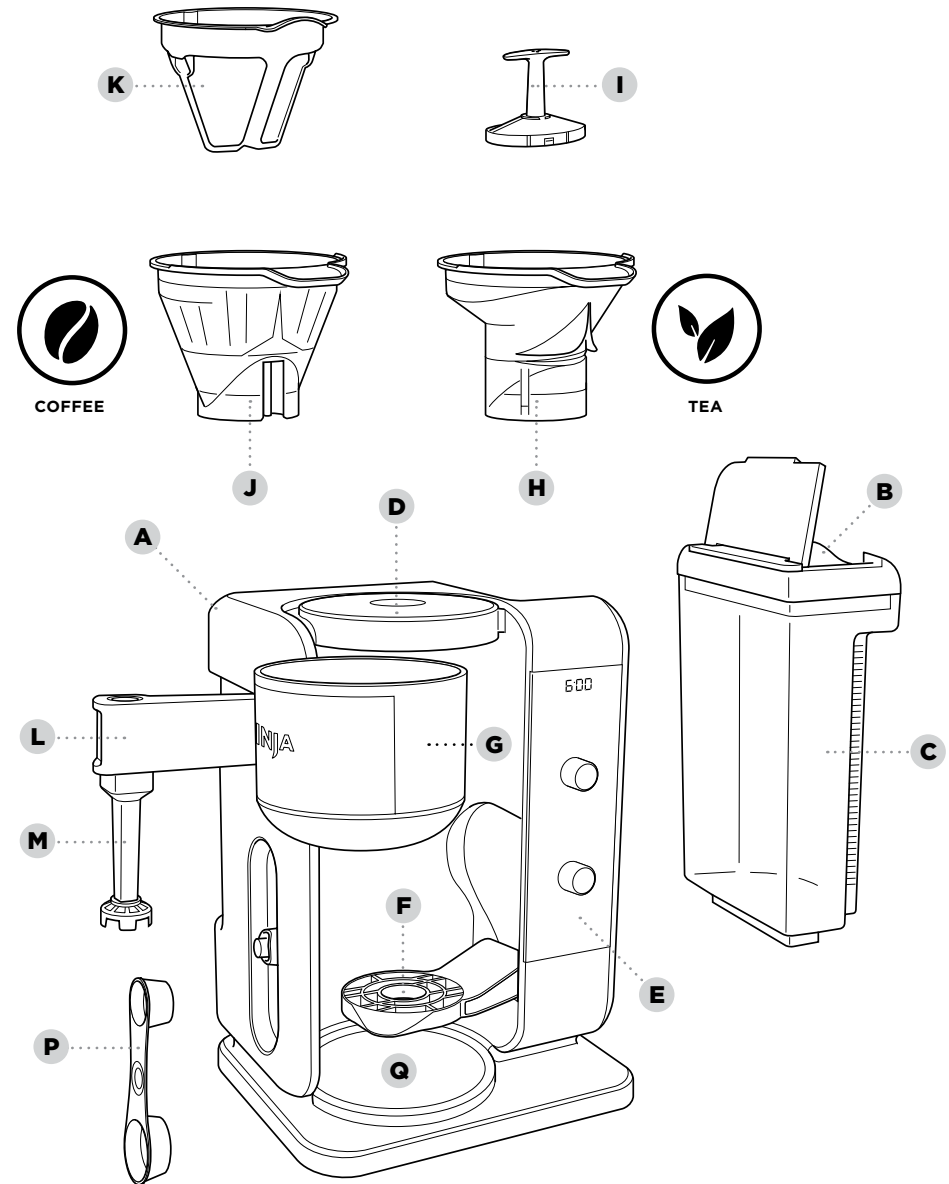
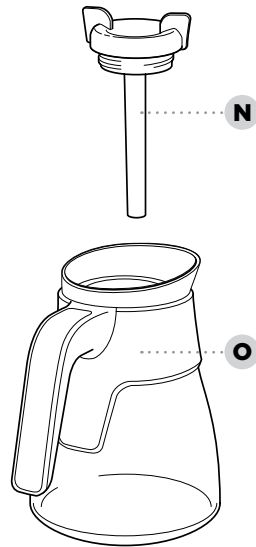

USING THE CONTROL PANEL

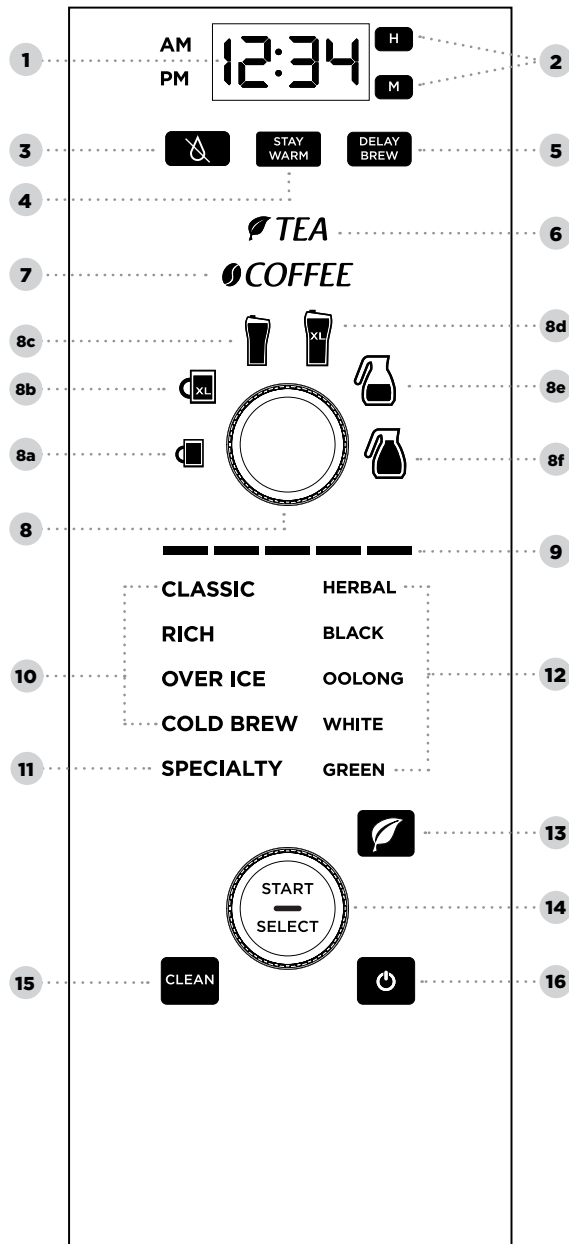

- 1 Programmable Digital Clock
- 2 Hour & Minute Buttons
- 3 Drip Stop Button
- 4 Stay Warm Button
- 5 Delay Brew Button
- 6 Tea Mode Indicator
- 7 Coffee Mode Indicator
- 8 Multi-Serve Dial
 - a Cup
 - b XL Cup
 - c Travel Mug
 - d XL Multi-Serve
 - e Half Carafe
 - f Full Carafe
- 9 Progress Bar
- 10 Custom Brew Types
 - Classic Brew
 - Rich Brew
 - Over Ice Brew
 - Cold Brew
- 11 Ninja® Signature Brew Specialty Brew
- 12 Tea Types
 - Herbal
 - Black
 - Oolong
 - White
 - Green
- 13 Tea Button
- 14 Start/Select Dial
- 15 Intelligent Clean Cycle Indicator/Button
- 16 Power Button

BEFORE FIRST USE

PLEASE KEEP THIS IMPORTANT SAFEGUARD IN MIND WHEN USING THE APPLIANCE:

IMPORTANT: DO NOT run the appliance without water.

- 1 Remove all packaging material and stickers from the brewer.
- 2 Wash the water reservoir, glass carafe, removable filter holders, and coffee and tea permanent filters in warm, soapy water with a soft cloth.
- 3 Rinse parts and dry thoroughly.
- 4 Before first use, prime the system by running a Full Carafe, Classic brew cycle with water only. After the cycle is complete, discard the water. For detailed instructions, refer to the Priming Your Ninja Hot & Cold Brewed System section.

SETTING THE CLOCK

- 1 Plug the power cord into an electrical outlet. The clock will flash on the control panel to indicate that the time has not been set.

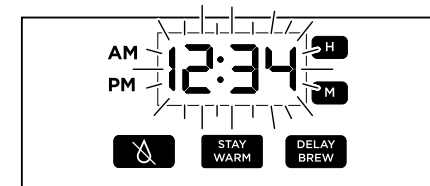

- 2 Press the hour (H) or minute (M) button until you reach the current time. The AM or PM indicator will illuminate on the left side of the display as you are setting the time.
- 3 After 5 seconds, the clock will stop flashing and the clock will be set.

NOTE: If the clock stops flashing and does not display the correct time of day, pressing the hour (H) or minute (M) button at any time will cause the clock to flash again. You can now reprogram the correct time by following the previous steps.

NOTE: If you unplug the brewer or in the event of an extended power loss, you will need to reset the clock the next time the brewer is plugged in.

PRIMING YOUR NINJA HOT & COLD BREW SYSTEM™

Clean all accessories before your first brew. Plug in unit and power it on.

- 1 To fill the water reservoir, use the hand grips to lift it to the right and up off the brewer

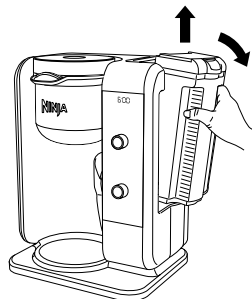

- 2 Flip the reservoir lid open or remove the entire lid, then add fresh, filtered water up to, but not exceeding, the Max Fill line

NOTE: The unit will flash the tea and coffee icons on the control panel if there is no removable filter holder in place.



- 3 Return the water reservoir to the brewer. **DO NOT** fill water reservoir with anything other than water, as other liquids may damage your brewer.

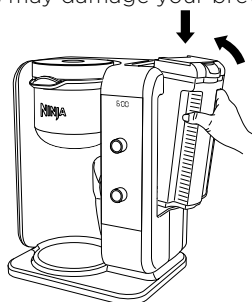

- 4 Ensure one of the removable filter holders is nested inside the brew basket

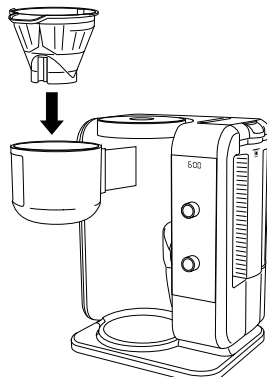

- 5 Once in place, slide the brew basket all the way in until you hear a slight click

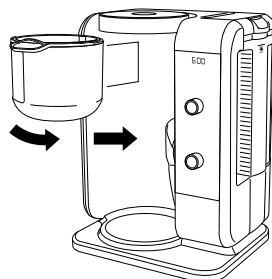

- 6 Twist the brew-through lid clockwise onto the carafe to lock into place and center the carafe below the brew basket

NOTE: Do not place any ground coffee or tea in the brew basket for the first cycle.

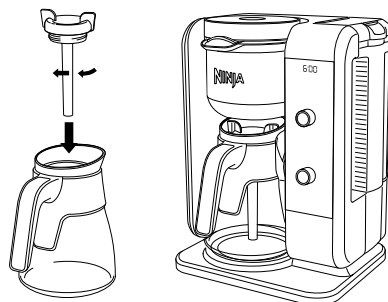

- 7 Once all parts are securely in place the Full Carafe size and Classic Brew setting, then press the START/SELECT dial.

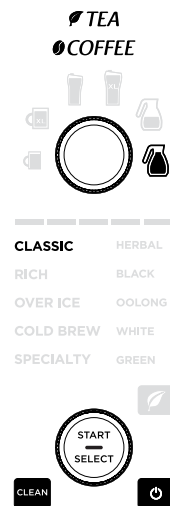

- 5 When the cycle is complete, discard the water in the carafe. You are now ready to use your Ninja Hot & Cold Brew System to brew.

HIGH-ALTITUDE CALIBRATION

Required for users in high-altitude areas. Not running the high-altitude calibration brew in a high-altitude area will result in excessive steaming during brewing.

Because water boils at lower temperatures at higher altitudes, running a calibration cycle before your first brew allows the unit to detect the boiling point of water at your location. Running a calibration cycle will help deliver a consistent brew each time.

1. Fill the water reservoir up to, but not exceeding, the Max Fill line.
2. Place an empty filter holder into the brew basket, and an empty vessel in the machine.
3. Press and hold both the Drip Stop button and the Tea button until the clock display begins a two-minute countdown.
4. A calibration cycle will begin. When complete, the unit will beep and End will appear on the clock display. Discard the water in the vessel.

NOTE: Pressing the Drip Stop button , Tea button , or Power button will cancel the calibration cycle.

NOTE: This calibration is permanently saved and will not be lost if power is lost or brewer is unplugged. Brewer can be re-calibrated at any time if the altitude where it is being used changes.

PREPARING & USING THE NINJA HOT & COLD BREW SYSTEM™

HOW MUCH DO YOU GET IN YOUR CUP?

Each size and brew type produces a different amount of coffee and tea to optimize strength and taste.

APPROXIMATE BREW VOLUMES

Size	Classic	Rich	Over Ice & Cold Brew	
			coffee/tea only	filled with ice
Cup	9.5 oz.	8.7 oz.	4.8 oz.	9.5 oz.
XL Cup	11.5 oz.	10.3 oz.	5.8 oz.	11.5 oz.
Travel Mug	14 oz.	13.2 oz.	7.0 oz.	14 oz.
XL Multi-Serve	18 oz.	16 oz.	9.0 oz.	18 oz.

You don't need to adjust the size for Specialty Brew—it always yields approximately 4 oz. of coffee and approximately 6 oz. of tea with the exception of Green Tea, which brews 2 oz..

NOTE: The coffee grounds and tea will absorb some of the water that is brewed, resulting in slightly less brewed coffee or tea than water used.

NOTE: Brew volumes may be slightly larger or smaller than what is stated due to various factors in the system.

NOTE: There may be some water left in the reservoir after your brew. This is normal to keep the brewer from running out of water.

COFFEE MEASUREMENT CHART

Serving Size	Ninja Smart Scoop™	Tablespoons
Cup/XL Cup	2-3 small scoops	2-3 Tbsp.
Travel Mug/XL Multi-Serve	3-5 small scoops	3-5 Tbsp.
Half Carafe	3-4 big scoops	6-8 Tbsp.
Full Carafe	4-6 big scoops	8-12 Tbsp.
Specialty (4 oz.)	2 big scoops	4 Tbsp.

NOTE: For Cold Brew coffee, add one extra scoop.

NOTE: Measurements are based on level scoops—adjust to your preferred taste. More scoops result in stronger coffee but slightly lower volumes; fewer scoops result in weaker coffee and slightly higher volumes. Use a medium-sized grind if grinding whole beans. Grinding beans too finely may cause the brew basket to overflow.

NOTE: Decaffeinated coffee absorbs water differently than regular coffee grounds. Use fewer scoops to prevent overflow.

TEA MEASUREMENT CHART

Serving Size	Ninja Smart Scoop™ Loose Leaf Tea	Tea Bags
Cup/XL Cup	1 small scoop	1 tea bag
Travel Mug/XL Multi-Serve	1-2 small scoops	2 tea bags
Half Carafe	2-3 small scoops	4 tea bags
Full Carafe	3-4 small scoops	6 tea bags
Specialty (6 oz.)	1 big scoop	3 tea bags

FILLING THE COFFEE BREW BASKET

For best results, use the coffee measurement chart to determine how much ground coffee to use for each brew size. The amount of ground coffee for each size will remain the same for any brew type you select. For example, if you select Cup and Classic Brew, you will use the same amount of coffee grounds as if you select Cup and Over Ice Brew. The only exception is Cold Brew, which requires one extra scoop of coffee, regardless of the size.

1 Open the brew basket by sliding it out of the brewer. Ensure you have the COFFEE filter holder in the machine, denoted by the orange handle with the coffee bean icon.

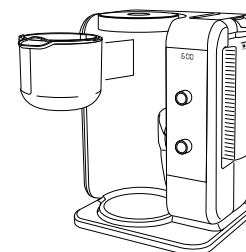

2 Place the coffee permanent filter or a #4 paper cone filter in the COFFEE filter holder. If using a paper filter, first ensure the permanent filter is removed from the filter holder. Then fold the paper filter along the seams, open it fully, and firmly press it into the filter holder making sure it is fully seated.

NOTE: Fold the paper filter along the seams, open the top fully, and firmly press it into the brew basket, making sure it is fully seated.

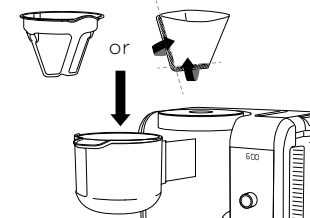

3 Use the Ninja Smart Scoop™ and follow the measurements in the chart to fill the brew basket. These measurements are based on level scoops—adjust to your preferred taste. We suggest using a medium-sized grind if grinding whole beans.

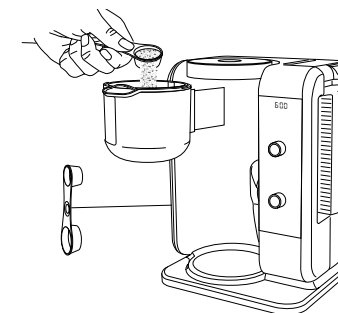

4 Slide the brew basket back into the brewer until it clicks into place.

PREPARING & USING THE NINJA HOT & COLD BREW SYSTEM™ – CONT.

FILLING THE TEA BREW BASKET

For best results, use the tea measurement chart to determine how many tea bags or how much loose leaf tea to use for each brew size. The amount of tea for each size will remain the same for any brew type you select.

- 1 Open the brew basket by sliding it out of the brewer. Ensure you have the TEA filter holder in the machine, denoted by the green handle with the tea leaf icon.

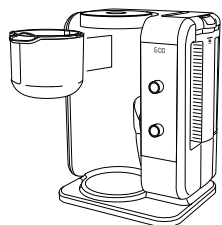

- 2 Place the tea permanent filter in the TEA filter holder. The permanent filter will make an audible click when properly inserted. When using tea bags, you may remove the tea permanent filter if more space is needed in the brew basket.

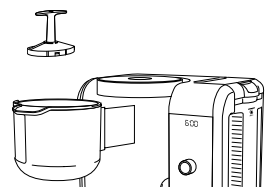

- 3 Use the Ninja Smart Scoop™ and follow the recommended measurements in the chart to fill the brew basket, adjusting to your preferred taste.

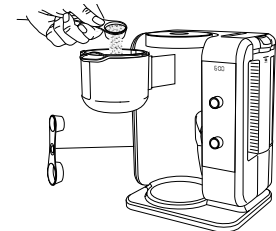

- 4 Slide the brew basket back into the brewer until it clicks into place.

AUTOMATIC DRIP STOP

The system is equipped with an automatic drip stop. When the Drip Stop button  is illuminated, the drip stop is closed and no coffee or tea will flow out of the brew basket.

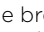
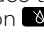
When brewing a half or full carafe, press the Drip Stop button  to pause the brew cycle and pour a cup. Promptly replace the carafe and press the Drip Stop button  again to complete the brew.

NOTE: If you forget to press the Drip Stop button  to resume the brew, the unit will pause the brew, and after 30 seconds it will give you a friendly audible reminder. After 5 minutes, the brew will be canceled.

DRIP STOP TIME SETTING

After a brew is complete, the drip stop will automatically close. Some types of coffee, such as finely ground or decaf, can take a little longer to fully drain from the brew basket. To extend the amount of time the drip stop remains open after a brew, follow these instructions:

- 1 Press and hold the Drip Stop button  until the clock display flashes either dFLt (default) or the previously specified time.



- 2 Press either the hour (H) or minute (M) button until the desired extension time is shown: dFLt (default), :15 (+15 seconds), :30 (+30 seconds), :45 (+45 seconds), :60 (+60 seconds), or OFF.

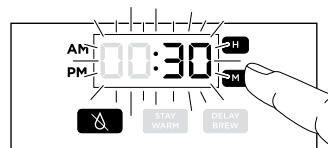

- 3 Press the Drip Stop button  to set the new time. Or wait 5 seconds, and the unit will beep, signifying that the new extension time has been set.

NOTE: The setting you choose will apply to both Coffee and Tea.

NOTE: When OFF is selected, the drip stop will remain open after a brew is complete. You can close the Drip Stop at any time by pressing the Drip Stop button  again. dFLt (default) is the machine's default time setting.

INTELLIGENT WARMING PLATE

The Intelligent Warming Plate will automatically turn on during a Half or Full Carafe size of Classic or Rich Brew. when brewing Coffee or Tea. The Intelligent Warming Plate will adjust the heat it produces to avoid burning the coffee over time.

IMPORTANT: The  indicator will illuminate when the warming plate is hot.

STAY WARM BUTTON

Press STAY WARM after the brew to turn the Intelligent Warming Plate off. You can turn the Intelligent Warming Plate back on by pressing STAY WARM again.



TIME & TEMPERATURE ADJUSTMENT

You can adjust how long the Intelligent Warming Plate remains on (up to 4 hours) and/or set the temperature to High or Low.

By default, the Intelligent Warming Plate is set to remain on for 2 hours, and is set to High to keep your coffee and tea hot. The Low setting keeps your brew at a slightly lower temperature to preserve flavor longer.

NOTE: The setting you choose will apply to both Coffee and Tea.

To change the time/temperature settings of your warming plate, follow these instructions:

- 1 Press and hold STAY WARM until the clock begins to flash the current warming time.
- 2 Quickly press the hour (H) and/or minute (M) buttons to increase the time up to 4 hours or decrease the time to 0 hours. Press STAY WARM to set the new time. Or wait 5 seconds, and the unit will beep, signifying the new time has been set.
- 3 Next, the clock will display the current warming plate temperature. To keep the same temperature, press STAY WARM, or wait 5 seconds for the same temperature to lock in. To change the temperature, press the hour (H) or (M) buttons, then press STAY WARM, or wait 5 seconds for the temperature to lock in.

NOTE: If you set the warming time to 0 hours, it will skip the warming temperature menu. When set to 0 hours, Stay Warm will not automatically activate during or after a carafe brew cycle, but you can still turn it on manually by pressing STAY WARM again.

PREPARING & USING THE NINJA HOT & COLD BREW SYSTEM™ - CONT.

BREWING

NOTE: Some brews have a pre-infusion cycle with varying times. The brewing cycle will begin, then there will be a pause for a short period before resuming. This process is used to evenly saturate the coffee grounds or tea leaves.

CUSTOM BREWS

CLASSIC BREW & RICH BREW

NOTE: Rich Brew will use slightly less water and yield slightly less brewed coffee or tea than Classic Brew.

- 1 After filling the water reservoir, place either the COFFEE or TEA filter holder into the brew basket. Add the ground coffee, loose leaf tea, or tea bags to the filter.
- 2 Close the brew basket, ensuring it is securely in place. The control panel will display either COFFEE or TEA settings based on the filter holder that has been inserted.

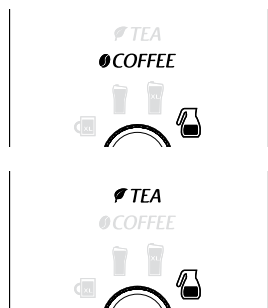

NOTE: If the brew basket is closed with no filter holder in place, both COFFEE and TEA will flash and the unit will not brew.

- 3 Use the Multi-Serve dial to select the brew size. Place the empty vessel you would like to brew into under the brew basket.

NOTE: If making a single cup, lower the Single-Serve Cup Platform and set your vessel in the center of it. Please ensure you are using at least a 12 oz. cup for the Cup size, 14 oz. cup for the XL Cup size, 16 oz. travel mug for the Travel Mug size, and 20 oz. travel mug for the XL Multi-Serve size.

- 4 Turn the START/SELECT dial to choose either Classic Brew or Rich Brew
- 5 If brewing tea, press the Tea button to toggle to the tea menu, and use the dial to choose your tea type. To change your brew style while in the tea menu, press the Tea button again.

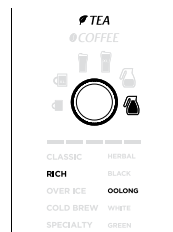

- 6 Press the START/SELECT dial to start the brew. A progress bar on the control panel will show the status of the brewing cycle. To cancel the brew at any time, press the dial again or press the Power button.
- 7 The unit will beep and the clock will display "End" when the brew is complete.

NOTE: If "CnCL" displays on the control panel, the brew has been canceled. Press the START/SELECT dial to begin the brew again.

OVER ICE BREW & COLD BREW

NOTE: Cold Brew takes about 15 minutes for a Full Carafe.

NOTE: Glassware other than the provided Ninja glass carafe may be used with the Cold Brew setting but not the Over Ice Brew setting.

- 1 After filling the water reservoir, insert either the COFFEE or TEA filter holder into the brew basket. Add the ground coffee, loose leaf tea, or tea bags to the filter.

NOTE: For COLD BREW coffee **ONLY**, add an additional scoop of coffee grounds to the brew basket.

- 2 Close the brew basket, ensuring it is securely in place. The control panel will display either COFFEE settings based on the filter holder that has been inserted.

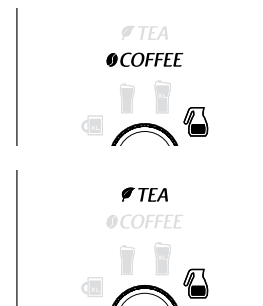

- 3 Fill your desired vessel to the top with ice cubes and place the vessel below the brew basket. Use the Multi-Serve dial to select the brew size.

NOTE: DO NOT add ice to the water reservoir.

- 4 Turn the START/SELECT dial to choose either Over Ice Brew or Cold Brew

- 5 If brewing tea, press the Tea button to toggle to the tea menu, and use the dial to choose your tea type. To change your brew style while in the tea menu, press the Tea button .

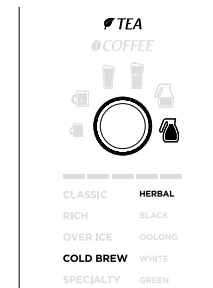

- 6 Press the START/SELECT dial to start the brew. A progress bar on the control panel will show the status of the brewing cycle. To cancel the brew at any time, press the dial again or press the Power button.
- 7 The unit will beep and the clock will display "End" when the brew is complete.

PREPARING & USING THE NINJA HOT & COLD BREW SYSTEM™ - CONT.

SIGNATURE BREW

SPECIALTY BREW

NOTE: Specialty always yields approximately 4 oz. of coffee and approximately 6 oz. of tea. Green tea yields approximately 2 oz. of tea.

- 1 After filling the water reservoir, insert either the COFFEE or TEA filter holder into the brew basket. Add the ground coffee, loose leaf tea, or tea bags to the filter.
- 2 Close the brew basket, ensuring it is securely in place. The control panel will display either COFFEE settings based on the filter holder that has been inserted.

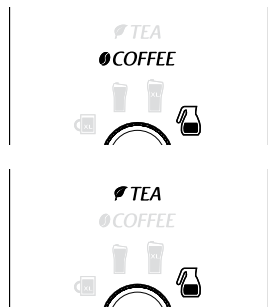

- 3 Place the empty vessel you would like to brew into under the brew basket.

NOTE: If brewing an iced blended drink, fill the desired vessel with the amount of ice recommended in the recipe before brewing.

- 4 Turn the START/SELECT dial to choose SPECIALTY

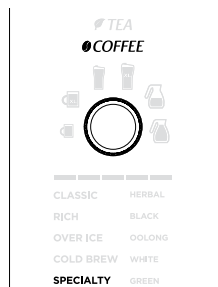

- 5 If brewing tea, press the Tea button to toggle to the tea menu, and use the dial to choose your tea type. To change your brew style while in the tea menu, press the Tea button again.
- 6 Press the START/SELECT dial to start the brew. A progress bar on the control panel will show the status of the brewing cycle. To cancel the brew at any time, press the dial again or press the Power button.

NOTE: The brewing cycle will begin, then pause for a short period before resuming. This process is used to evenly saturate the coffee grounds or tea.

- 7 The unit will beep and the clock will display "End" when the brew is complete.

NOTE: If "CnCL" displays on the control panel, the brew has been canceled. Press the START/SELECT dial to begin the brew again.

SETTING THE DELAY BREW

NOTE: The unit must remain on for the Delay Brew function to work. **DO NOT** power off after setting Delay Brew.

- 1 Plug the unit in and turn the unit on by pressing the Power button.

NOTE: The clock will remain on even if the unit is turned off. Ensure the unit is powered on to set Delay Brew.

- 2 After filling the water reservoir and adding ground coffee or tea to the correct filter holder, be sure the reservoir, brew basket, and filter are securely in place. Place the appropriate-size vessel under brew basket.

NOTE: The brew basket must be securely closed with either the COFFEE or TEA filter holder inserted to set Delay Brew.

- 3 Press DELAY BREW. DELAY BREW will illuminate and the clock will begin to flash "12:00" or the last Delay Brew time that was set.

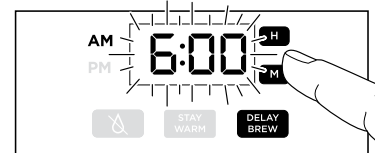

- 4 While the clock is flashing, press the hour (H) or minute (M) button to set the time that you would like the Delay Brew to begin. The AM or PM indicator will illuminate on the left side of the display as you are setting the desired time.
- 5 Once the proper time has been set, select the size of the vessel that you would like to brew into.
- 6 Turn the START/SELECT dial to choose your brew style. If brewing tea, press the Tea button to toggle to the tea menu, and use the bottom dial to choose your tea type. To change your brew style while in the tea menu, press the Tea button again.
- 7 Once the time, brew size, brew style, and tea type (if applicable) have been set, allow DELAY BREW to stop flashing, or press DELAY BREW to activate. When activated, the unit will beep and DELAY BREW and your selected options will remain illuminated. To cancel, press DELAY BREW again.

NOTE: If you attempt to change your selections while Delay Brew is set, the unit will beep and DELAY BREW will flash. To change your selections, cancel the Delay Brew.

INTEGRATED FROTHER

The Integrated Frother does not heat milk.

- 1 Add milk to your cup until it is about 1/3 full.
 - For cold froth, go to Step 2.
 - For hot froth, microwave for 45-60 seconds.

- 2 Pour milk into cup, until it is about 1/3 full. (Use more or less milk depending on your preference.) Microwave for 45 to 60 seconds for hot milk.
- 3 Swing the arm of the frother toward the front of the brewer. Install the frother whisk by twisting it to the right.
- 4 Hold the cup under the frother and submerge the whisk just below the surface of the milk. Press and hold the button on top of the frother and froth for 30-45 seconds.

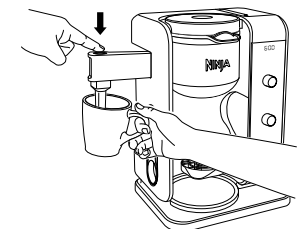
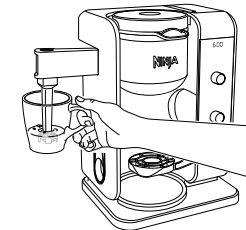

- 5 Remove the frother whisk by twisting it to the left. Keep your cup below the whisk while you carry it to your sink or dishwasher for easy cleaning.

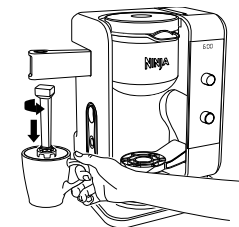

CARE & MAINTENANCE

AFTER EACH BREW

NOTE: For best results, we recommend rinsing the reservoir after brewing and refilling with fresh water for the next brew.

- 1 After the unit has cooled, remove the filter holder from the brew basket. If using a paper coffee filter, discard it. If using either the coffee or tea permanent filter, wash it thoroughly with soap and warm water or place on top rack of dishwasher.
- 2 Clean the frother whisk after each use. Hand-wash thoroughly or place on top rack of dishwasher.
- 3 Wash the carafe and brew-through lid with soap and warm water. Use a bottle brush or a cloth to wash the inside of the carafe. **DO NOT** use a wire brush.

NOTE: The glass carafe, brew-through lid, coffee and tea permanent filters, removable filter holders, water reservoir, flip-top lid, frother whisk, and scoop are dishwasher safe.

- 4 After the brewer has cooled, wipe down the main unit, showerhead, and water reservoir shelf with a cloth and warm water. **DO NOT** immerse the coffee maker in water.

CLEANING THE WATER RESERVOIR

Empty the water reservoir and hand-wash or place in your dishwasher. For a better clean, we recommend placing it on the bottom rack of the dishwasher standing upright with the opening facing downward. We recommend doing this weekly.

CLEANING THE CARAFE

We recommend cleaning your carafe with warm, soapy water. If you want to clean the carafe more thoroughly, we recommend using a soft foam brush or placing it in the dishwasher. **DO NOT** use a wire brush.

CLEANING & DESCALING YOUR BREWING SYSTEM

The CLEAN button will illuminate when a cleaning cycle is recommended for your unit, as calcium scale buildup could be affecting the flavor of your coffee or tea.

To clean and descale your Ninja Hot & Cold Brew System™:

NOTE: The clean cycle takes approximately 60 minutes.

- 1 Select the Full Carafe size and set the empty carafe beneath the brew basket.
- 2 Use a descaling solution specifically formulated for coffee maker cleaning and follow the directions on the package. Fill the water reservoir up to, but not exceeding, the Max Fill line (50 oz.).

OR

Fill the water reservoir to the Travel Mug line (16 oz.) with white vinegar, then fill the rest of the reservoir with water up to, but not exceeding, the Max Fill line.

IMPORTANT: Use only white vinegar.

- 3 Once the water reservoir is filled with your cleaning solution and water mixture, press the CLEAN button

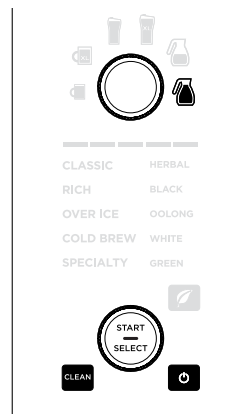

IMPORTANT: If you cancel the clean cycle, your machine will not be properly descaled.

NOTE: Running a water-only clean cycle will not descale the brewer properly.

- 4 The clock will display and count down the remaining clean cycle time, which takes approximately 60 minutes to complete. Your unit will deliver a small amount of cleaning solution to distribute it through the system. It will then pause, deliver additional cleaning solution, and continue until the cycle is complete. The extended pauses allow for maximum cleaning and descaling.

IMPORTANT: DO NOT remove the carafe at any time throughout the clean cycle.

- 5 Upon completion, the brewer will beep, the clock will display End, and the CLEAN light will turn off.
- 6 Empty the contents of the carafe and place it back under the brew basket. Clean the water reservoir with warm, soapy water to remove any cleaning solution that could affect the flavor of your coffee.
- 7 Fill the reservoir with fresh water up to, but not exceeding, the Max Fill line.

- 8 Flush the system by running a Full Carafe, Classic Brew cycle with water only. After the cycle is complete, discard the water and thoroughly clean the carafe.

NOTE: Hard water will cause scale buildup faster than soft water and the brewer will indicate it needs cleaning more often.

NOTE: If the clock ever reads "CLn" it indicates heavy scale build-up on the boiler. Run a clean cycle before attempting to brew again.

TROUBLESHOOTING GUIDE

There's sediment in my coffee or leaves in my tea.

- If using a permanent filter, the sediment at the bottom of the brewed coffee may be due to using finely ground coffee.
- To reduce the amount of sediment in the brewed coffee, use a slightly coarser grind or use a paper filter.
- Make sure the permanent tea filter is fully inserted into the filter holder. It will make an audible click when properly seated.
- Do not cut open tea bags if using to brew tea, as the leaves are finer and may pass through the filter.

NOTE: DO NOT use a paper filter in conjunction with the coffee permanent filter, as clogging and backing up of water and/or coffee in the filter basket can occur.

OVER ICE Brew and COLD BREW are not cold.

- Ensure your cup, travel mug, or carafe is filled all the way to the top with ice cubes before brewing. Your Ninja Hot & Cold Brew System™ will brew at elevated temperatures to lock in the best flavor, then the ice will cool the brewed coffee or tea to the perfect temperature.
- It is normal for some ice in the vessel to melt as the coffee is brewed.

Coffee or tea is too weak.

- **COFFEE:** For stronger coffee, use the Rich brew setting. For an even bolder flavor, you can add more coffee grounds to the brew basket.
- **TEA:** For stronger tea, use the RICH brew setting, or add more tea to the brew basket.

Coffee or tea is too strong.

- **COFFEE:** For milder coffee, use the Classic brew setting. For an even milder flavor, use fewer coffee grounds in the brew basket.
- **TEA:** For milder tea, use the CLASSIC brew setting, or use less tea in the brew basket.

Brew cycle is too slow.

- Depending on your settings, your brew time will vary from around 4 minutes to 18 minutes. The progress bar on the control panel will indicate brew status. Full carafe sizes and Rich and Cold Brew settings will take longer to brew than single-serve and Classic brews.

Cup or travel mug overflowed.

- Ensure you are using at least a 12 oz. cup for the Cup size, 14 oz. cup for the XL Cup size, 16 oz. travel mug for the Travel Mug size, and 20 oz. travel mug for the XL Multi-Serve size.

Brew basket overflowed.

- The bottom of the filter holder may be clogged. This can happen with finely ground coffee or too many coffee grinds in the brew basket. Medium-ground coffee is recommended. Refer to the Coffee Measurement Chart or Tea Measurement Chart on page 11.
- Using both the coffee permanent filter and a paper filter can cause grounds to clog and water to back up in the brew basket. Use only the permanent filter or a paper filter.
- Decaf coffee grounds absorb water differently, use fewer scoops when using decaf grounds.

TROUBLESHOOTING GUIDE - CONT.

There's water left in my reservoir.

- The water reservoir markings are minimum fill lines that indicate the amount of water needed for that brew size. However, all brew styles use different amounts of water to create the proper flavor and concentration. It is normal for water to be left in the reservoir after a brew to prevent the brewer from running out of water.

My Ninja Hot & Cold Brew System is leaking.

- After removing the water reservoir, there may be a small amount of water in the reservoir valve. This can be easily removed with a dry cloth.
- If the leak is coming from above the brew basket, refer to "Brew basket overflowed."
- If the leak is coming from the brew basket, make sure all parts are assembled correctly and securely. If the leak is coming from the bottom of the brewer, call Customer Service at 1-877-646-5288.

CLEAN light is on.

- Run a clean cycle. If you have recently completed a clean cycle, you may need to run a second cycle to remove additional mineral buildup that occurs naturally over time.

There's no Rooibos or Pu'erh tea type setting.

- Use the Herbal tea setting for Rooibos and the Black tea setting for Pu'erh.

CLOCK DISPLAY MESSAGES:

"Add Wtr"

- The system does not have enough water in the reservoir to complete your brew. Add fresh water to the reservoir and then press the START/SELECT dial to resume.
- If the reservoir is filled with water, remove and reseal the reservoir. If the issue persists, contact Customer Service at 1-877-646-5288.

"CLn"

- The system has detected that a clean cycle needs be run immediately to remove calcium scale buildup in the boiler. See 'Cleaning & Descaling Your Brewing System' for instructions.

"Hot Wtr"

- The system has detected that hot water has been added to the water reservoir. Remove the reservoir and empty the hot water. Refill the reservoir with fresh, cool water and return it to the base of the system. Wait until the display no longer shows "Hot" "Wtr" before using the system again.

"CnCL"

- A brew cycle was canceled.

"End"

- The brew cycle is complete.

ERROR MESSAGES:

"Er"

- If the clock displays "Er" and then a number (ex. "Er 03"), contact Customer Service at 1-877-646-5288.

REPLACEMENT PARTS

To order additional parts and accessories, visit ninjaaccessories.com or contact Customer Service at **1-877-646-5288**.

PRODUCT REGISTRATION

Please visit registeryourninja.com or call 1-877-646-5288 to register your new Ninja® product within ten (10) days of purchase. You will be asked to provide the store name, date of purchase, and model number along with your name and address.

The registration will enable us to contact you in the unlikely event of a product safety notification. By registering, you acknowledge you have read and understood the instructions for use and warnings set forth in the accompanying instructions.

The One (1) Year Limited Warranty applies to purchases made from authorized retailers of **SharkNinja Operating LLC**. Warranty coverage applies to the original owner and to the original product only and is not transferable.

SharkNinja warrants that the unit shall be free from defects in material and workmanship for a period of one (1) year from the date of purchase when it is used under normal household conditions and maintained according to the requirements outlined in the Owner’s Guide, subject to the following conditions and exclusions:

What is covered by this warranty?

- 1. The original unit and/or non-wearable components deemed defective, in SharkNinja’s sole discretion, will be repaired or replaced up to one (1) year from the original purchase date.
- 2. In the event a replacement unit is issued, the warranty coverage ends six (6) months following the receipt date of the replacement unit or the remainder of the existing warranty, whichever is later. SharkNinja reserves the right to replace the unit with one of equal or greater value.

What is not covered by this warranty?

- 1. Normal wear and tear of wearable parts (including filter holder, permanent filter, frother whisk, carafe and brew-through lid, water reservoir and flip-top lid, and Ninja Smart Scoop™), which require regular maintenance and/or replacement to ensure the proper functioning of your unit, are not covered by this warranty. Replacement parts are available for purchase at ninjaaccessories.com.
- 2. Any unit that has been tampered with or used for commercial purposes
- 3. Damage caused by misuse, abuse, negligent handling, failure to perform required maintenance, or damage due to mishandling in transit.
- 4. Consequential and incidental damages.
- 5. Defects caused by repair persons not authorized by SharkNinja. These defects include damages caused in the process of shipping, altering, or repairing the SharkNinja product (or any of its parts) when the repair is performed by a repair person not authorized by SharkNinja.
- 6. Products purchased, used, or operated outside North America.

How to get service

If your appliance fails to operate properly while in use under normal household conditions within the warranty period, visit ninjakitchen.com for product care and maintenance self-help. Our Customer Service Specialists are also available at 1-877-646-5288 to assist with product support and warranty service options, including the possibility of upgrading to our VIP warranty service options for select product categories.

SharkNinja will cover the cost for the customer to send in the unit to us for repair or replacement. A fee of \$20.95 (subject to change) will be charged when SharkNinja ships the repaired or replacement unit.

How to initiate a warranty claim

You must call 1-877-646-5288 to initiate a warranty claim. You will need the receipt as proof of purchase. A Customer Service Specialist will provide you with return and packing instruction information.

How state law applies

This warranty gives you specific legal rights, and you also may have other rights that vary from state to state. Some states do not permit the exclusion or limitation of incidental or consequential damages, so the above may not apply to you.



SharkNinja Operating LLC
US: Needham, MA 02494
1-877-646-5288
ninjakitchen.com

Illustrations may differ from actual product. We are constantly striving to improve our products, therefore the specifications contained herein are subject to change without notice.

NINJA is a registered trademark of SharkNinja Operating LLC.

NINJA HOT & COLD BREW SYSTEM and NINJA SMART SCOOP are trademarks of SharkNinja Operating LLC.

This product may be covered by one or more U.S. patents. See sharkninja.com/patents for more information.

© 2021 SharkNinja Operating LLC

CP301Series_IB_Mv6

PRINTED IN CHINA



@ninjakitchen