

Juicing 101

Use the freshest and ripest fruits and vegetables, and wash them prior to juicing.
Always turn on the juicer before adding ingredients to the feed chute.
Add ingredients gradually, making sure all of them have been processed/moved through the feed chute chamber before adding more.

PEEL VS. NO PEEL



REMOVE SKINS AND RINDS

from ingredients such as citrus fruits, melons, pineapples, dragon fruit, mangoes, pomegranates, beets, ginger, papaya, and root vegetable.



THE PEEL OR SKIN CAN REMAIN ON

for ingredients such as apples, pears, peaches, plums, cucumbers, and carrots.

PREP

For best results, cut ingredients into 2-inch pieces.



REMOVE STEMS

from apples (no need to remove the core or seeds). Remove stems from herbs, if desired.



REMOVE LARGE PITS AND SEEDS

from ingredients such as mangoes, plums, peaches, cherries, papayas, lemons, melons, and peppers.

REMINDER

1 lb of produce will yield approximately 8 oz. of juice.*



DO NOT PROCESS INGREDIENTS

that do not contain juice, such as bananas and avocados.



DO NOT PROCESS FROZEN

fruits and vegetables or ice.

*Yield may vary depending on produce and seasonality.

SAVE PULP FOR RECIPES



USE THE PULP

for other recipes, such as quick bread, instead of throwing it away.



REFER TO THE INSPIRATION GUIDE

for more ideas.

NINJA COLD PRESS JUICER

For questions or to register your product,
visit us online at ninjakitchen.com



@ninjakitchen

© 2022 SharkNinja Operating LLC.

NINJA is a registered trademarks of SharkNinja Operating LLC.

JC100Series_QSG_REV_Mv2

Please make sure to read the enclosed Ninja® Owner's Guide prior to using your unit.

NINJA COLD PRESS JUICER

QUICK START GUIDE

What's in the Box

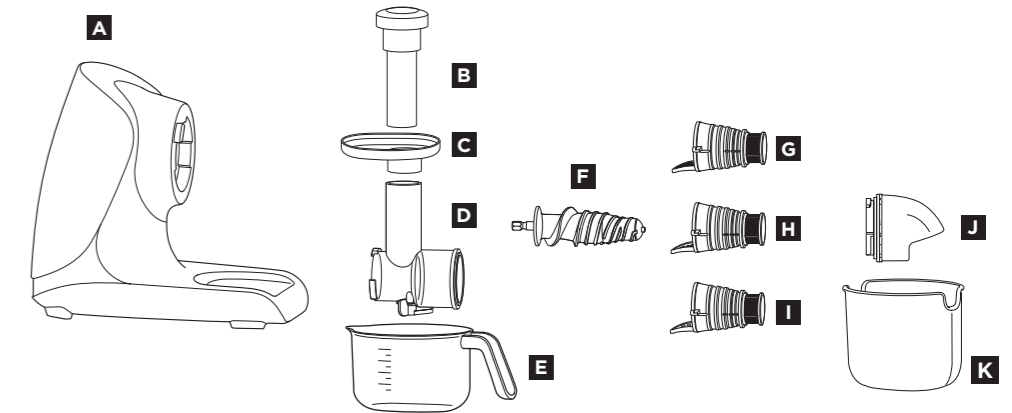

A Motor Base

B Tamper

C Food Tray

D Feed Chute Chamber

E Juice Jug

F Auger

G Black Filter
(less pulp)

H Gray Filter
(some pulp)
(not available
with all models)

I Orange Filter
(lots of pulp)

J Pulp Spout

K Pulp Container

NOTE: The feed chute chamber (D), auger (F), gray filter (H), and pulp spout (J) are pre-assembled. Before first use, disassemble and clean all parts, then follow the Assembly instructions.

Using the Control Panel

START/STOP

Press once to start continuous running up to 12 minutes; press again to stop.



REVERSE

If the feed chute chamber becomes blocked or ingredients are not processing, press and hold REVERSE. There will be a beep and a brief pause, then the auger will rotate in the opposite direction. Release REVERSE to stop. Repeat as needed. Press START/STOP to resume normal operation.

Assembly

Align the metal portion of the filter with the bottom of the auger.

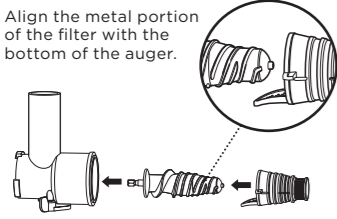

1.

Insert the auger in the feed chute chamber, then attach the desired filter onto the auger.

NOTE: See next page for choosing a filter for pulp control.

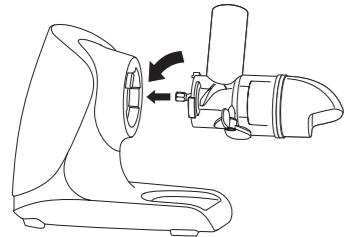

3.

Install the assembled feed chute chamber on the motor base at an angle, then turn counterclockwise until it clicks into place.

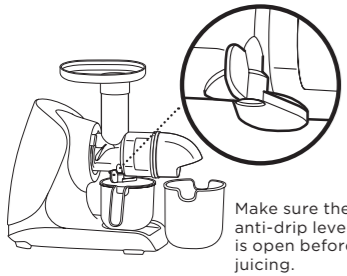

5.

Place the juice jug under the anti-drip lever on the feed chute chamber.

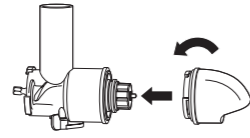

2.

Attach the pulp spout to the feed chute chamber by installing at an angle on top of the filter, then turning counterclockwise to lock in place. Ensure the word Ninja is facing up.

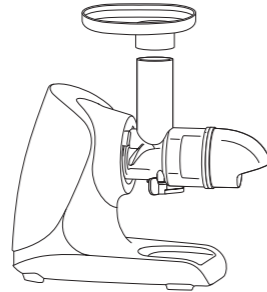

4.

Install the food tray on the top of the feed chute.

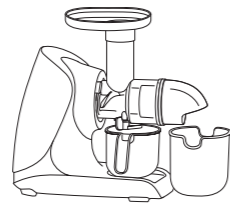

6.

Place the pulp container under the pulp spout.

Using the Filters for Pulp Control

Control the amount of pulp by choosing the desired filter.

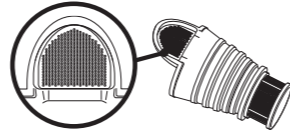

LESS PULP

Use the black filter with the finest mesh for juice with less pulp.

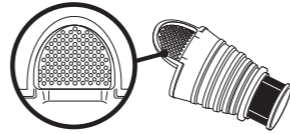

SOME PULP

Use the gray filter* with the larger mesh for juice with some pulp.

*Not available with all models

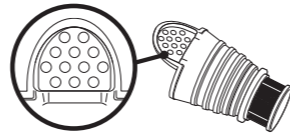

LOTS OF PULP

Use the orange filter with the largest mesh for juice with lots of pulp.

For best results, we recommend using the **Gray (Some Pulp)** or **Orange (Lots of Pulp)** filter when processing soft fibrous fruits like berries, seeded melons, and pineapple.

Depending on the seasonality of ingredients, you may experience lower juice and pulp yield when using the **Black (Less Pulp)** filter. If this occurs, try using the **Gray (Some Pulp)** filter.

Using the Juicer

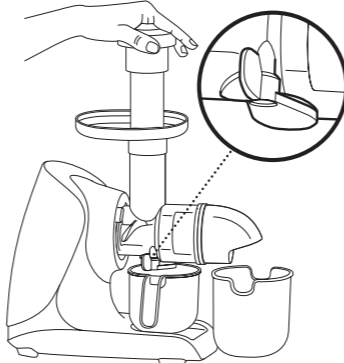

1. Make sure the anti-drip lever is open before juicing.
2. Press START/STOP, then remove the tamper and gradually add ingredients to the feed chute. For best results, allow juicer to process each ingredient before adding more. Use the tamper to push ingredients down into feed chute as needed. When done, press START/STOP to stop the unit.
3. Close the anti-drip lever so juice won't drip onto the motor base. Remove juice jug from unit, stir juice, and serve.

Disassembly

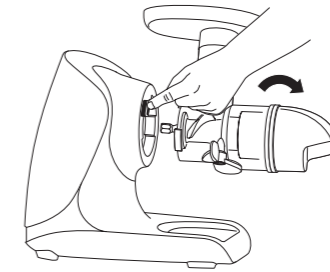

1.

Press and HOLD the RELEASE button while turning the feed chute chamber clockwise and remove from motor base.

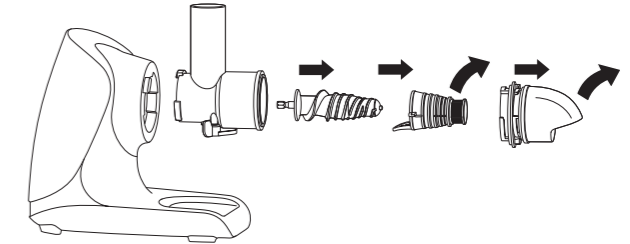

2.

Remove the pulp spout from the feed chute chamber by turning clockwise. Remove the filter and auger by gently pulling out of the feed chute.

3.

Unplug the unit when finished. If moving the unit, grab from the bottom of the base.

Cleaning

IMPORTANT: DO NOT add water to the feed chute while the unit is operating to clean the unit.



Dishwasher

All parts, except the motor base, are dishwasher safe.



Hand-Washing

Wash parts in warm, soapy water.