

# NINJA®

## Mega Kitchen System®

BL773CO  
OWNER'S GUIDE



[www.ninjakitchen.com](http://www.ninjakitchen.com)  
1-877-646-5288

# IMPORTANT SAFETY INSTRUCTIONS

## For Household Use Only

**WHEN USING ELECTRICAL APPLIANCES, BASIC SAFETY PRECAUTIONS SHOULD ALWAYS BE FOLLOWED, INCLUDING THE FOLLOWING:**

**READ ALL INSTRUCTIONS BEFORE USING YOUR NINJA® MEGA KITCHEN SYSTEM®.**

### POLARIZED PLUG

**⚠ WARNING:** To reduce the risk of electric shock, this appliance has a polarized plug (one blade is wider than the other). This plug will fit into a polarized outlet only one way. If the plug does not fit fully into the outlet, reverse the plug. If it still does not fit, contact a qualified electrician to install the proper outlet. **DO NOT modify the plug in any way.**

**⚠ WARNING:** Extension cords are not recommended for use with this product.

**THIS BOOK COVERS MODEL NUMBERS:**  
BL773C0 30

### TECHNICAL SPECIFICATIONS

Voltage:	120V., 60Hz.
Power:	1500 Watts
Pitcher Capacity:	72 oz. (9 cups, 2.15 L)
MAX Liquid Capacity:	64 oz. (8 cups, 1.9 L)
Bowl Capacity:	64 oz. (8 cups, 1.8 L)
Nutri Ninja® Cup Capacity:	16 oz. (2 cups, 470ml)

**⚠ WARNING:** TO REDUCE THE RISK OF FIRE, ELECTRIC SHOCK OR INJURY:

- ⚠ WARNING:** Remove utensils prior to processing. Failure to remove may cause the jar to be damaged or to shatter which may cause personal injury.
- ⚠ WARNING:** Stacked Blade Assembly is sharp, not locked in place and removable, handle with care. When handling the Stacked Blade Assembly, always hold it by the shaft. Failure to do so will result in a risk of laceration.
- ⚠ WARNING:** Stacked Blade Assembly is sharp and not locked in place. If using the pour spout, ensure the lid is fully locked onto the pitcher. If pouring with the lid removed, carefully remove the Stacked Blade Assembly first, holding it by the shaft. Failure to do so will result in a risk of laceration.
- ⚠ WARNING:** Chopping Blade Assembly is sharp and not locked in place. Before emptying contents carefully remove lid and Chopping Blade Assembly, holding it by the shaft. Failure to do so will result in a risk of laceration.
- ⚠ CAUTION:** Do not blend hot liquids, doing so may cause excessive pressure build-up, resulting in risk of the user being burned.
- ⚠ CAUTION:** We do not recommend grinding in any of our Nutri Ninja® cups.
- ⚠ CAUTION:** Remove the Nutri Ninja Blade Assembly from the cup upon completion of blending. Some ingredients have the potential to expand after blending resulting in excessive pressure buildup that can pose a risk of injury.

- To protect against electrical shock, do not submerge the appliance or allow the power cord to come into contact with water or any other liquid.
- DO NOT** allow the appliance to be used by children. Close attention is necessary when used near children. This is not a toy.
- Never leave an appliance unattended when in use.
- Appliance accessories are not intended to be used in the microwave as it may result in damage to the accessories.
- Turn the appliance Off and remove the power cord from the electrical outlet when not in use, before assembling or disassembling parts and before cleaning. To unplug, grasp the plug and pull from the electrical outlet. Never pull from the power cord.
- DO NOT** abuse the power cord. Never carry the appliance by the power cord or yank it to disconnect from electrical outlet; instead grasp the plug and pull to disconnect.
- DO NOT** operate any appliance with a damaged cord or plug, or after the appliance malfunctions, has been dropped or damaged in any manner. This appliance has no serviceable parts. Return the appliance to SharkNinja Operating LLC for examination, repair or adjustment.
- DO NOT** let the power cord hang over the edge of table or counter or touch hot surfaces such as the stove.
- Always use appliance on a dry, level surface.
- Keep hands, hair, clothing, as well as utensils out of container while processing to reduce the risk of severe injury to persons or damage to the appliance. A scraper may be used but only when the appliance is not running.
- Avoid contact with moving parts.
- DO NOT** attempt to sharpen blades.
- DO NOT** use the appliance if blade assemblies are bent or damaged.
- To reduce risk of injury, never place the blade assemblies on the base without the pitcher or Nutri Ninja® cup properly attached.
- DO NOT** operate this appliance on or near any hot surfaces (such as gas or electric burner or in a heated oven).
- The use of attachments or accessories including canning jars, not recommended by the manufacturer may result in fire, electric shock or personal injury.
- DO NOT** remove the container from the motor base while the appliance is in operation.
- To reduce the risk of injury, **NEVER** operate the appliance without the lid in place; **DO NOT** try to defeat the interlock mechanism; make sure that the attachment is properly installed before operating the appliance.
- DO NOT** expose containers to extreme temperature changes.
- DO NOT** overfill.
- Never feed food by hand when using the food processor. Always use the food pusher.
- DO NOT** operate the appliance empty.
- If the appliance overheats, a thermal switch will become activated and shut off the motor. To reset, unplug the appliance and let it cool down for approximately 15 minutes before using again.
- THIS PRODUCT IS INTENDED FOR HOUSEHOLD USE ONLY.** Do not use this appliance for anything other than its intended use. Do not use outdoors.
- The maximum rating is based on the Stacked Blade Assembly (pitcher) that drives the greatest power and other recommended attachments may draw significantly less power or current.

# SAVE THESE INSTRUCTIONS



## Contents

### Thank you for purchasing the Ninja® Mega Kitchen System®.

Getting to Know Your Ninja® Mega Kitchen System® .....	3
Before First Use .....	4
Assembly and Use for the Blender Pitcher .....	5
Assembly and Use for the Nutri Ninja® Cup .....	7
Assembly and Use for the 64 oz. Bowl .....	8
Assembly and Use for the Cutting Discs .....	10
Speed Setting & Uses .....	11
Care & Maintenance .....	12
Troubleshooting Guide .....	13
Replacement Parts .....	13
Warranty & Registration .....	14

## Getting To Know Your Ninja® Mega Kitchen System®



Nutri Ninja® Cup (x3)



To-Go Lid (x3)



Nutri Ninja® Blade Assembly

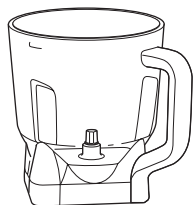

Food Processor Bowl



Dough Blade Assembly



Chopping Blade Assembly



Spindle for Discs

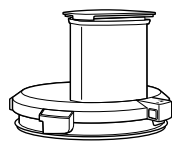

Feed Chute Lid with Two Part Pusher



Grating Disc



Reversible Slicing/Shredding Disc

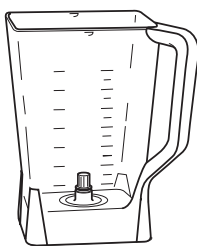

72 oz. Pitcher



Pitcher Lid



Stacked Blade Assembly (Pitcher)



Motor Base

**NOTE:** Blade assemblies are **not** interchangeable.

**NOTE:** All containers, lids, discs and blade assemblies are dishwasher safe. Place the lids, discs and blade assemblies on the top rack only. All containers, lids and plastic components of blade assemblies and disc are BPA free.

## Before First Use

### PLEASE KEEP THESE IMPORTANT SAFEGUARDS IN MIND WHEN USING THE APPLIANCE:

**IMPORTANT:** Make sure that the motor base is plugged in for use.

**IMPORTANT:** Never add ingredients into the container before placing the Blade Assembly in first.

**IMPORTANT:** Blade Assemblies are not interchangeable.

**IMPORTANT:** DO NOT attempt to operate the appliance without the lid on.

**IMPORTANT:** Never run the appliance empty.

**IMPORTANT:** Appliance accessories are not intended to be used in the microwave as it may result in damage to the accessories.

**▲ WARNING:** Stacked Blade Assembly is sharp and not locked in place. If using the pour spout, ensure the lid is fully locked onto the blender pitcher. Failure to do so will result in a risk of laceration.

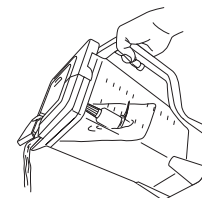

**▲ WARNING:** Stacked Blade Assembly is sharp and not locked in place. If pouring with the lid removed, carefully remove the Stacked Blade Assembly first, holding it by the shaft. Failure to do so will result in a risk of laceration.

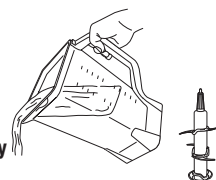

**▲ WARNING:** Chopping Blade Assembly is sharp and not locked in place. Before emptying contents carefully remove lid and Chopping Blade Assembly, holding it by the shaft. Failure to do so will result in a risk of laceration.



**▲ CAUTION:** Do not immerse the motor base into water or any other liquid.

- 1 Remove all packaging material and labels from the appliance. Separate/remove all parts from each other.
- 2 Wash the lids, pitcher, bowl, Nutri Ninja® cups, grating disc, slicing/shredding disc and blade assemblies in warm, soapy water. When washing the blade assemblies, use a dish-washing utensil with a handle to avoid direct hand contact with blades.
- ▲ WARNING:** Handle the Blade Assemblies and the grating, slicing/shredding discs with care when washing, as the blades are sharp.
- 3 Handle blade assemblies with care to avoid contact with sharp edges. Rinse and air dry thoroughly.
- 4 The pitcher, bowl, Nutri Ninja cups, lids, grating, slicing/shredding discs and Blade Assemblies are all dishwasher safe. It is recommended that the lids, grating, slicing/shredding discs and Blade Assemblies be placed on the top rack. Ensure that the Blade Assemblies and the discs are removed from the containers before placing in the dishwasher.
- 5 Wipe the motor base clean with a damp cloth.

## Assembly and Use for the Blender Pitcher

- ⚠ **WARNING:** Handle the Stacked Blade Assembly with care, as the blades are sharp.
  - ⚠ **WARNING:** Remove utensils prior to processing. Failure to remove may cause the pitcher to be damaged or to shatter, which may cause personal injury.
  - ⚠ **WARNING:** Never leave the appliance unattended while in use.
  - ⚠ **CAUTION:** Do not blend hot liquids, doing so may cause excessive pressure buildup, resulting in risk of the user being burned.
- IMPORTANT:** Make sure that the motor base is plugged in for use.

### ASSEMBLY

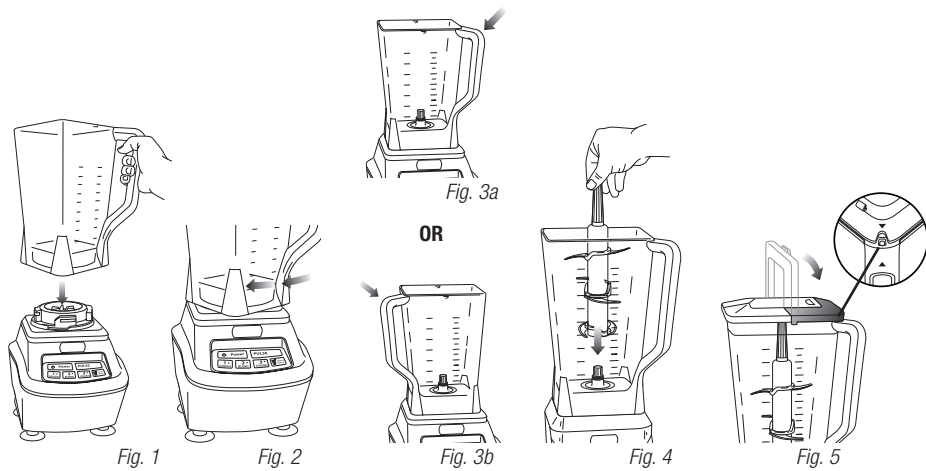

💡 It's best to add the liquid ingredients first and then the dry ingredients.

- 1 Review warning and caution statements above before proceeding to number 2.
- 2 Place the motor base on a clean, dry, level surface such as a counter or table top.
- 3 Align and lower the Pitcher onto the motor base. (Fig. 1) Handle should be aligned slightly to the right of the "LOCK" symbol on the motor base.
- 4 Rotate the blender pitcher clockwise until it clicks in place. As the pitcher rotates, it will lower and the safety tabs on the bottom of the pitcher will slide under the safety tabs on the top of the motor base. (Fig. 2)
- 5 The pitcher can be placed on the motor base two ways; the handle can be on the front right corner or the front left corner. (Fig. 3a, Fig. 3b)
- 6 Holding the Stacked Blade Assembly by the top of the shaft, place it onto the drive gear inside the pitcher. Ensure that the Stacked Blade Assembly is seated properly and is standing upright. (Fig. 4)  
**NOTE:** The Stacked Blade Assembly will fit loosely on the drive gear.
- 7 Add the ingredients to the pitcher, making sure that they do not exceed the highest measured marking line on the side of the pitcher.  
**NOTE:** If you need to add additional ingredients while the appliance is processing, open the pour spout cap and pour the ingredients in through the opening.  
**NOTE:** When blending any kind of liquids, such as mixtures of any drinks or smoothies, do not exceed the "Max liquid" mark (64 ounces) on the pitcher.
- 8 Plug the power cord into the electrical outlet and press the power button (⏻).
- 9 Holding the lid by the handle in the upright position, place it on top of the pitcher aligning the arrow (▼) located on the lid with the arrow (▲) located on the pitcher's handle. (Fig. 5) Press the handle down until you hear a click.

### USE

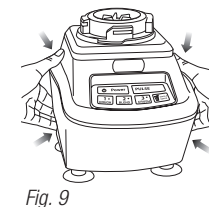
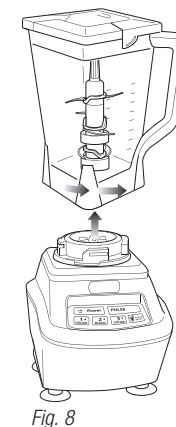
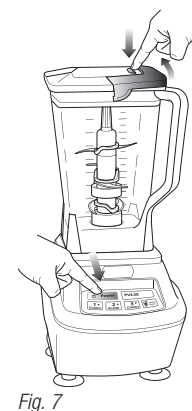
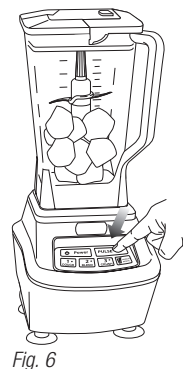

- 10 Select the speed that best suits your needs. (Fig. 6)  
**NOTE:** Pulse ingredients for even chopping by pressing down in short intervals.
  - 11 When you have reached your desired consistency, stop the appliance by pressing the power button (⏻) and wait for the blade assembly to stop turning. (Fig. 7)
  - 12 To remove the lid, press the release button on the lid, pull the lid handle up to a 90° angle and lift the lid off. Turn the pitcher counter clockwise and then lift off the base. (Fig. 7, Fig. 8)
  - 13 Open the pour spout cap and use the spout to empty liquid contents.
  - 14 For thicker consistencies, first remove the lid by pressing the release button and pulling the lid handle up to a 90 degree angle to lift lid off the pitcher. Then, carefully remove the Stacked Blade Assembly by the top of the shaft. Place Stacked Blade Assembly away from the work area to avoid accidental contact. Finally, empty contents from the pitcher.
  - 15 Make sure that the unit is unplugged when not in use.
  - 16 To release the motor base from the counter or table top, place your hands underneath both sides of the motor base and gently pull the unit up and towards you. (Fig. 9)
- ⚠ **WARNING:** Never insert your hands in the pitcher as the Stacked Blade Assembly is sharp. Always use a spatula to dislodge food that has stuck to the sides of the pitcher.

## Assembly and Use for the Nutri Ninja® Cup

- ⚠ **WARNING:** Handle the Nutri Ninja Blade Assembly with care, as the blades are sharp.
  - ⚠ **WARNING:** Remove utensils prior to processing. Failure to remove may cause the Nutri Ninja cup to be damaged or to shatter, which may cause personal injury.
  - ⚠ **WARNING:** Never leave the appliance unattended while in use.
  - ⚠ **CAUTION:** Do not blend hot liquids, doing so may cause excessive pressure buildup, resulting in risk of the user being burned.
  - ⚠ **CAUTION:** Remove the Nutri Ninja Blade Assembly from the cup upon completion of blending. Some ingredients have the potential to expand after blending resulting in excessive pressure buildup that can pose a risk of injury.
- IMPORTANT:** Make sure that the motor base is plugged in for use.

### ASSEMBLY

### USE

### REMOVAL

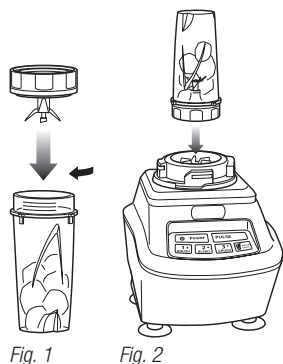

Fig. 1

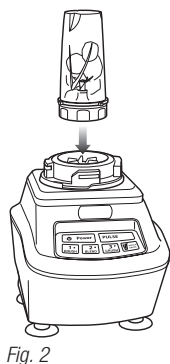

Fig. 2



Fig. 3



Fig. 4

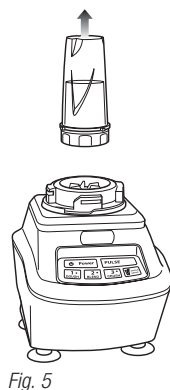

Fig. 5



For best results, use short "PULSES"... Practice makes perfect!!

- 1 Review warning and caution statements above before proceeding to number 2.
- 2 Place the motor base on a clean, dry, level surface such as a counter or table top.
- 3 Add ingredients to the Nutri Ninja® cup.
- 4 Place the Nutri Ninja Blade Assembly onto the cup and screw it tightly until you have a good seal. (Fig. 1)
- 5 Turn the Nutri Ninja® cup upside down and place it onto the motor base, aligning the tabs on the cup with the motor base. Turn the Nutri Ninja® cup clockwise to lock into place. You will hear a click when the lock is engaged. (Fig. 2) Turn the power button on, the single serve button will illuminate.
- 6 Press down on the Single Serve button in short intervals to activate. (Fig. 3)
- 7 Once you have reached your desired consistency, turn the power button off. Turn the Nutri Ninja® cup counter-clockwise and pull straight up to remove. (Fig. 4, Fig. 5)

- NOTE:** Do not overfill! To avoid spilling, do not add ingredients past the "Max" fill line.
- 8 Turn the cup upright and remove the Nutri Ninja Blade Assembly by twisting the blade assembly counter-clockwise.
  - 9 Place the To-Go drinking lid onto the Nutri Ninja® cup, twist to seal and enjoy!
  - 10 Make sure that the motor base is unplugged when not in use.
  - 11 To release the motor base from the counter or table top, place your hands underneath both sides of the motor base and gently pull the unit up and towards you. (Fig. 6)

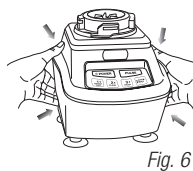

Fig. 6

**NOTE:** To order additional Nutri Ninja® Cups, please visit our website: [www.ninjakitchen.com](http://www.ninjakitchen.com) or feel free to contact customer service: 1-877-646-5288.

## Assembly and Use for the Food Processor Bowl

- ⚠ **WARNING:** Chopping Blade Assembly is sharp and not locked in place. Before emptying contents carefully remove lid and Chopping Blade Assembly, holding it by the shaft. Failure to do so will result in a risk of laceration.
  - ⚠ **WARNING:** Remove utensils prior to processing. Failure to remove may cause the bowl to be damaged or to shatter, which may cause personal injury.
  - ⚠ **WARNING:** Never leave the appliance unattended while in use.
  - ⚠ **CAUTION:** Do not blend hot liquids, doing so may cause excessive pressure buildup, resulting in risk of the user being burned.
  - ⚠ **CAUTION:** Remove the lid from the bowl upon completion of processing. Some ingredients have the potential to expand after blending resulting in excessive pressure buildup that can pose a risk of injury.
- IMPORTANT:** Make sure that the motor base is plugged in for use.

### ASSEMBLY

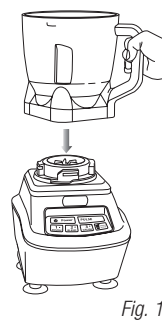

Fig. 1

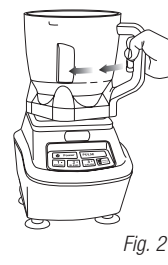

Fig. 2

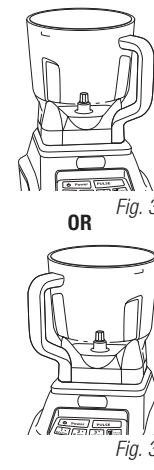

Fig. 3a

OR



Fig. 3b



Fig. 4



Fig. 5

- 1 Review warning and caution statements above before proceeding to number 2.
- 2 Place the motor base on a clean, dry, level surface such as a counter or table top.
- 3 Align and lower the Bowl onto the motor base. (Fig. 1) Handle should be aligned slightly to the right of the "LOCK" symbol on the motor base.
- 4 Rotate the bowl clockwise to lock into place. You will hear a click when the lock is engaged. (Fig. 2)
- 5 The bowl can be placed on the motor base two ways; the handle can be on the front right corner or the front left corner. (Fig. 3a, Fig. 3b)
- 6 Holding the desired Blade Assembly by the top of the shaft, place it onto the drive gear inside the bowl. Ensure that the Blade Assembly is seated properly and is standing upright. (Fig. 4)
- 7 Add the ingredients to the bowl, making sure that they do not exceed the highest measured marking line on the side of the bowl.

- 8 Holding the lid by the handle in the upright position, place it on top of the bowl aligning the arrow (▼) located on the lid with the arrow (▲) located on the bowl's handle. (Fig. 5) Press the handle down until you hear a click.

**NOTE:** The 64 oz. bowl is not intended for blending drinks. Do not overfill.

**NOTE:** To add liquids during processing, open the drizzle hole on the top of the lid and pour the liquid slowly into the mixture.



- 9 Plug the power cord into the electrical outlet and press the power button (⏻).

**IMPORTANT:** As a safety feature, the power button (⏻) will flash and the motor will not work if the bowl and lid are not installed correctly. When the bowl and lid are installed properly, the power button (⏻) will be solid, indicating that the appliance is ready for use.

## Assembly and Use for the Food Processor Bowl - cont.

### USE CHOPPING BLADE ASSEMBLY



Fig. 1

### REMOVAL

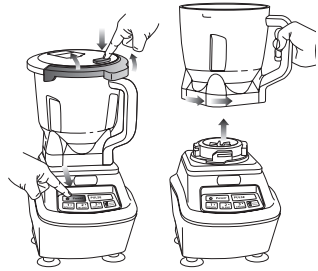

Fig. 2

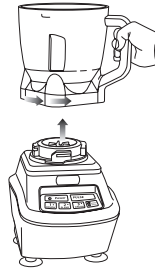

Fig. 3



Fig. 4

### USE DOUGH BLADE ASSEMBLY



Fig. 5

#### USING THE CHOPPING BLADE ASSEMBLY

- 1 Review warning and caution statements at the top of page 8 before proceeding to number 2.
- 2 Place the motor base on a clean, dry, level surface such as a counter or table top.
- 3 Secure the bowl onto the motor base.
- 4 Holding the Chopping Blade Assembly by the shaft, place it onto the gear shaft inside the bowl. Ensure that the Chopping Blade Assembly fits around the gear shaft and that it is standing straight. **(Fig. 1)**
- 5 Add the ingredients and secure the bowl lid onto the bowl. **(Fig. 1)**
- 6 Plug the power cord into the electrical outlet and press on the power button (⏻). **(Fig. 2)** Select the speed that best suits your needs. Pulse ingredients for even chopping by pressing down in short intervals.  
**NOTE:** Please refer to "Speed Settings & Uses" chart for suggested uses and speeds.
- 7 When you have reached your desired consistency, stop the appliance by pressing the power button (⏻) and wait for the Chopping Blade Assembly to stop turning.
- 8 To remove the lid, press the release button on the lid and pull the lid handle up to a 90° angle. **(Fig. 2)**
- 9 Turn the bowl counter-clockwise and lift it to remove it from the motor base. **(Fig. 3)**
- 10 To release the motor base from the counter or table top, place your hands underneath both sides of the motor base and gently pull the unit up and towards you. **(Fig. 4)**

#### USING THE DOUGH BLADE ASSEMBLY

- IMPORTANT: Use only the "DOUGH" button when using this attachment.**
- 1 Review warning and caution statements at the top of page 8 before proceeding to number 2.
  - 2 Place the motor base on a clean, dry, level surface such as a counter or table top.
  - 3 Secure the bowl onto the motor base.
  - 4 Holding the Dough Blade Assembly by the shaft, place it onto the gear shaft inside the bowl. Ensure that the Dough Blade Assembly fits around the gear shaft and that it is standing straight. **(Fig. 5)**
  - 5 Add the ingredients and secure the bowl lid onto the bowl. **(Fig. 5)**  
**NOTE:** For best results add wet ingredients first and then add dry ingredients.
  - 6 Plug the power cord into the electrical outlet and press on the power button (⏻). **(Fig. 2)**
  - 7 To remove the lid, press the release button on the lid and pull the lid handle up to a 90° angle. **(Fig. 2)**
  - 8 Turn the bowl counter-clockwise and lift it to remove it from the motor base. **(Fig. 3)**
  - 9 To release the motor base from the counter or table top, place your hands underneath both sides of the motor base and gently pull the unit up and towards you. **(Fig. 4)**

## Assembly and Use of the Cutting Discs

- ⚠ **WARNING:** The Cutting Discs are sharp. Always use the finger holes when placing or removing the cutting discs. Failure to do so will result in a risk of laceration.
  - ⚠ **WARNING:** Remove utensils prior to processing. Failure to remove may cause the bowl to be damaged or to shatter, which may cause personal injury.
  - ⚠ **WARNING:** Never leave the appliance unattended while in use.
- IMPORTANT:** Make sure that the motor base is plugged in for use.

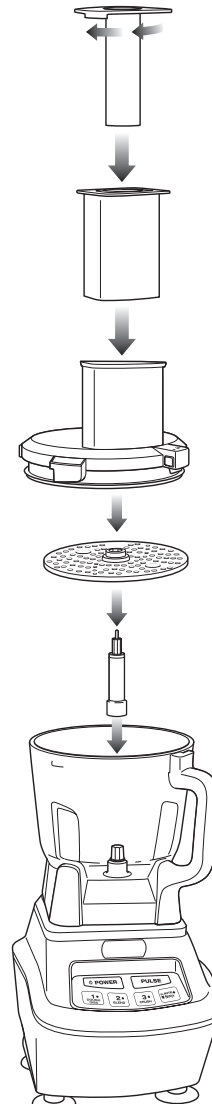

Fig. 6

**NOTE:** The feed chute lid features a two part pusher to guide food through the chute. Use the full pusher for larger items such as cucumbers. Twist and pull to remove the smaller pusher and use the narrow chute for smaller items such as carrots.

**IMPORTANT: Only use Speed 1 DOUGH/DISC when using either cutting disc attachment.**

**NOTE:** The Slicing/Shredding Disc is reversible. Use the side labeled "Slicer" for Slicing. Carefully flip the disc over to the side labeled "Shredder" for shredding.

- 1 Review warning statements at the top before proceeding to number 2.
- 2 Place the motor base on a clean, dry, level surface such as a counter or table top. **(Fig. 6)**
- 3 Secure the bowl onto the motor base.
- 4 Place the spindle inside the bowl.
- 5 Use the finger holes to grasp the selected disc and place it over the spindle.
- 6 Place the feed chute lid on the bowl and turn clockwise until you here a click indicating the lid is locked in place. **(Fig. 6)**
- 7 Plug the power cord into the electrical outlet and press the power button (⏻) to turn the unit "On".
- 8 **Select Speed 1 DOUGH/DISC on the control panel.** The disc will begin spinning.
- 9 Add the food that you want to slice, shred or grate through the feed chute on the lid. **(Fig. 6)** Use the two-part food pusher to help guide the food through the feed chute. The middle piece of the food pusher is removable to use for smaller ingredients.
- 10 When finished, stop the appliance by pressing the power button (⏻) and wait for the disc to stop turning. Press the button on the feed chute lid located near the handle to unlock and turn the lid counter-clockwise. Lift to remove from the processor bowl. Using the finger holes, carefully lift the cutting disc out of the bowl and remove the spindle.
- 11 To release the motor base from the counter or table top, lift the base up from underneath the sides of the unit. Release paddles on both sides will help to disengage the suction feet from the surface.



## Speed Setting & Uses

**TIP:** Be sure to add seeds or protein powder after you've added your liquids and before adding your ice for optimal breakdown.

FUNCTION	CONTAINER	BLADE ASSEMBLY	SPEED BUTTON	TYPE OF FOOD
Small Batch Blending	Nutri Ninja® Cup	Nutri Ninja Blade Assembly	Nutri Ninja - Hold Down	Ultra Smooth Nutrient Extractions* Smoothies/Protein Shakes Smooth Purees Sauces** Soups**
Small Batch Chopping	Nutri Ninja Cup	Nutri Ninja Blade Assembly	Nutri Ninja® - Pulse Short Intervals	Chopped Nuts
Dough Making	Bowl	Dough Blade Assembly	1	Bread Dough Pie Dough Pizza Dough Pretzel Dough Cookie Dough Pasta Dough
Batters	Bowl	Chopping Blade Assembly	2 PULSE	Cakes Muffins Pancake Batter Cheesecake Brownies
Dressings and Sauces	Bowl	Chopping Blade Assembly	2	Vinaigrettes Aiolis Marinades Sauces**
Purees and Dips	Bowl	Chopping Blade Assembly	3	Pesto Hummus Vegetable Purees Fruit Purees Cream Cheese Dips
Grating	Bowl	Grating Disc	1	Grated cheese Bread crumbs
Large Batch Chopping/ Grinding	Bowl	Chopping Blade Assembly	PULSE	Salsa Vegetables Nuts Chopped Salads Burgers Meatballs Taco Meat
Slicing/Shredding	Bowl	Slicing/Shredding Disc	1	Vegetables Cheese
Eggs	Pitcher	Stacked Blade Assembly	1	Omelets Scrambled Eggs Stratas Frittatas
Nut Butters	Pitcher	Stacked Blade Assembly	2	Almond Butter Peanut Butter
Soups and Sauces**	Pitcher	Stacked Blade Assembly	2	Tomato Soup** Tomato Sauce** Root Vegetable Soup**
Large Batch Drink Making	Pitcher	Stacked Blade Assembly	3	Smoothies/Protein Shakes Frozen Cocktails Milkshakes Frappes

\* Extract a Drink Containing Vitamins & Nutrients From Fruits & Veggies.

\*\* When blending soups or sauces, make sure they're cooled to room temperature first - Ninja® containers are not intended for hot blending.

## Care & Maintenance

### HOW TO CLEAN

**⚠ CAUTION: Make sure that the motor base is unplugged from the power source before inserting or removing any attachment and before cleaning.**

**⚠ CAUTION: DO NOT immerse the motor base into water or any other liquid.**

- 1 Separate/remove all parts from each other.
- 2 **Hand Washing:** Wash the lids, pitcher, bowl, Nutri Ninja® cup, cutting discs and blade assemblies in warm, soapy water. When washing the blade assemblies and cutting discs, use a dish-washing utensil with a handle to avoid direct hand contact with blades. Handle blade assemblies and cutting discs with care to avoid contact with sharp edges. Rinse and air dry thoroughly.

**Dishwasher:** The containers, lids, blade assemblies, cutting discs and attachments are all dishwasher safe. The lids, cutting discs and blade assemblies are top rack dishwasher safe. Ensure that the blade assemblies and cutting discs are removed from the containers before placing in the dishwasher.

**⚠ WARNING: Handle the Stacked Blade Assembly, Chopping Blade Assembly, Nutri Ninja Blade Assembly, Grating Disc and Slicing/Shredding Disc with care when washing, as the blades are sharp. Contact with the blades' edges can result in laceration.**

- 3 Wipe the motor base clean with a damp cloth.

Please call customer service if any servicing needs to be performed on the appliance at 1-877-646-5288.

### HOW TO STORE

- 1 Store the Ninja® Mega Kitchen System® upright with the blade assembly inside the corresponding container with the lid secured on top. Do not place anything on top. Store the rest of the attachments in a safe place where they will not be damaged and won't cause harm. Loosely wrap the power cord around the motor base.

### RESETTING THE MOTOR THERMOSTAT

The Ninja Mega Kitchen System features a unique safety system which prevents damage to the unit's motor and drive system should you inadvertently overload your appliance. If the appliance is being overloaded, the motor will stop. To reset the appliance, follow the resetting procedure below:

- 1 Unplug the appliance from the electrical outlet.
- 2 Remove and empty the container and ensure that no food is jamming the blade assembly.
- 3 Allow the appliance to cool for approximately 15 minutes.
- 4 Re-install the container onto the base and re-plug the appliance into the electrical outlet.
- 5 Proceed to use the appliance as before making sure not to exceed the recommended maximum capacities.

**ONE (1) YEAR LIMITED WARRANTY**

PROBLEMS	POSSIBLE REASONS & SOLUTIONS
<b>Motor doesn't start or blade assembly doesn't rotate.</b>	<p>Make sure the container is securely placed on motor base.</p> <p>Make sure the lid is securely on container in the correct position (align arrows).</p> <p>The appliance is turned "Off". Press the power button (Ⓛ) to turn "On".</p> <p>Check that the plug is securely inserted into the electrical outlet.</p> <p>Check the fuse or circuit breaker.</p> <p>The unit has overloaded or overheated. Unplug and wait approximately 15 minutes before using again.</p>
<b>Food is unevenly chopped.</b>	<p>Either you are chopping too much food at one time, or the pieces are not of an even size. Try processing smaller amounts per batch.</p>
<b>Food is chopped too fine or is too watery.</b>	<p>The food has been over processed. Use pulse button for controlled processing.</p>
<b>Food collects on lid or on the sides of the container.</b>	<p>The mixture is too thick. Add more liquid.</p>
<b>You cannot achieve snow from solid ice.</b>	<p>Do not use ice that has been sitting out or has started to melt. Use ice straight from the freezer.</p>
<b>Motor base won't stick to counter or table top.</b>	<p>Make sure surface and suction feet are wiped clean. Suction feet will only stick to smooth surfaces. Suction feet WILL NOT stick on some surfaces such as, wood, tile and non-polished finishes.</p> <p>DO NOT attempt to use appliance when the motor base is stuck to a surface that is not secure, (cutting board, platter, plates, etc.).</p>
<b>Leaking is occurring when using the Nutri Ninja® cup.</b>	<p>Ensure the blade is properly twisted into the cup and sealed tightly into place. Check to see that the lid gasket is properly in place.</p> <p>Do not overfill the cup. Never add ingredients past the "Max" fill line.</p>
<b>Ingredients are stuck and not fully blending.</b>	<p>You may have overloaded the Nutri Ninja® cup. Try pulsing 3-5 times and then resume blending. You may also add liquid to make blending easier.</p>
<b>The Nutri Ninja button does not work.</b>	<p>The Nutri Ninja button will only operate when you have the Nutri Ninja cup assembled to the motor base. This function was designed specifically for the Nutri Ninja Cups to operate at the ideal speed.</p>

**SharkNinja Operating LLC** warrants this product to be free from material defects and workmanship for a period of one (1) year from the date of purchase when utilized for normal household use, subject to the following conditions, exclusions and exceptions.

The liability of **SharkNinja Operating LLC** is limited solely to the cost of the repair or replacement of the unit at our option. This Limited Warranty does not cover normal wear of parts and does not apply to any unit that has been tampered with or used for commercial purposes. This Limited Warranty does not cover damage caused by misuse, abuse, negligent handling or damage due to faulty packaging or mishandling in transit. This Limited Warranty does not cover damage or defects caused by or resulting from damages from shipping or repairs, service or alteration to the product or any of its parts, which have been performed by a repair person not authorized by **SharkNinja Operating LLC**.

If your appliance fails to operate properly while in use under normal household conditions within the Limited Warranty period, you may return the complete appliance and accessories with proof of purchase and date, freight prepaid. For Customer Service support, call 1-877-646-5288 or visit our website [www.ninjakitchen.com](http://www.ninjakitchen.com).

If the appliance is found by **SharkNinja Operating LLC** to be defective, in **SharkNinja Operating LLC's** sole discretion, we will repair or replace it free of charge. Proof of purchase date and a check made payable to **SharkNinja Operating LLC** in the amount of \$19.95 to cover the cost of return shipping and handling must be included.\*

This Limited Warranty is extended to the original purchaser of the unit and excludes all other legal, implied and/or conventional warranties. The responsibility of **SharkNinja Operating LLC** if any, is limited to the specific obligations expressly assumed by it under the terms of this Limited Warranty. In no event is **SharkNinja Operating LLC** liable for incidental or consequential damages to anyone of any nature whatsoever. Some states do not permit the exclusion or limitation of incidental or consequential damages, so the above may not apply to you.

This Limited Warranty gives you specific legal rights, and you may also have other rights which vary from state to state or from province to province.

**\*IMPORTANT: Carefully pack item to avoid damage in shipping. Be sure to include proof of purchase date and to attach tag to item before packing with your name, complete address and phone number with a note giving purchase information, model number and what you believe is the problem with the item. We recommend you insure the package (as damage in shipping is not covered by your Limited Warranty). Mark the outside of your package "ATTENTION CUSTOMER SERVICE".**

**PRODUCT REGISTRATION**

Please visit [www.ninjakitchen.com](http://www.ninjakitchen.com) or call **1-877-646-5288** to register your new Ninja® product within ten (10) days of purchase. You will be asked to provide the store name, date of purchase and model number along with your name and address.

The registration will enable us to contact you in the unlikely event of a product safety notification. By registering you acknowledge to have read and understood the instructions for use, and warnings set forth in the accompanying instructions.

**Replacement Parts**

**ORDERING REPLACEMENT PARTS**

To order additional parts and attachments, please visit our website: [www.ninjakitchen.com](http://www.ninjakitchen.com) or feel free to contact customer service: 1-877-646-5288.





SharkNinja Operating LLC  
US: Newton, MA 02459  
CAN: Ville St-Laurent, QC H4S 1A7  
**1-877-646-5288**  
**[www.ninjakitchen.com](http://www.ninjakitchen.com)**

**Mega Kitchen System, Ninja**, and **Nutri Ninja** are registered trademarks of SharkNinja Operating LLC.

Illustrations may differ from actual product. We are constantly striving to improve our products, therefore the specifications contained herein are subject to change without notice.

For SharkNinja U.S. Patent information visit [www.sharkninja.com/USPatents](http://www.sharkninja.com/USPatents).

© 2016 SharkNinja Operating LLC  
BL773CO\_IB\_E\_160114\_4  
PRINTED IN CHINA