



EXPRESS CHOP®

NJ100 Series | Owner's Guide



IMPORTANT SAFETY INSTRUCTIONS

PLEASE READ ALL INSTRUCTIONS BEFORE USE • FOR HOUSEHOLD USE ONLY

	Read and review instructions for operation and use.
	Indicates the presence of a hazard that can cause personal injury, death or substantial property damage if the warning included with this symbol is ignored.
	For indoor and household use only.
When using electrical appliances, basic safety precautions should always be followed, including the following:	

⚠ WARNING

To reduce the risk of injury, fire, electrical shock or property damage, basic safety precautions must always be followed, including the following numbered warnings and subsequent instructions. Do not use appliance for other than intended use.

- 1** Read all instructions prior to using the appliance and its accessories.
- 2** Carefully observe and follow all warnings and instructions. This unit contains electrical connections and moving parts that potentially present risk to the user.
- 3** Take your time and exercise care during unpacking and appliance setup. This appliance contains sharp, loose blades that can cause injury if mishandled.
- 4** Take inventory of all contents to ensure you have all parts needed to properly and safely operate your appliance.
- 5** Blades are sharp. Handle carefully
- 6** Turn the appliance **OFF**, then unplug the appliance from the outlet when not in use, before assembling or disassembling parts, and before cleaning. To unplug, grasp the plug by the body and pull from the outlet. **NEVER** unplug by grasping and pulling the flexible cord.
- 7** **NEVER** unplug by grasping and pulling the flexible cord.
- 8** Before use, wash all parts that may contact food. Follow washing instructions covered in this instruction manual.
- 9** To protect against the risk of electric shock, **DO NOT** submerge the appliance or allow the power cord to contact any form of liquid.
- 10** **DO NOT** use this appliance outdoors. It is designed for indoor household use only.
- 11** **DO NOT** operate any appliance with a damaged cord or plug, or after the appliance malfunctions or is dropped or damaged in any manner. This appliance has no user-serviceable parts. If damaged, contact SharkNinja for servicing.
- 12** This appliance has a polarized plug (one prong is wider than the other). To reduce the risk of electric shock, this plug will fit in a polarized outlet only one way. If the plug does not fit fully in the outlet, reverse the plug. If it still does not fit, contact a qualified electrician. **DO NOT** modify the plug in any way.
- 13** Extension cords should **NOT** be used with this appliance.
- 14** **DO NOT** allow children to operate this appliance or use as a toy. Close supervision is necessary when any appliance is used near children.
- 15** This appliance is **NOT** intended to be used by people with reduced physical, sensory, or mental capabilities, or lack of experience and knowledge, unless they are given supervision or instruction concerning use of the appliance by a person responsible for their safety.
- 16** Before each use, inspect blade assemblies for damage. If a blade is bent or damage is suspected, contact SharkNinja to arrange for replacement.
- 17** **DO NOT** allow the unit or the cord to hang over the edges of tables or counters. The cord may become snagged and pull the appliance off the work surface.
- 18** **ALWAYS** use the appliance on a dry and level surface.
- 19** Keep hands, hair, and clothing out of the container when loading and operating.
- 20** **NEVER** leave the appliance unattended while in use.

IMPORTANT SAFETY INSTRUCTIONS

PLEASE READ ALL INSTRUCTIONS BEFORE USE • FOR HOUSEHOLD USE ONLY

- 21 **ONLY** use attachments, including canning jar, and accessories that are provided with the product or are recommended by SharkNinja. The use of attachments not recommended or sold by SharkNinja may cause fire, electric shock, or injury.
- 22 During operation and handling of the appliance, avoid contact with moving parts.
- 23 To protect against electric shock, **DO NOT** immerse cord, plug or any part of the main unit in water or any other liquids.
- 24 Check that the voltage indicated on the rating plate corresponds with that of the local network before connecting the appliance to the mains power supply.
- 25 **DO NOT** use with damaged cord or plug.
- 26 **DO NOT USE** if the appliance is not working, has been dropped, dropped into water, damaged or left outdoors.
- 27 **NO SERVICEABLE PARTS.** Incorrect re-assembly or repair can cause a risk of electrical shock or injury to persons when the appliance is used. Contact Customer Service.
- 28 This appliance contains no user-serviceable parts. All repairs should only be carried out by a qualified engineer. Improper repairs may place the user at risk of harm.
- 29 Remove the power cord from the mains power supply when not in use, before assembling or disassembling parts, and before cleaning.
- 30 **DO NOT** abuse the power cord. Never carry the appliance by the power cord. To unplug the appliance from the mains power supply, grasp the plug and not the cord and pull to disconnect.
- 31 **DO NOT** leave the appliance unattended whilst connected to the mains power supply.
- 32 **CAUTION:** To avoid risk of laceration or burns, **DO NOT PROCESS HOT FOODS OR HOT LIQUIDS.** Allow hot ingredients to cool before processing.
- 33 **DO NOT** remove the power pod before the chopping blades have stopped turning.
- 34 **CAUTION** Chopping blades are sharp, handle with care, especially when removing the blade from the bowl, emptying the bowl and during cleaning. When handling the chopping blades, always hold by the plastic shaft.
- 35 **DO NOT** attempt to sharpen blades.
- 36 **DO NOT** expose the containers and accessories to extreme temperature changes. They may experience damage.
- 37 **DO NOT** use containers if they are cracked or chipped.
- 38 **DO NOT** use the appliance if chopping blades are bent or damaged.
- 39 Keep hands and utensils out of containers while chopping to reduce the risk of severe personal injury or damage to the blender/food chopper. A scraper may be used **ONLY** when the blender or processor is not running. When using the processor, always use food pusher to add food. **NEVER** add food by hand.
- 40 Immediately release the On/Off pulse button on the power pod in the event that the appliance malfunctions during use.
- 41 To reduce the risk of injury, **NEVER** operate the appliance without the splash guard and bowl in place; **DO NOT** try to defeat the interlock mechanism; make sure that the cutting blades are properly assembled before operating the appliance.
- 42 **DO NOT** use appliance for other than intended use.
- 43 **DO NOT** operate the appliance with an empty container.
- 44 **DO NOT** fill containers past the MAX FILL or MAX LIQUID lines.
- 45 If the appliance overheats, a thermal switch will become activated and shut off the motor. To reset, unplug the appliance and let it cool down for approximately 10 minutes before using again.
- 46 Be certain cover is secured in place before operating the appliance.
- 47 **DO NOT** microwave any containers or accessories provided with the appliance.
- 48 **DO NOT** perform grinding operations with chopping blades.
- 49 **DO NOT** process dry ingredients without adding liquid to food chopper. The food chopper is not intended for dry chopping.
- 50 Friendly reminder, chopped meat cannot exceed 40 g every time, chop Parmesan cheese cannot exceed 70 g every time, dry soy bean cannot exceed 160 g every time, and chop baking chocolate cannot exceed 65 g every time. Operated time should be no more than 15 seconds.

SAVE THESE INSTRUCTIONS

GETTING TO KNOW YOUR NINJA® EXPRESS CHOP®

PARTS

- A On/Off Pulse Button
- B Power Pod
- C Splashguard/Storage Lid
- D Ninja Chopping Blade Assembly
- E Processing Bowl with Non-Slip Base
- F Spindle Pin
- G Power Cord (not shown)

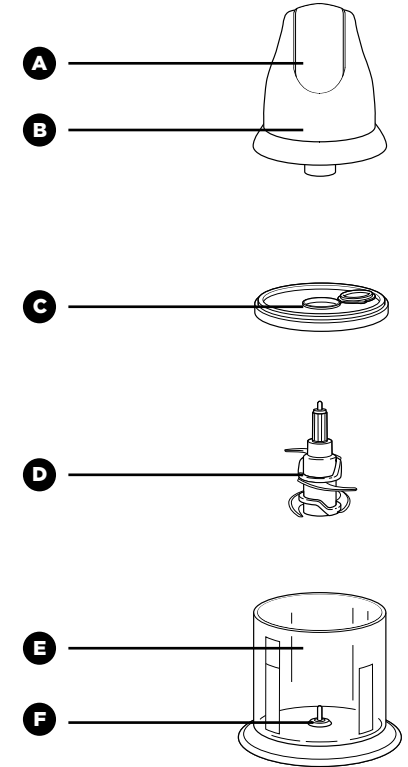

FEATURES

The Ninja Express Chop is an essential tool that is perfect for chopping and pureeing when preparing your favorite recipes. For best results, be sure to carefully read all the instructions contained in the manual before using this appliance.

- One-touch pulse for precise control
- 16 oz. Processing bowl – BPA-Free
- Ninja Chopping Blade technology
- Non-slip base
- Splashguard/storage lid
- Dishwasher-safe parts

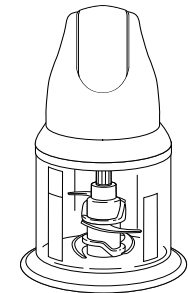

USING THE NINJA® EXPRESS CHOP®

IMPORTANT: Review all warnings before proceeding.

- 1 Place the processing bowl on a clean, dry, level surface.
- 2 Holding the Ninja Chopping Blade Assembly by the shaft, carefully place it over the spindle pin inside the processing bowl.



WARNING: DO NOT try to place the Chopping Blade Assembly onto the power pod and then into the Ninja® processing bowl.

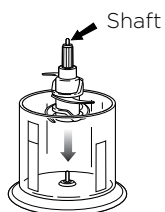

IMPORTANT: Always assemble the Chopping Blade Assembly inside the container.

- 3 Carefully spin the blade assembly counter clockwise to make sure that blade assembly has inserted properly.
- 4 Place the food ingredients into the bowl.

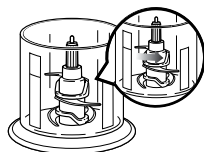

CAUTION: DO NOT add more than 2 cups dry or 1 cup liquid ingredients as this may cause overflow.

IMPORTANT: Never add ingredients into the processing bowl before placing the blade assembly in first.

- 5 Place the splashguard/storage lid on the bowl.
- 6 Open the flap on the splashguard.

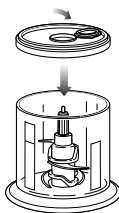

- 7 Place the power pod on top of the splashguard making sure that it is securely in place.

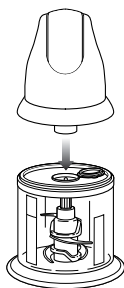

- 8 To start the appliance, plug the power cord into the electrical outlet, securely hold power pod while operating and press on the on/off pulse button located on the top of the power pod.
- 9 Hold the processing bowl firmly while depressing the on/off pulse button to ensure the unit stays in place.

NOTE: DO NOT operate the appliance continuously for more than 15 seconds at a time. Be careful not to over process. For coarsely chopped foods, use repeated short pulsing action until the desired consistency is reached.

- 10 To stop the appliance, remove your fingers from the On/Off pulse button.
- 11 In order to obtain a better quality of chopping, operate the appliance by using the “pulse” method.
- 12 Make sure that the Ninja Chopping Blade Assembly has stopped completely before removing the power pod.
- 13 If the ingredients stick to the side of the processing bowl, stop the appliance, remove the power pod and the splashguard. Use a spatula to dislodge the pieces and then replace the splashguard and the power pod. Continue processing.
- 14 Remove the Ninja Chopping Blade Assembly by its shaft before you empty the contents of the processing bowl.
- 15 Place the storage lid onto the top of the processing bowl and close the flap to store.

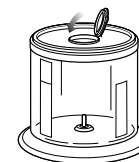
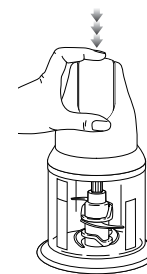

HINTS & TIPS FOR USING YOUR NINJA® EXPRESS CHOP®

- For mincing, chopping and pureeing, increase the length of pulses.
- For coarse chopping, use short, quick pulses and monitor food texture.
- Pre-cut larger pieces to make them fit into the processing bowl. When chopping hard ingredients, cut them into 1-inch cubes.

CARE & MAINTENANCE

CLEANING

Hand-Washing

Wash the container, lid, and Ninja® Chopping Blade Assembly in warm, soapy water. When washing the Ninja Chopping Blade Assembly, use a dish-washing utensil with a handle to avoid direct hand contact with blades. Handle the Ninja Chopping Blade Assembly with care to avoid contact with sharp edges. Rinse and air dry thoroughly.

Dishwasher

The container, lid, and Ninja Chopping Blade Assembly are all dishwasher safe. The lid and Ninja Chopping Blade Assembly are top rack dishwasher safe. Ensure that the Ninja Chopping Blade Assembly is removed from the container before placing in the dishwasher.

DO NOT immerse the power pod into water or any other liquid. Clean with a damp sponge or cloth and wipe dry.

If the appliance needs servicing, please call customer service at **1-877-646-5288**.

STORING

Store the Ninja® Express Chop® upright with the Ninja Chopping Blade Assembly inside the corresponding container with the splashguard/storage lid on top. Do not place anything on top. Store the rest of the attachments in a safe place where they will not be damaged and won't cause harm. Loosely wrap the power cord around the Power Pod.

TROUBLESHOOTING GUIDE

Motor Doesn't Start or Blade Assembly Doesn't Rotate.

- Check that the bottom of power pod is clean and there is no food blocking connection when placing on containers.
- There is too much food in the container.
- The unit has overheated. Unplug and wait approximately 10 minutes before using again.
- Make sure the power pod is securely placed on splashguard.
- Check that the plug is securely inserted into the electrical outlet.
- Check fuse or breaker. Replace fuse/reset breaker.

Food is Unevenly Chopped.

Either you are chopping too much food at one time, or the pieces are too big. Try cutting the food into smaller pieces of even size and processing smaller amounts per batch.

Food is Chopped Too Fine or is Too Watery.

The food has been over processed. Use brief pulses or process for shorter time. Let Ninja® Chopping Blade Assembly stop completely between pulses.

REPLACEMENT PARTS

To order additional parts and accessories, visit ninjaaccessories.com or contact Customer Service at **1-877-646-5288**. So we may better assist you, please register your product online at registryourninja.com and have the product on hand when you call.

Shark | NINJA

ONE (1) YEAR LIMITED WARRANTY

The One (1) Year Limited Warranty applies to purchases made from authorized retailers of **SharkNinja Operating LLC**. Warranty coverage applies to the original owner and to the original product only and is not transferable.

SharkNinja warrants that the unit shall be free from defects in material and workmanship for a period of one (1) year from the date of purchase when it is used under normal household conditions and maintained according to the requirements outlined in the Owner's Guide, subject to the following conditions and exclusions:

What is covered by this warranty?

1. The original unit and/or non-wearable parts deemed defective, in SharkNinja's sole discretion, will be repaired or replaced up to one (1) year from the original purchase date.
2. In the event a replacement unit is issued, the warranty coverage ends six (6) months following the receipt date of the replacement unit or the remainder of the existing warranty, whichever is later. SharkNinja reserves the right to replace the unit with one of equal or greater value.

What is not covered by this warranty?

1. Normal wear and tear of wearable parts (such as blending vessels, lids, blades, blender bases, etc.), which require regular maintenance and/or replacement to ensure the proper functioning of your unit, are not covered by this warranty. Replacement parts are available for purchase at ninjaaccessories.com.
2. Any unit that has been tampered with or used for commercial purposes.
3. Damage caused by misuse, abuse, negligent handling, failure to perform required maintenance (e.g., failure to keep the well of the motor base clear of food spills and other debris), or damage due to mishandling in transit.
4. Consequential and incidental damages.
5. Defects caused by repair persons not authorized by SharkNinja. These defects include damages caused in the process of shipping, altering, or repairing the SharkNinja product (or any of its parts) when the repair is performed by a repair person not authorized by SharkNinja.
6. Products purchased, used, or operated outside North America.

How to get service

If your appliance fails to operate properly while in use under normal household conditions within the warranty period, visit ninjakitchen.com/support for product care and maintenance self-help. Our Customer Service Specialists are also available at **1-877-646-5288** to assist with product support and warranty service options, including the possibility of upgrading to our VIP warranty service options for select product categories. So we may better assist you, please register your product online at registryourninja.com and have the product on hand when you call.

SharkNinja will cover the cost for the customer to send in the unit to us for repair or replacement. A fee of \$20.95 (subject to change) will be charged when SharkNinja ships the repaired or replacement unit.

How to initiate a warranty claim

You must call **1-877-646-5288** to initiate a warranty claim. You will need the receipt as proof of purchase. We also ask that you register your product online at registryourninja.com and have the product on hand when you call, so we may better assist you. A Customer Service Specialist will provide you with return and packing instruction information.

How state law applies

This warranty gives you specific legal rights, and you also may have other rights that vary from state to state. Some states do not permit the exclusion or limitation of incidental or consequential damages, so the above may not apply to you.



REGISTER YOUR PURCHASE



registeryourninja.com



Scan QR code using mobile device

RECORD THIS INFORMATION

Model Number: _____

Serial Number: _____

Date of Purchase: _____
(Keep receipt)

Store of Purchase: _____

TECHNICAL SPECIFICATIONS

Voltage: 120V-, 60Hz

Power: 200 Watts

Bowl

Capacity: 16 oz. (2 cups)

SharkNinja Operating LLC

US: Needham, MA 02494

1-877-646-5288

ninjakitchen.com

Illustrations may differ from actual product. We are constantly striving to improve our products, therefore the specifications contained herein are subject to change without notice.

EXPRESS CHOP and NINJA are registered trademarks of SharkNinja Operating LLC.

This product may be covered by one or more U.S. patents.
See sharkninja.com/patents for more information.

© 2022 SharkNinja Operating LLC

NJ100Series_IB_REV_MV11



@ninjakitchen