

Please make sure to read the enclosed Ninja® Owner's Guide prior to using your unit.

NINJA®

ESPRESSO & COFFEE

BARISTA SYSTEM

**QUICK
START
GUIDE**

HERE'S WHAT'S IN THE BOX

GROUND COFFEE



CAPSULES



BREW BASKET

Comes fully installed in the brewer. It must always be inserted when brewing grounds.



FROTHER WHISK

Included in the box. Must be assembled on the brewer.



PAPER FILTER KIT

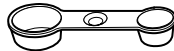

NINJA SMART SCOOP™

Use this to measure coffee grounds.



60 OZ. GLASS CARAFE

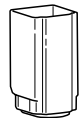

CAPSULE BIN

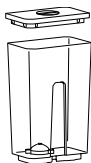

60 OZ. REMOVABLE WATER RESERVOIR

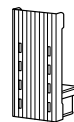

CUP TRAY BASE



ADJUSTABLE CUP TRAY

SCAN HERE

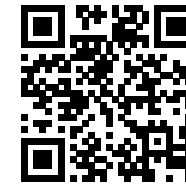

TO ACCESS OWNER'S GUIDE,
HOW-TO VIDEOS, AND MORE

BEFORE YOUR FIRST BREW

- 1 Clean all accessories before your first brew.
- 2 Plug the brewer in and turn it on by pressing the power button.
- 3 Lift the water reservoir off its base and remove the reservoir lid. Add water up to, but not exceeding, the Full line. Return the water reservoir to the brewer. **DO NOT** fill the water reservoir with anything other than water, as other liquids may damage your brewer.

NOTE: We recommend using cool or room-temperature water in the reservoir. **DO NOT** fill with hot or boiling water.



PRIMING GROUNDS

OR



PRIMING CAPSULES

- 1 Ensure the brew basket is fully installed in the unit and close the lid. Do not add coffee.
- 2 Place the carafe below the brew basket. Press the Grounds Button to select Classic, then turn the dial to select the Full Carafe size.
- 3 To start, press START BREW. When the cycle is complete, discard the water and rinse the carafe. You are now ready to brew grounds.

- 1 Ensure the lever is closed. Do not insert a capsule.
- 2 Center a vessel under the spout. Press the Capsule Button or turn the dial to select Lungo.
- 3 To start, press START BREW. When the cycle is complete, discard the water in the vessel, then rinse. Repeat this process 3 times. You are now ready to brew capsules.

BREWING GROUNDS



1 FILL WATER RESERVOIR

Fill the water reservoir up to, but not exceeding, the Full line.

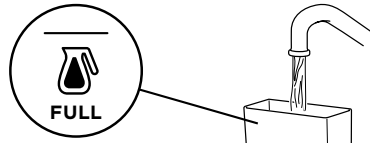

2 PREPARE FOR BREWING

SERVING SIZE NINJA SMART SCOOP

GROUND COFFEE

☕ ☕ 2-3 small scoops

☕ ☕ ☕ 3-5 small scoops

☕ ☕ ☕ ☕ 3-5 big scoops

☕ ☕ ☕ ☕ ☕ 4-7 big scoops



permanent filter sold separately

IMPORTANT: Always measure with level scoops of a medium grind size. Use fewer scoops when brewing decaf coffee. **DO NOT** use a paper filter in conjunction with a permanent filter.

3 CHOOSE A STYLE

Press the Grounds Button to select a style.

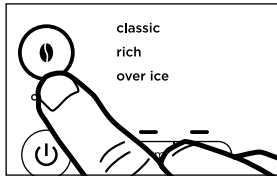

Smooth, well-balanced flavor.



Richer than classic, with more intense flavor that stands up to milk, cream, or flavoring.



Specially designed to brew hot over ice for freshly brewed iced coffee that is not watered down. **Always fill your vessel to the top with ice cubes before brewing Over Ice.**

4 CHOOSE A SIZE

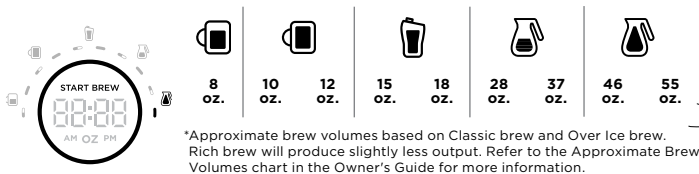

BREWING A CUP

Pull down the cup platform to set a mug on it.

5 START BREW

Press **START BREW** to begin brewing. The progress bar on the display will illuminate to track the status of your brew.

THE BREW MAY PAUSE ONCE OR MULTIPLE TIMES DURING THE BREW CYCLE. THAT'S OK. Pausing allows the coffee grounds to fully extract and unlock the full flavor of the brew style.

NOTE: Ensure the drip stop is open before starting the brew. Refer to page 6 for more information.



BREWING CAPSULES



1 FILL WATER RESERVOIR

Fill the water reservoir to at least the Cup line.

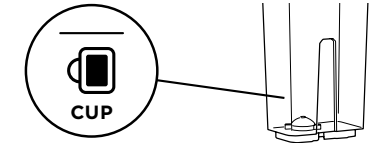

2 PREPARE FOR BREWING

IMPORTANT: This brewer is only compatible with Nespresso Original Capsules.

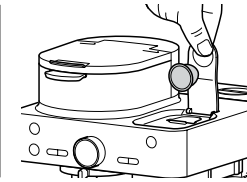

Lift the lever completely and insert the capsule at the correct orientation, as shown.

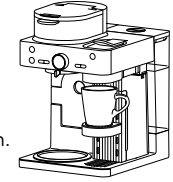

Close the lever and place a cup under the coffee outlet.

ADJUSTABLE CUP TRAY

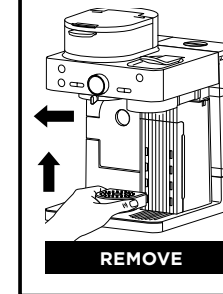

REMOVE

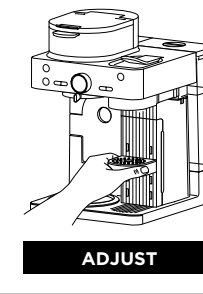

ADJUST

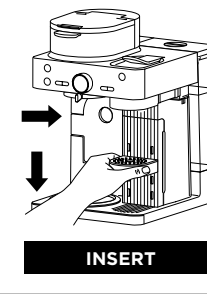

INSERT

3 CHOOSE A STYLE

Press the Capsule Button or turn the dial to select style.



ristretto 25mL
Smaller, more concentrated serving with a sweeter, richer flavor.

lungo 110mL
A larger, less concentrated serving with a sharper flavor.

espresso 40mL
Concentrated, flavorful serving of coffee.

over ice 30mL
Specially designed to brew straight over ice and stand up to milk-based beverages.

NOTE: Always fill your vessel to the top with ice cubes before brewing Over Ice.

4 START BREW

Press **START BREW** to begin brewing. The progress bar on the display will illuminate to track the status of your brew.

PREHEATING: When **START BREW** is pressed, the display may show "PrE" for a period of time as the brewer is preheating. The brew will automatically start once preheating is complete.

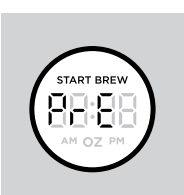

INTELLIGENT WARMING PLATE



The Intelligent Warming Plate will automatically turn on while brewing a Classic or Rich brew on any Carafe size and remain on for 2 hours. To adjust how long the Intelligent Warming Plate remains on (up to 4 hours), refer to the Owner's Guide.

When the Intelligent Warming Plate is on, it can be turned off manually by pressing WARM.

It can be turned on manually by pressing WARM while Grounds Mode, Classic or Rich, and any Carafe size are selected.

IMPORTANT: The  light on the base of the brewer will illuminate only when the warming plate is hot and will remain illuminated until the plate has cooled down.

KEEPING COFFEE HOT

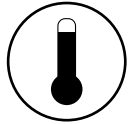

For a hotter cup of coffee, we recommend pre warming the cup with hot water before brewing or pouring into.

DRIP STOP

The drip stop is used to close off the brew basket to prevent any coffee from dispensing. You will need to manually open and close the drip stop by moving the handle to your desired position. The drip stop can be closed and reopened at any point before, during, or after a brew.

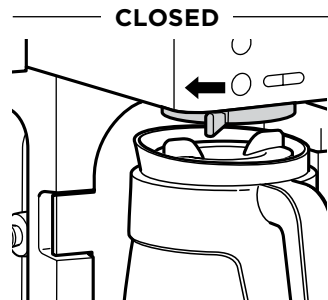
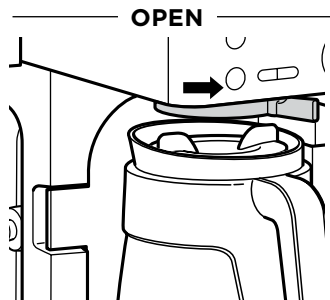

CAN'T WAIT FOR THAT FIRST CUP?

Close the drip stop to pause the brew cycle, and pour yourself a cup. Then, reopen the drip stop to continue the brew.

STOP THE DRIPS AFTER A BREW

At the end of a brew, close the drip stop to prevent coffee dripping from the brew basket.

FROTHING

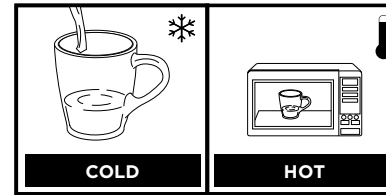

THE INTEGRATED FROTHER DOES NOT HEAT MILK.

1. Add milk to your cup until it is about $\frac{1}{2}$ full.

* For cold froth, continue to Step 2.

 For hot froth, microwave for 45-60 seconds.

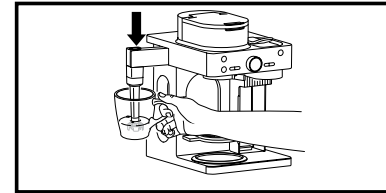

2. Swing the arm of the frother toward the front of the brewer. Install the frother whisk by twisting it to the right.

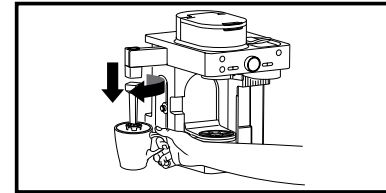

3. Hold the cup under the frother and submerge the whisk just below the surface of the milk. Press and hold the button on top of the frother and froth for 30-45 seconds.

4. Remove the frother whisk by twisting it to the left. Keep your cup below the whisk while you carry it to your sink or dishwasher for easy cleaning.



WARNING: To avoid contact with steam and hot surfaces, **DO NOT** reach across top of brewer to froth.

MAINTENANCE

EMPTYING THE CAPSULE BIN

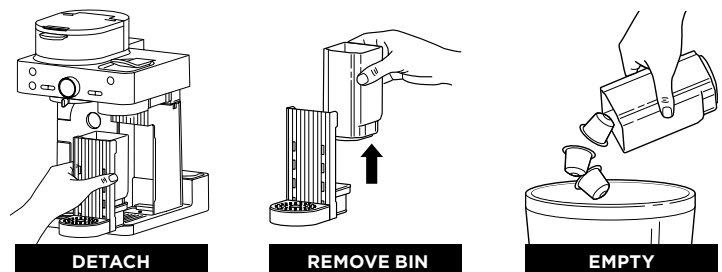

NINJA®

ESPRESSO & COFFEE

BARISTA SYSTEM

For questions or to register your product, contact us at
1-877-646-5288 or visit us online at ninjakitchen.com



@ninjakitchen

CFN602_QSG_MP_MV5

© 2022 SharkNinja Operating LLC

NINJA is a registered trademark of SharkNinja Operating LLC.

NINJA SMART SCOOP is a trademark of SharkNinja Operating LLC.

Nespresso is a registered trademark of Nestle, Inc. Use of the Nespresso trademark does not imply any affiliation with or endorsement by Nestle, Inc.